

**SURVEY
OF
NORTH LINE
SECTION 24, T25S, R3W, W.M.
FOR
WEYERHAEUSER COMPANY**



**COUNTY SURVEYORS FILE DATA
DO NOT REMOVE FROM OFFICE**

FILED *v*
RECEIVED *ry*

JAN 12 1977

COUNTY SURVEYOR
DEGLAS COUNTY, ORE.

LEGEND :

CORNER FOUND ●
LINE BLAZED 
IRON FENCE POST SET 
BEARING - ASSUMED

SCALE: 1" = 800'

DEC. 1976

BY :
TRIANGLE ENGR. CO.
EUGENE, OR 97401

PRECISION
1/17,110

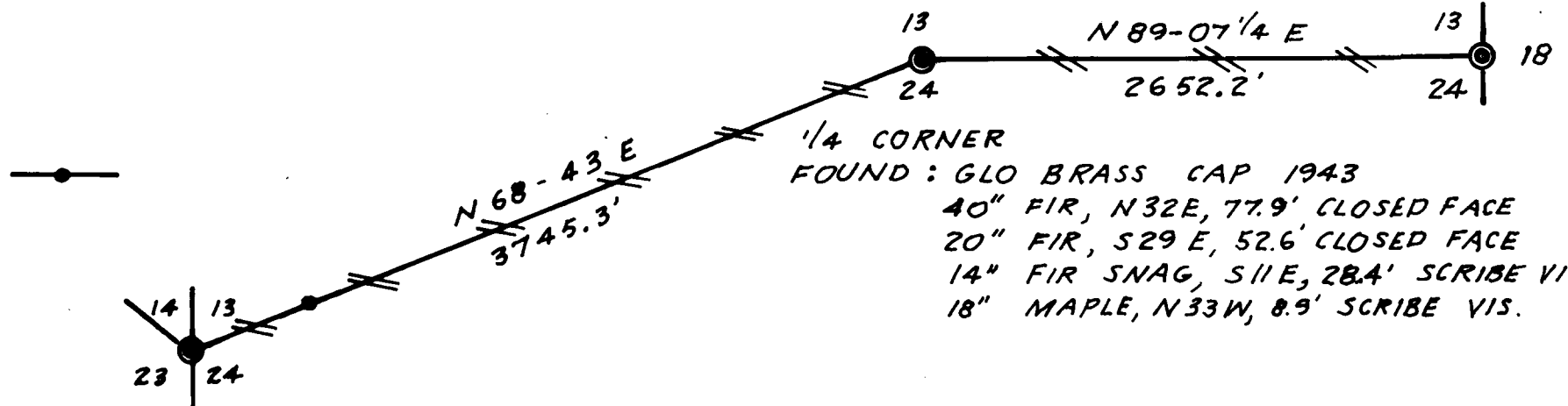

SECTION CORNER
FOUND : GLO BRASS CAP 1943
28" FIR, S57E, 17.8' SCRIBE VIS.
40" FIR, S17 1/2 W, 15.8' CLOSED FC.
12" HEM, N38 1/2 W, 12.5' CLOSED FC.

1/4 CORNER
FOUND : GLO BRASS CAP 1943
40" FIR, N32E, 77.9' CLOSED FACE
20" FIR, S29 E, 52.6' CLOSED FACE
14" FIR SNAG, S11E, 28.4' SCRIBE VIS.
18" MAPLE, N33W, 8.9' SCRIBE VIS.

FOUND : GLO BRASS CAP 1943
32" FIR, S35E, 30.1' W.CO. R.P.
24" FIR, S11 1/2 E, 29.7' CLOSED FACE
20" FIR, N78W, 24.4' SCRIBE VIS.
48" FIR, N38W, 33.0' CLOSED FACE & W.CO. R.P.
48" FIR STUMP, N12 1/2 E, 48.2' CLOSED FACE

