

FILED KQ
RECEIVED *mf*

COUNTY SURVEYOR
DOUGLAS COUNTY, ORE.

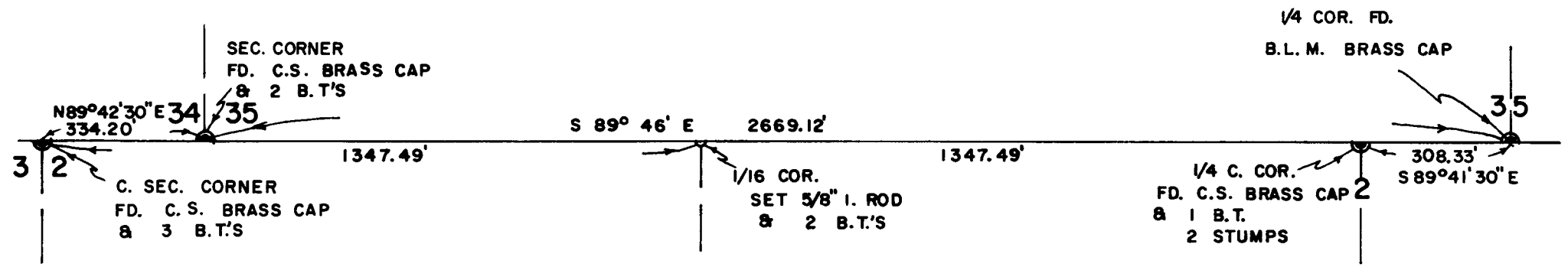

BEARINGS ARE BASED ON SURVEY
BY BEN IRVING - JUNE 1930.

**COUNTY SURVEYORS FILE DATA
DO NOT REMOVE FROM OFFICE**



RICHARD L. TEMPLIN
CONSULTING ENGINEER

PLAT OF SURVEY
WEST 1/2 OF NORTH LINE OF SEC. 2
LOCATED IN
NW 1/4 OF SECTION 2, T. 33 S., R. 5 W., W. M.
DOUGLAS COUNTY, OREGON

Surveyed For: Arant Lbr. Co.,
Scale: 1" = 30'

Grants Pass, Ore.
Feb. 18, 1976.

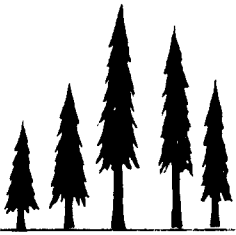

RICHARD L. TEMPLIN
CONSULTING ENGINEER

FILED 04
RECEIVED 04

MAR 11 1976

321 NORTHWEST A STREET
GRANTS PASS, OREGON 97526

COUNTY SURVEYOR
DOUGLAS COUNTY, ORE.

TEL. (503) 476-7114

REGISTERED ENGINEER OREGON
REGISTERED LAND SURVEYOR CALIF.

February 18, 1976

**COUNTY SURVEYORS FILE DATA
DO NOT REMOVE FROM OFFICE**

SURVEY NARRATIVE

Location: West 1/2 of the North Line of Section 2, T. 33 S., R. 5 W.
W. M. Douglas County, Oregon.

Surveyed For: Arant Lbr. Co. 4542 Averill Dr., Grants Pass.

✓ Purpose: To set the W 1/16th corner on the North Line of Sect. 2.

I begin this survey at the 1/4 Sec. cor. for Section 2 only which is
monumented with a County Surveyor brass cap, from which;

- A D. Fir stump 20" in diam. bears South 48.1 feet, scribe visible.
- A D. Fir stump 39" in diam. bears S.58°E., 42.2 feet., healed blaze.
- A Madrone 9" in diam. bears S.69°W., 15.6 feet ., scribe visible.

Thence I survey S. 89°41'30" East ,308.33 feet to the 1/4 Sec. cor. for
Section 35 only, which is monumented with a B. L. M. Brass cap.

Thence I survey North 89°46' West, 2,669.12 feet to the Section corner
common to Sections 34 and 35, which is monumented with a County Surveyor
Brass cap, from which;

- A D. Fir 16" in diam. bears N. 24° E., 17.2 feet, bark scribe visible.
- A D. Fir 12" in diam. bears N. 20° W., 24.0 feet , blaze healed.

Thence I survey S.89°42'30" W., 334.20 feet to the Closing Section Cor.
common to Sections 2 and 3 only which is monumented with a County Surveyor
Brass Cap, from which;

- A D. Fir 28" in diam. bears S.38°W., 21.9 feet dist blaze healed.
(S.28°W., 31.9 Record)
- A I. Cedar 23" in diam. bears S.20°E., 49.0 feet , blaze healed.

I then return at proportionate dist from the Closing corner of 2 and 3 to
the 1/4 cor common to Section 2, only in line with the 1/4 cor common to
Section 35 only and the Section corner common to Sections 34 and 35 or on
the Township boundary, at this point I set a 5/8th inch diameter iron rod
to monument the W 1/16th corner on the North line of Section 2, from which;

- A D. Fir 21" in diam. bears S.46°W., 42.5 feet Mkd. W1/16 RE3024 BT.
- A S. Pine 24" in diam. bears S.4° E., 23.8 feet dist. Mkd. W1/16 RE3024 BT.

This survey was executed with a T16ED Transite Theodolite and a Micro
Ranger electronic measuring instrument.
All bearings are based upon Survey by Ben Irving 1930 of this same line.

