

FILED
RECEIVED

APR 14 1977

COUNTY SURVEYOR
DOUGLAS COUNTY, ORE.

ARRANT LBR. CO.

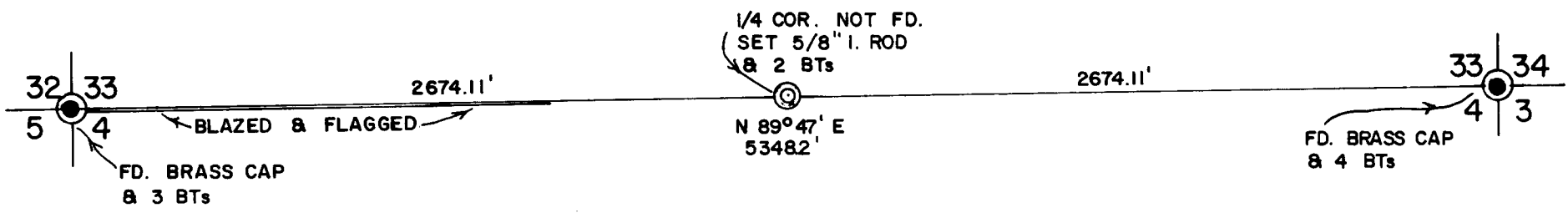

**COUNTY SURVEYORS FILE DATA
DO NOT REMOVE FROM OFFICE**

NOTE:
ALL BEARINGS ARE REFERRED TO THE TRUE MERIDIAN
BASED UPON SOLAR OBSERVATIONS TAKEN AT THE
BEGINNING AND ENDING OF THE LINE.

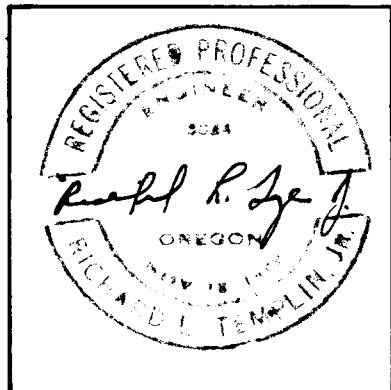

RICHARD L. TEMPLIN
CONSULTING ENGINEER

DEPENDENT RESURVEY
SOUTH LINE OF SECTION 33
LOCATED IN
T. 31 S., R. 5 W., W.M.
DOUGLAS COUNTY, OREGON

SURVEYED FOR: ARRANT LBR. CO. GRANTS PASS, OREGON
SCALE: 1" = 600' APRIL 8, 1977



RICHARD L. TEMPLIN
CONSULTING ENGINEER

FILED
RECEIVED *rk*

APR 14 1977

321 NORTHWEST A STREET
GRANTS PASS, OREGON 97526

COUNTY SURVEYOR
DOUGLAS COUNTY, ORE

REGISTERED ENGINEER OREGON
REGISTERED LAND SURVEYOR CALIF.

April 8, 1977

TEL. (503) 476-7114

SURVEY NARRATIVE

*N. line of S. 4
T32-5 ✓*

Location: South line of Section 33, T. 31 S., R. 5 W., W.M. Douglas Co.

Purpose : To blaze and mark true line through standing timber located along the westerly 1500 feet of the south line of Section 33 for future logging purposes.

Surveyed for: Arant Lumber Co., 4542 Averill Drive, Grants Pass, Oregon 97526

Commencing at the Section corner common to Sections 32 and 33, T. 31 S., R. 5 W., and the Sections 5 and 4, T. 32 S., R. 5 W. which is monumented with A Douglas County Surveyor's brass cap cemented at the base of a small rock outcrop from which:

A Douglas Fir, 14 ins. in diam bears N. 11° E., 41.9 ft. dist. scribing visisble.

A Douglas Fir, 10 ins. in diam. bears S. 66° W., 45.3 ft. dist. blaze healed.

A Douglas Fir, 22 ins. in diam. bears N. 74° W., 45.4 ft. diat., scribing visible.

Thence N. 89°47' E. on true line between sections 33 and 4 for 2674.11 ft. to a point for the 1/4 corner common to Sections 33 and 4 as determined by single proporyionate distance at which point I set a 5/8 inch diameter iron rod, 30 ins. in length, 25 inches in the ground with a yellow plastic cap mkd. " TEMPLIN RE 3024" from which:

A Ponderosa Pine, 2 ins. in diam., bears N. 03° E. , 14.5 ft. dist., mkd. " 1/4 X"

A Chinquapin, 10 ins. in diam., bears N. 68° E., 60.1 ft. mkd. "1/4 S33 RE3024 BT".

(This corner falls on the south edge of an old skid road in the middle of a large clear cut logging unit. No evidence of original corner found)

Thence continue N. 89°47' E. on true line for 2674.11 ft. to the Section Corner common to Sections 33 and 34, T. 31 S., R. 5 W., and 4 and 3, T. 32 S., R. 5 W., which is monumented with a BLM brass cap from which:

A Douglas Fir, 34 ins. in diam, bears S. 68° E., 38.3 ft. dist. blaze healed.

A Douglas Fir, 36 ins. in diam. bears N. 66° W., 48.2 ft. dist. blaze healed.

A Douglas Fir 22 ins. in diam, bears S. 77° W., 46.6 ft dist., scribing visible.

Other BT's, dead and down.

DO NOT REMOVE FROM OFFICE
COUNTY SURVEYORS FILE DATA

*T31-5
#109
#198
T32-5*

C. S. File No. 50/93-1b

(Survey Sec. 33, T. 31 S., R. 5 W. W.M. con't.)

The westerly 1500 feet of the line was blazed and marked with blue plastic flagging for logging purposes. This line runs along steep and precipitous rock outcrops.

Survey executed with a Wild T-16ED theodolite and a Geodimeter 12 electronic distance measurement instrument. All bearings are referred to the true meridian based upon solar observations taken at the beginning and the ending of the line.

**COUNTY SURVEYORS FILE DATA
DO NOT REMOVE FROM OFFICE**



FILED
RECEIVED *zR*

APR 14 1977

COUNTY SURVEYOR
DOUGLAS COUNTY, ORE