

**COUNTY SURVEYORS FILE DATA
DO NOT REMOVE FROM OFFICE**

78/82

FILED ^{KC}
RECEIVED *mg*

JAN 8 1976

CORNER RESTORATION
W 1/4 SEC. 18, T. 28 S., R. 8 W.
E 1/4 SEC. 13, T. 28 S., R. 9 W.

COUNTY SURVEYOR
DOUGLAS COUNTY, ORE.

WEYERHAEUSER CO. ENGRS
ROSEBURG DISTRICT
S.W. OREGON REGION
DEC. 22, 1975

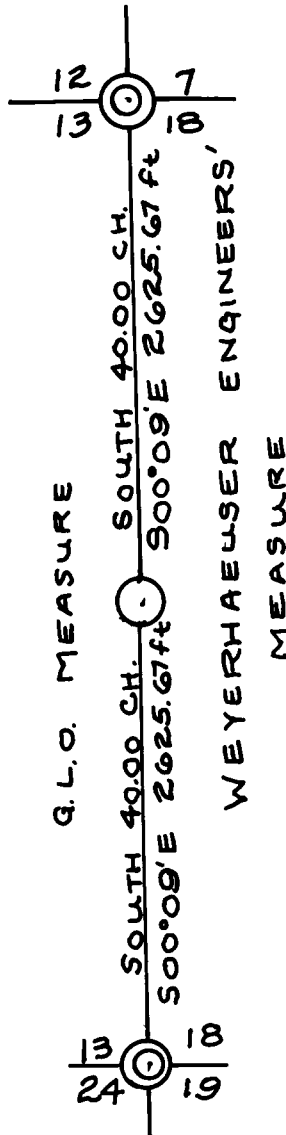

SCALE: 1"=1000'

○ CORNERS SET

⊙ CORNERS FOUND

REGISTERED
PROFESSIONAL
LAND SURVEYOR

Michael & McDowell

1975
Michael & McDowell
1000

DRN: 12-22-75 MSM

O.K.: *HR* - 12-26-75

CS 58/81 A

18/85

WEYERHAEUSER COMPANY

PROPERTY LINE SURVEY
Section 18, T. 28 S., R. 8 W., and
Section 13, T. 28 S., R. 9 W., W.M.

Douglas and Coos Counties, Oregon

December 22, 1975

FILED
RECEIVED *mg*

JAN 8 1976

COUNTY SURVEYOR
DOUGLAS COUNTY, ORE.

General Information:

A K&E transit and 300-foot steel tape were used to conduct a survey along the West line of said Section 18 to determine Company property lines. The survey was initiated at the SW corner of the Section. The W $\frac{1}{4}$ corner was searched for, but no definite evidence could be found, and it was re-established.

Bearings are based on solar observation, and the traverse was closed with an accuracy exceeding 1/5000.

Corner Research:

The following corners and accessories were either found or set during the course of the survey:

The corner for Sections 18 and 19, T. 28 S., R. 8 W., and Sections 13 and 24, T. 28 S., R. 9 W., W.M.

found: a 1 $\frac{1}{2}$ " iron pipe, set by Safstrom in 1961, and a 2 $\frac{1}{2}$ " iron post with brass cap set by cadastral surveyors in 1972, from which:

- a 45" fir, bark scribed, bears S60 $^{\circ}$ E 36 links
- a 5" yew, bears N71 $\frac{1}{2}$ $^{\circ}$ E 19 links
- an 18" hemlock, bears S21 $^{\circ}$ W 24 links
- a 10" hemlock, bears N69 $^{\circ}$ W 23 links.

The corner for Sections 7 and 18, T. 28 S., R. 8 W., and Sections 12 and 13, T. 28 S., R. 9 W., W.M.

found: a 2" iron pipe with brass cap, set by Douglas County, 4" below the surface of the County road, from which:

- a 72" fir stump, bark scribed by Frear in 1953, bears S83 $^{\circ}$ E 36 links
- a 72" fir stump, bark scribed by Frear in 1953, bears S32 $^{\circ}$ W 70 links
- a 60" fir stump, bark scribed by Byron in 1956, bears N66 $^{\circ}$ E 136 links
- a 72" fir stump, bark scribed by Byron in 1956, bears N57 $^{\circ}$ W 127 links.

The $\frac{1}{4}$ -corner common to Section 18, T. 28 S., R. 8 W., and Section 13, T. 28 S., R. 9 W., W.M.:

set: a 2" iron pipe with brass cap from which:

- a scribed 6" yew, bears N44 $\frac{1}{2}$ $^{\circ}$ W 15.4 feet
- a scribed 24" hemlock, bears N55 $^{\circ}$ E 27.4 feet.

**COUNTY SURVEYORS FILE DATA
DO NOT REMOVE FROM OFFICE**

Respectfully submitted,

Michael S. McDowell
L.S. 1032

Approved:
WEYERHAEUSER COMPANY
Southwest Oregon Region

H. R. Reppeto
H. R. Reppeto
Region Engineer

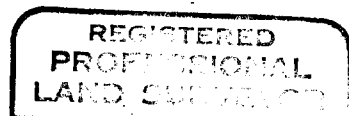

Michael S. McDowell

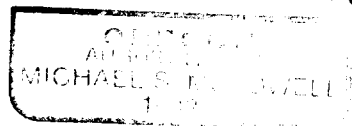

C. S. File No. 58/016