

CERTIFIED RECORD OF LAND CORNER MONUMENTATION

History of original corner establishment:

August 19, 1857
 ORIGINAL CORNER set post to Corner of Section
 15/16/21/22 from which
 A Fir 18 inch diameter bears S10°E 68 lks.
 A Laurel 18 inch diameter bears S27°W 58 lks.
 A Laurel 10 inch diameter bears N45°E 40 lks.
 A Cedar 24 inch diameter bears N43°W 31 lks.

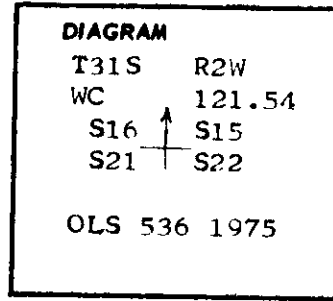

Description of corner evidence found:

I find a 1 inch galvanized iron pipe with brass cap stamped :
 7 inch cedar bears N2°W 12.0 feet scribed
 T31S R2W S16 CS BT
 8 inch Cedar bears N47°W 15.5 feet scribed
 T31S R2W S16 CS BT
 6 inch Cedar bears S21°W 15.2 feet scribed
 T31S R2W visible
 12 inch Cedar bears S44°W 33.1 feet at @ 18°30', scribed
 T31S R2W S21 Cs BT
 CORNER lies in recent slide: I leave the County Brass Cap out of position:
 I reestablish corner position by County Surveyors bearing trees, using the
 6 inch and 12 inch Cedars, which lie outside slide area; I then set Witness
 Corner on the South line between Sections 21/22 outside of active slide area.

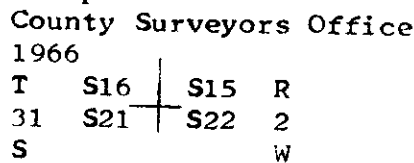

Description of monument and accessories I established to perpetuate the original location of this corner

I set a 30 inch long, 2 1/2 inch diameter galvanized iron pipe 26 inches in the ground, in a mound of stones, with a 3 inch brass cap stamped:

BEARING TREES:

A Cedar 10 inch diameter bears S79°E. 32.6 feet scribed WC T31S R2W S21 (BT) with brass washer stamped LS 536 nailed at BT. Blaze

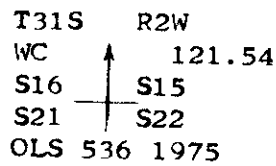

A Cedar 8 inch diameter bears S32°W 29.3 feet Scribed W.C. T31S R2W S22 (BT) with brass washer stamped Ls 536 nailed at BT. Blaze.

NOTE: Both trees have a 6 inch red band painted around tree.

CORNER lies 121 feet South of draw and slide area.

From Book # 2 , page # 31 , Tiller land Survey #14, Contract #004610N.

Office of Surveyors County of Douglas
 State of Oregon , I hereby certify that the within instrument was filed in this office
 for record on the 17 day of February

Virginia A. Yates by Virginia A. Yates
 (COUNTY OFFICIAL) (DEPUTY)

**REGISTERED
 PROFESSIONAL
 LAND SURVEYOR**

[Signature]
 OREGON
 C. T. WILSON
 536