

PUBLIC LAND CORNERS

FILED
RECEIVED

DEC 22 1980

WEYERHAEUSER COMPANY
SPRINGFIELD BRANCH

COUNTY SURVEYOR
DOUGLAS COUNTY, ORE.

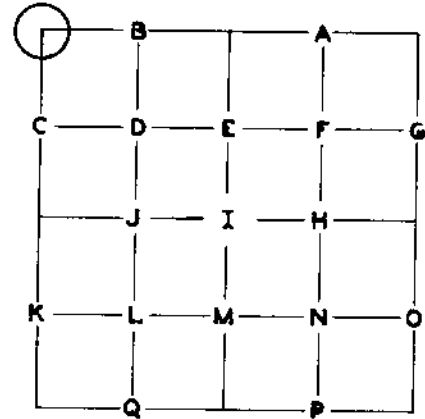

TOWNSHIP 24S RANGE 2W
SECTION 20 CORNER NW
COUNTY Douglas OREGON

GLO SURVEY RECORD				PRESENT CONDITION - (DESCRIBE FULLY - USE PAGE 2 IF NEEDED FOR EXPLANATION.)
CORNER <u>Yew post</u> DATE: <u>1883</u>				No trace.
ACCESSORIES:				
(1) 12" Fir	BEARING- N50E	LINKS- 17	FEET- 11.2	30" Fir, healed over faces.
(2) 10" Fir	S40E	35	23.1	18" Fir, healed over faces.
(3) 18" Fir	S35W	55	36.3	26" down fir, rotted. Axe work and one scribe mark.
(4) 36" Fir	N05W	15	9.9	38" fir stump, rotted but evidence of old face.
SURVEY RECORD				PRESENT CONDITION:
DATE: _____				

CORNER SET: 1" x 30" monel pipe set by GLO MAG. DECL.: 20°E

record distances and new bearings recorded as below.

BEARING AND DISTANCE TO ABOVE IDENTIFIED SURVEY ACCESSORIES:

BEARING-	FEET-	SURVEY-	DESCRIPTION
(1) N60E	11.2	1883	Face measurement (Record: N50E).
(2) S05E	23.1	1883	Face measurement (Record: S40E).
(3) S56W	36.3	1883	to root hole (Record: S35W).
(4) N03W	9.9	1883	Face measurement (Record: N05W).

SECTION 20 TOWNSHIP 24S RANGE 2W

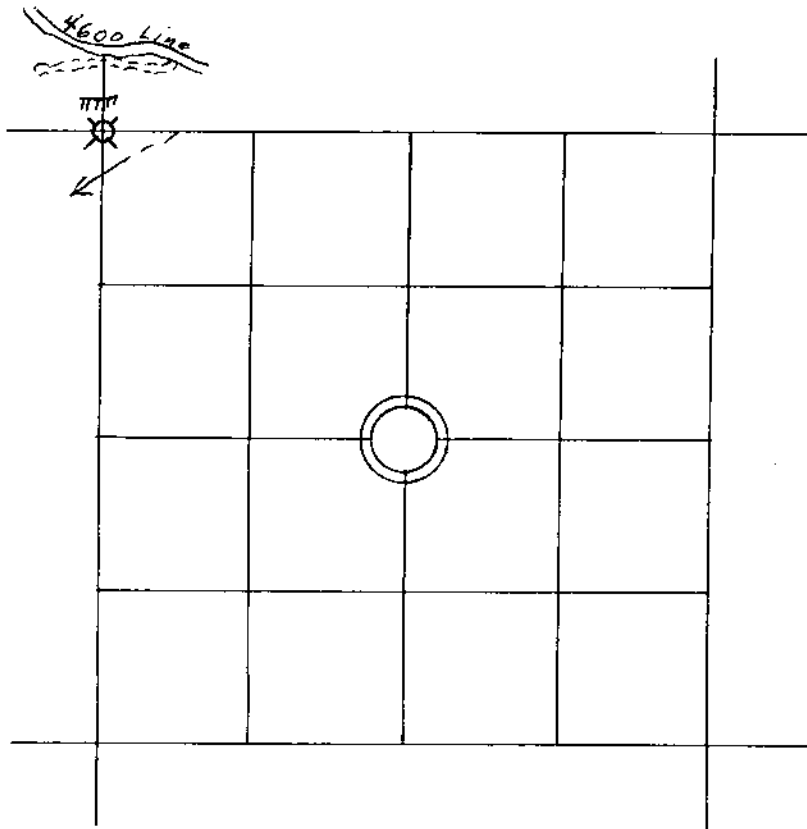

— // // // — LINE MARKED BY NOTCH CUT IN BLAZE.

○... KNOWN CORNER.

⊗... REFERENCED CORNER
BY WEYERHAEUSER
METHOD.

Also found: Douglas County appraisal plate on 20" red cedar
SOGW 26.8' to plate; signed by "Lecklider", "Givens."

Also found Weyerhaeuser cruisers' cruiser marks: "
"LF", "Z" and ace of spades.

ACCESSORIES ADDED THIS DATE:

1/21/80

MAGNETIC DECLINATION

20°E

	BEARING	FEET	ORIG. B.T.	"W" NAIL	PLATE	BRASS DISC
30" Fir	N59E	10.5	1883	X	X	---
38" Fir	S86E	29.8	----	X	X	---
18" Fir	S06E	23.0	1883	X	X	---
12" Yew	N80W	18.6	----	X	X	---

IDENTIFIED ON PHOTO:

INFORMATION ON LOCATION OF CORNER AS NOW SET:

GROUND COVER: to be logged soon

(USING FORM LINES SKETCH TOPOG AT CORNER ON PAGE 2 PLAT)

SLOPE FACES (GIVE BEARING IN DEGREES) South ON MINUS (-) 43 %

NORTH: +55% 20' to low (8') rock ledge.

SOUTH: -43% 30' then steepens; approx. 130' to creek course S35W.

EAST: + 20%

WEST: - 8%

WORK DONE FOR W. CO.

FIELD NOTES IN BOOK:

BY: Glen McChesney Project ENGINEER - SURVEYOR

DATE: 1/21/80

ASSISTED BY:

COPIES SENT TO:

FILED RECEIVED DEC 22 1980 COUNTY SURVEYOR DOUGLAS COUNTY, ORE

UNDER THE SUPERVISION OF:

F. O. Williams

REGISTERED PROFESSIONAL LAND SURVEYOR

Frank O. Williams

OREGON JULY 12, 1969 FRANK O. WILLIAMS 0875

SEAL

PAGE 3

C. S. File No.

58/B

36	31	32	33	34	35	36	31
1	6	5	4	3	2	1	6
12	7	8	9	10	11	12	7
13	18	17	16	15	14	13	18
24	19	20	21	22	23	24	19
25	30	29	28	27	26	25	30
36	31	32	33	34	35	36	31
1	6	5	4	3	2	1	6

WEYERHAEUSER COMPANY

CORNER REFERENCE METHOD CONSISTS OF:

A "W" NAIL DRIVEN THRU THE HOLE IN A BRASS DISC, INTO A NOTCH CUT LOW ON A TREE, STAMPED WITH THE OREGON REGISTERED LAND SURVEYOR OR PROFESSIONAL ENGINEER REGISTRATION NUMBER.

AN EMBOSSED ALUMINUM PLATE, NAILED HEAD HIGH ON SAME TREE WITH 8D ALUMINUM NAILS, WITH DISTANCE AND BEARING FROM THE "W" NAIL TO THE CORNER STAMPED ON IT.

