

PUBLIC LAND FILED CORNERS

RECEIVED

JUN 3 1981

WEYERHAEUSER COMPANY
SPRINGFIELD BRANCH

COUNTY SURVEYOR
DOUGLAS COUNTY, ORE.

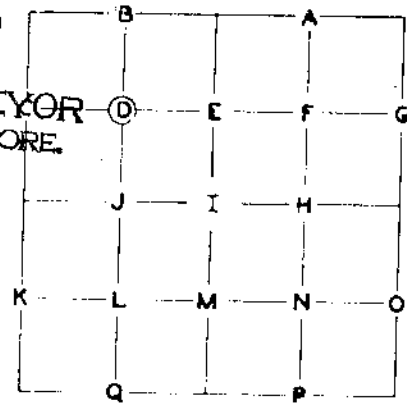

TOWNSHIP 23S RANGE 4W
SECTION 12 CORNER NW 1/16 "D"
COUNTY Douglas OREGON

GLO SURVEY RECORD

DATE: _____
CORNER Not set by GLO

ACCESSORIES:

BEARING-	LINKS-	FEET-

PRESENT CONDITION - (DESCRIBE FULLY -
USE PAGE 2 IF NEEDED FOR EXPLANATION.)

W. N. Haines SURVEY RECORD
DATE: Nov. 1963
Transit survey
Set 1" x 36" "T" Iron and scribed:
30" Incense Cedar N59°E 24.2'
(N80°E true)
12" Douglas-fir S10°E 33.8'
(S11°W true)

PRESENT CONDITION:

32" Incense Cedar - scribing visible
12" Douglas-fir - face partly healed over

CORNER SET: "T" iron as set by Haines Survey MAG. DECL.: 20°

BEARING AND DISTANCE TO ABOVE IDENTIFIED SURVEY ACCESSORIES:

BEARING-	FEET-	SURVEY-
<u>N59°E</u>	<u>22.7</u>	<u>Haines '63 to scribed face</u>
<u>S11°E</u>	<u>33.8</u>	<u>Haines '63 to scribed face</u>

SECTION 12 TOWNSHIP 23S RANGE 4W

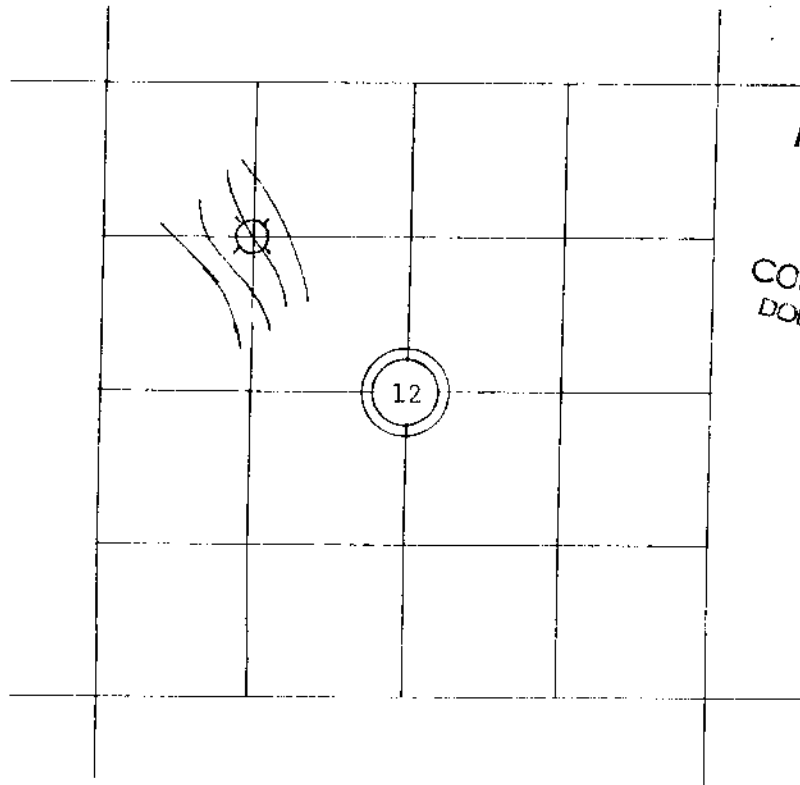

FILED
RECEIVED
JUN 3 1981
COUNTY SURVEYOR
DOUGLAS COUNTY, ORE.

---//---//---//--- LINE MARKED BY NOTCH CUT IN BLAZE.

○ KNOWN CORNER.

⊗ REFERENCED CORNER
BY WEYERHAEUSER
METHOD.

Note: 21° local magnetic attraction at vicinity of this corner.

ACCESSORIES ADDED THIS DATE:

MAGNETIC DECLINATION 20°

	BEARING	FEET	ORIG. B.T.	'W' NAIL	PLATE	BRASS DISC
12" Douglas-fir	S11°E	22.6	Haines 1963	X	X	
32" Incense Cedar	N59°E	33.3	Haines 1963	X	X	

FILED
RECEIVED

IDENTIFIED ON PHOTO:

INFORMATION ON LOCATION OF CORNER AS NOW SET

JUN 3 1981
COUNTY SURVEYOR
DOUGLAS COUNTY, ORE.

GROUND COVER: fern, brush

(USING FORM LINES SKETCH TOPOG AT CORNER ON PAGE 2 PLAT)

SLOPE FACES (GIVE BEARING IN DEGREES) S55°W ON MINUS (-) 12 %

FROM CORNER -

NORTH: + 5

SOUTH: + 6

EAST: + 25

WEST: - 12

WORK DONE FOR W. CO. _____

FIELD NOTES IN BOOK: _____

BY: Glen McChesney DATE: 8/9/66

~~ENGINEER & SURVEYOR~~

ASSISTED BY: _____

COPIES SENT TO: _____

UNDER THE SUPERVISION OF:

SEAL
PAGE 3
C. S. File No. 58/B

36	31	32	33	34	35	36	31
1	6	5	4	3	2	1	6
12	7	8	9	10	11	12	7
13	18	17	16	15	14	13	18
24	19	20	21	22	23	24	19
25	30	29	28	27	26	25	30
36	31	32	33	34	35	36	31
1	6	5	4	3	2	1	6

WEYERHAEUSER COMPANY

CORNER REFERENCE METHOD CONSISTS OF:

A "W" NAIL DRIVEN THRU THE HOLE IN A BRASS DISC, INTO A NOTCH CUT LOW ON A TREE, STAMPED WITH THE OREGON REGISTERED LAND SURVEYOR OR PROFESSIONAL ENGINEER REGISTRATION NUMBER.

AN EMBOSSED ALUMINUM PLATE, NAILED HEAD HIGH ON SAME TREE WITH 8D ALUMINUM NAILS, WITH DISTANCE AND BEARING FROM THE "W" NAIL TO THE CORNER STAMPED ON IT.

