

PUBLIC LAND CORNERS

RECEIVED *JL*

DEC 22 1980

WEYERHAEUSER COMPANY
 COUNTY SURVEYOR
 SPRINGFIELD BRANCH DOUGLAS COUNTY, ORE.

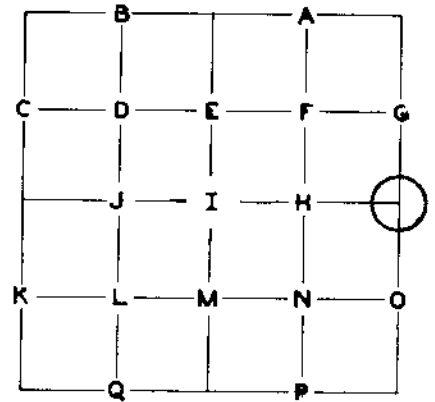

TOWNSHIP 23S RANGE 2W

SECTION 36 CORNER E $\frac{1}{4}$

COUNTY Douglas OREGON

GLO SURVEY RECORD				PRESENT CONDITION - (DESCRIBE FULLY - USE PAGE 2 IF NEEDED FOR EXPLANATION.)
DATE: 1964				
CORNER <u>brass cap</u>				Found
ACCESSORIES:				
36" Fir	BEARING- S44 $\frac{1}{2}$ E	LINKS- 31	FEET- 20.5	Down, windthrown 36" Fir slid down hill; plate intact, face partly healed. 32" Fir; low face healed over; BLM BT plate intact.
32" Fir	S53E	78	51.5	
SURVEY RECORD				PRESENT CONDITION:
DATE:				

CORNER ~~XXXX~~ Brass Cap MAG. DECL.: 20⁰

BEARING AND DISTANCE TO ABOVE IDENTIFIED SURVEY ACCESSORIES:

BEARING-	FEET-	SURVEY-	
S44E	20.5	1964	To center of root hole.
S55W	51.7	1964	Center of tree measurement.

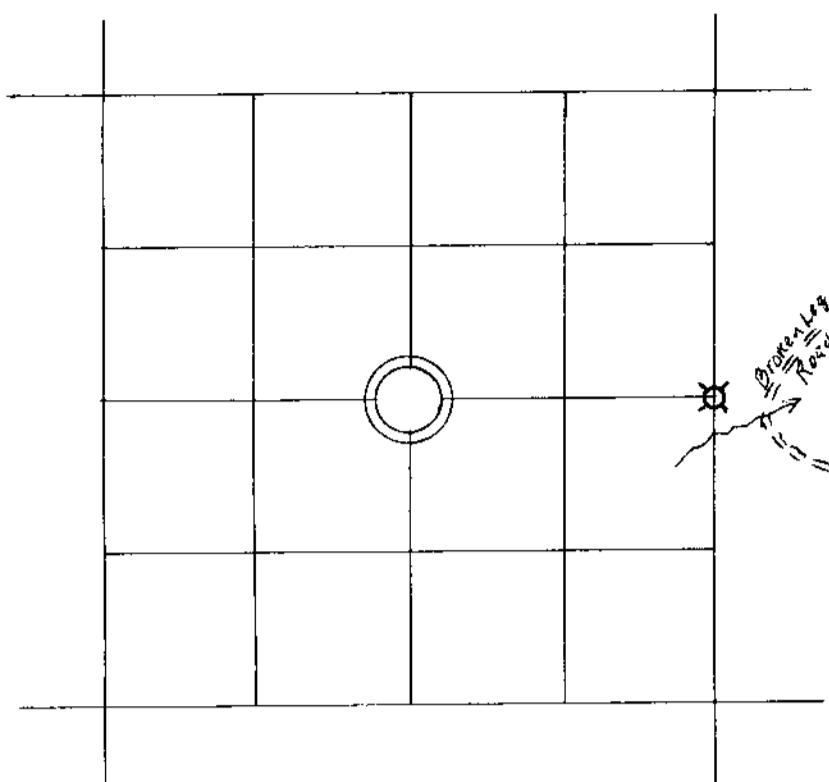

--- LINE MARKED BY NOTCH CUT IN BLAZE.

○ KNOWN CORNER.

⊗ REFERENCED CORNER BY WEYERHAEUSER METHOD.

ACCESSORIES ADDED THIS DATE:

MAGNETIC DECLINATION 20°

	BEARING	FEET	ORIG. B.T.	"W" NAIL	PLATE	BRAS. DISC.
40" Fir	N69E	8.3	---	X	X	--
18" Hemlock	S61W	3.8	---	X	X	--
32" Red Cedar Stump	N78W	50.8	---	X	X	--

IDENTIFIED ON PHOTO:

INFORMATION ON LOCATION OF CORNER AS NOW SET:

GROUND COVER: Logging slash

(USING FORM LINES SKETCH TOPOG AT CORNER ON PAGE 2 PLAT)

SLOPE FACES (GIVE BEARING IN DEGREES) S65E ON MINUS (-) 68 %

NORTH: + 15% logged to West, timber to East.

SOUTH: - 15% logged to West, timber to East; approx. 180' to spring branch, course NE.

EAST: - 60% approx. 270' to rock logging road.

WEST: + 60% through logged area.

WORK DONE FOR W. CO. _____

FIELD NOTES IN BOOK: _____

BY: Glen McChesney DATE: 3/10/1978
Project ENGINEER - SURVEYOR

ASSISTED BY: _____

FILED
RECEIVED *[Signature]*
DEC 22 1980

COPIES SENT TO: COUNTY SURVEYOR
DOUGLAS COUNTY, ORE

UNDER THE SUPERVISION OF:

REGISTERED PROFESSIONAL LAND SURVEYOR

Frank O. Williams

OREGON
JULY 12, 1968
FRANK O. WILLIAMS
0875

T23-2 #36 ✓
T23-1 #1A ✓

36	31	32	33	34	35	36	31
1	6	5	4	3	2	1	6
12	7	8	9	10	11	12	7
13	18	17	16	15	14	13	18
24	19	20	21	22	23	24	19
25	30	29	28	27	26	25	30
36	31	32	33	34	35	36	31
1	6	5	4	3	2	1	6

WEYERHAEUSER COMPANY

CORNER REFERENCE METHOD CONSISTS OF:

A "W" NAIL DRIVEN THRU THE HOLE IN A BRASS DISC, INTO A NOTCH CUT LOW ON A TREE, STAMPED WITH THE OREGON REGISTERED LAND SURVEYOR OR PROFESSIONAL ENGINEER REGISTRATION NUMBER.

AN EMBOSSED ALUMINUM PLATE, NAILED HEAD HIGH ON SAME TREE WITH 8D ALUMINUM NAILS, WITH DISTANCE AND BEARING FROM THE "W" NAIL TO THE CORNER STAMPED ON IT.

