

T 32 S R 3 W

COR. NO. 8

H E S 186

FOUND: 30" FIR STUMP WITH
VISIBLE SCRIBE "BT" ON NE
FACE BEARS S 13° W 15.2'
ROTTED STUMP WITH NO VISIBLE
SCRIBE BEARS N 72° E 30.4'
NO SIGN OF ORIGINAL STONE

NEW: SET BRASS CAP ON 1 1/2"

IP STAMPED

DOUGLAS CO. SURVEYOR

T 32 S R 3 W

COR. 8

H E S 186

1975

FROM WHICH:

A 8" PINE SCRIBED "T 32 S
R 3 W 8 H E S 186 C 5 B 7"

#167 ✓
U. S. File No. 57/30-8 C

IN A DOUBLE BLAZE BEARS

S 89 1/2 E 19.1'

A 10" PINE SCRIBED "T32S

R3W 8 HES 186 CSBT"

IN A DOUBLE BLAZE BEARS

S 28 W 15.4'

COMPASS DECLINATION 20°

6-12-75

C. L. Goodwin

VIC CRANGIE

LENORA LADIG

OK
JLL

T 325 R3W
COR NO. 11
HES 186

FOUND: 26" FIR STUMP WITH
VISIBLE SCRIBE " X 11 HES 186
BT " ON THE NE FACE BEARS
N. 12° W 23.8'
NO SIGN OF THE ORIGINAL STONE

SET: BRASS CAP ON 1 1/2" IP
STAMPED

DOUGLAS CO. SURVEYOR
T 325 R3W
COR 11
HES 186
1975

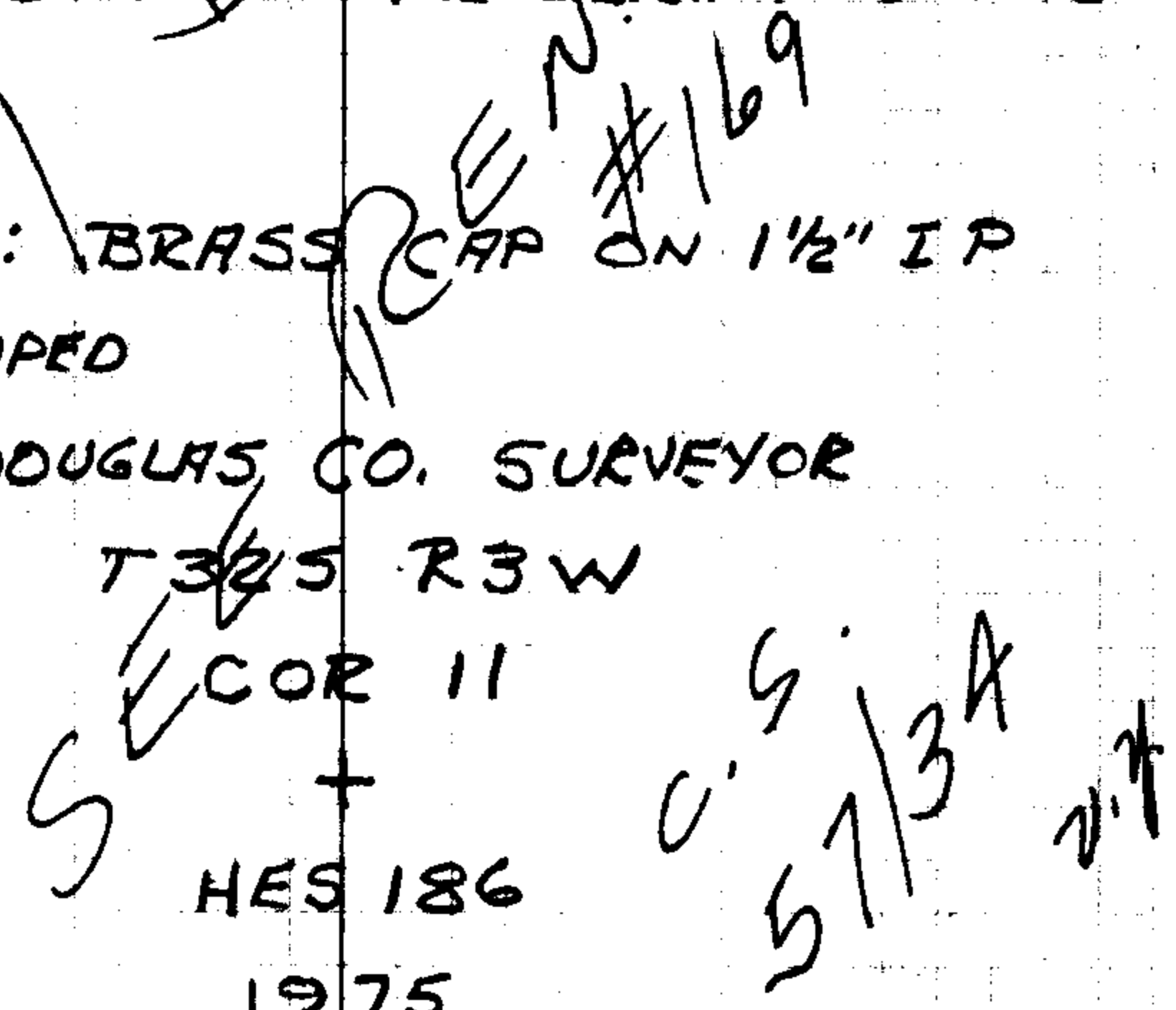
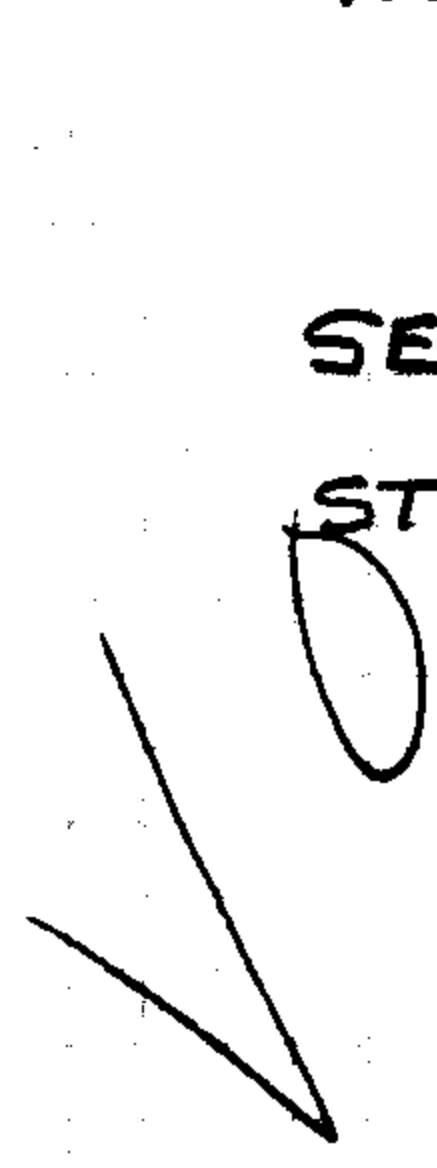

FROM WHICH:
A 8" PINE SCRIBED "T 325 R3W
11 HES 186 CSBT" IN DOUBLE

#168

C. S. File No. 37/30-8 C

BLAZE BEARS S84°E 30.2'

A 8" FIR SCRIBED "T32S R3W
|| HES 186 CSBT" IN A DOUBLE
BLAZE BEARS N30°W 45.8'

A BRASS CAP ON 1½" IP
STAMPED "DOUGLAS CO. SURVEYOR
T32S R3W COR 8 HES 186
1975" BEARS N88°E 35.0'

COMPASS DECLINATION 20°

6-12-75

Chas Goodwin
VIC CANGIE
LENOEA LADIG

OK
JHL

SEE #169
REN

U.S.
59/3A