

12-30-74

7 + 8

T263 R6W

$\frac{1}{4}$

SEE REN'S # 21, 44, & 135

THIS CORNER RESET FROM REFERENCE MONUMENTS AS SHOWN ON THE ATTACHED NOTES DATED 4-5-73. AT THIS TIME, WE FIND NO EVIDENCE OF THE ORIGINAL CORNER, OR THE WITNESS CORNER, OR THEIR ACCESSORIES.

AT THE TRUE POINT FOR THE $\frac{1}{4}$ CORNER, APPROX 2 5 FT. WESTERLY OF THE CENTER-LINE OF COUNTY ROAD # 6, WE DRIVE A BRIDGE SPIKE, FLUSH WITH THE ASPHALT PAVEMENT FROM WHICH WE MARK THE FOLLOWING BEARING TREE AND NOTE THE FOLLOWING BEARING OBJECTS;

A 15" WHITE OAK BEARS S $69\frac{1}{2}^{\circ}$ E
80 ⁷ FT., SCRIBED " $\frac{1}{4}$ S B CS BT"

CRRW N23½°E

POC 264+50 50 FT. LEFT

T. Rod E. Azum Cap. ~~STAMPED~~

"DOUGLAS Co RD. DPT

R-W 50

128⁹⁶ @ 7° 199255 128⁰⁰

WESTERLY FENCE OF Co. Rd. 6

15" W. OAK S 69½° E

81³ @ 7° 19925 80Z

"¼ 5 @ CS BT"

~~Correct~~ 2⁵ WESTERLY OF L

S 55° W 161.17 LVL

ENGINEER'S
STATION 261+71.71

CRRW 35

DOUGLAS Co. Rd. DPT, R-W 35 LEFT

WESTERLY RW FENCE

AN IRON ROD WITH ALUMINUM CAP ATTACHED;
 MARKED "DOUGLAS CO. RD. DPT. R-W
 35" AT ENGINEERS STATION 261+71.71
 35 FT. LEFT OF CENTERLINE AT THE WESTERLY
 R/W FENCE OF CO. RD. #6 BEARS S 55° W
 161.17 FT.

AN IRON ROD WITH ALUMINUM CAP ATTACHED;
 MARKED "DOUGLAS CO. RD. DPT. R-W
 50" AT ENGINEERS STATION P.O.C. 264+50
 50 FT. LEFT OF THE CENTERLINE OF
 CO. RD. #6 ^{AND} AT THE WESTERLY R/W
 FENCE BEARS N 23 1/2° E 128.00 FT.

COMPASS DECLINATION SETTING: 20° EAST

12-30-74

Burg L. Langley

PETER L. EARLE

OK

Cor Referenced for Bd Work

$\frac{1}{4}$ cor 7/8 T 26S B6W

REN. No. 135

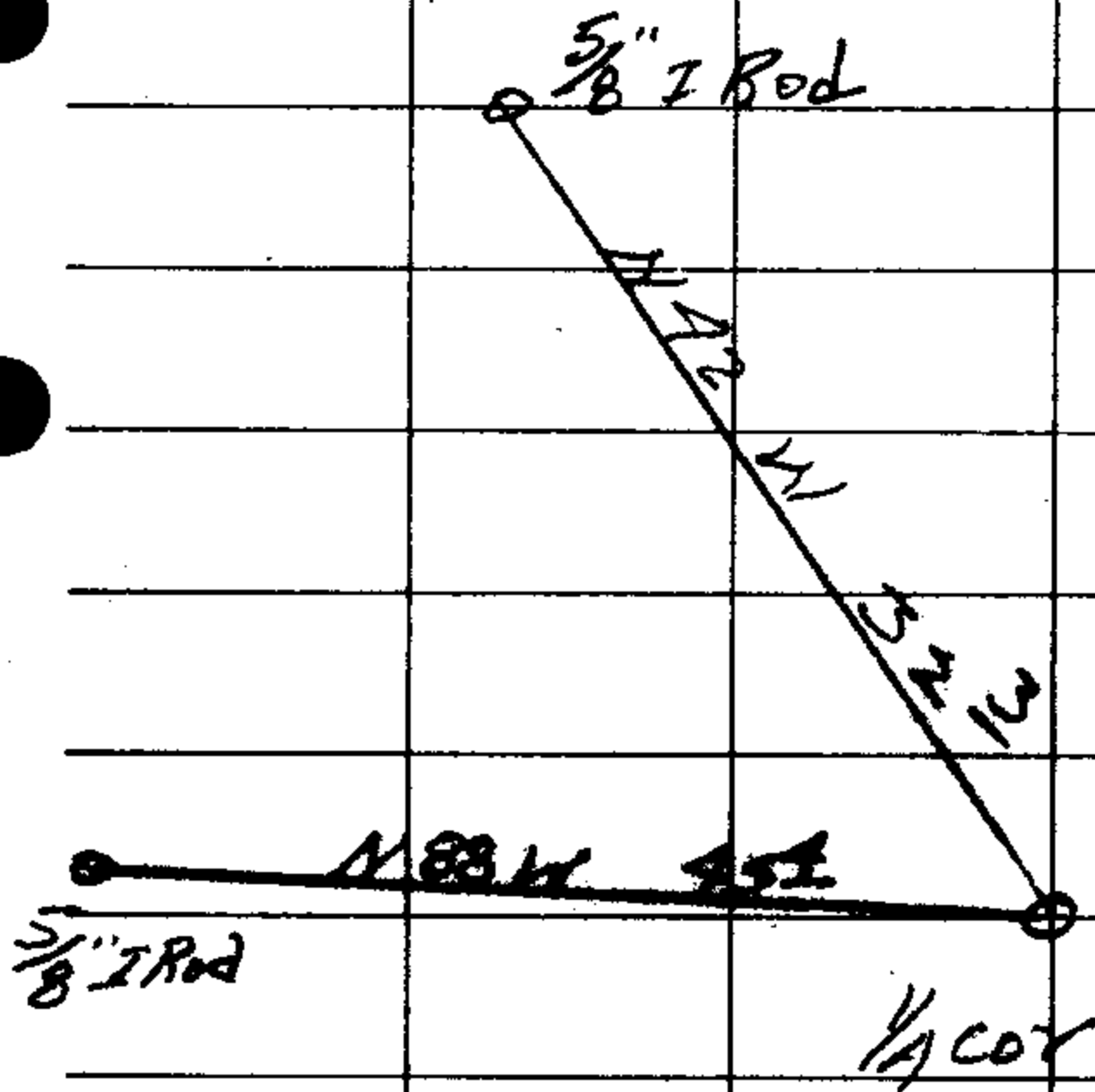

4-5-73

JMP?

C. S. File No. 57/12-8

REF.
NOTED.
24