

ROAD CONTROL SURVEY

Little River Road No. 17

T. 26, 27S, R. 3W, W.M.

COUNTY SURVEYORS FILE DATA
DO NOT REMOVE FROM OFFICE

SL

Surveyed for Douglas County
 Surveyed by Douglas County Surveyor's Office
 Francis L. Ingram County Surveyor
 Scale: 1" = 200' Sept., 1972

- ⊙ Brass Cap Set
- Boat Spike Found

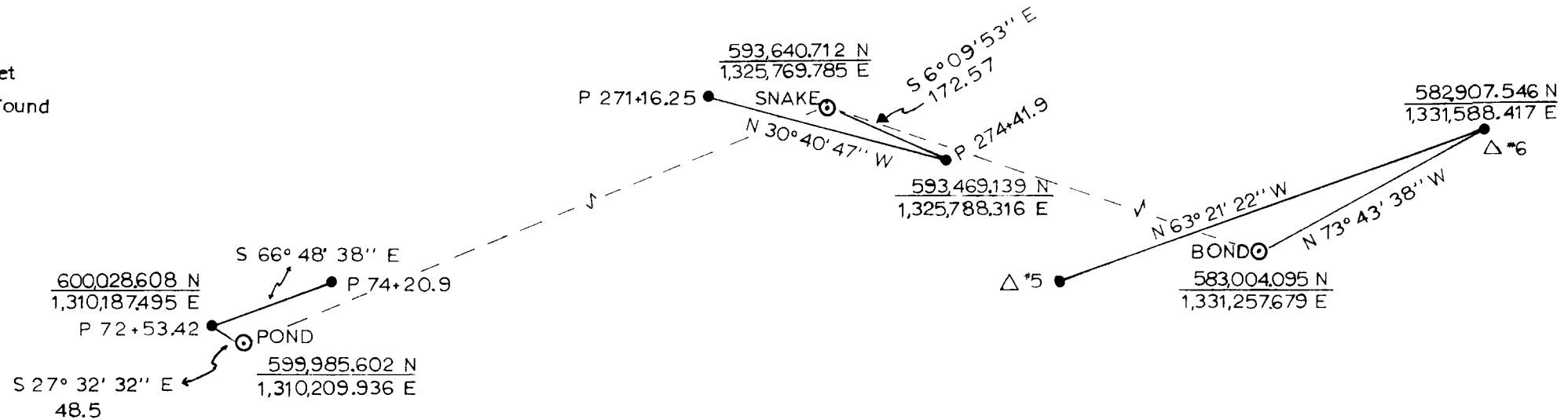

Survey Based On Geodetic Control Stations High, Scott, And White 2.

HIGH:
 $\frac{631,994.19 \text{ N}}{1,298,907.70 \text{ E}}$

SCOTT:
 $\frac{632,071.28 \text{ N}}{1,318,465.56 \text{ E}}$

WHITE 2:
 $\frac{540,061.14 \text{ N}}{1,322,750.48 \text{ E}}$

RECEIVED
 FRANCIS L. INGRAM
 COUNTY SURVEYOR
 SEP 21 1972

Francis L. Ingram

FRANCIS L. INGRAM
 COUNTY SURVEYOR
 SEP 21 1972

Note: All data shown based upon the Oregon State Plane Coordinate System, South Zone.

56/21

CS FILE FOLDER

CONTAINS

MORE

INFORMATION