

Cor set

531/7

T215 R12-11 W1

(14)

This cor set from survey as follows

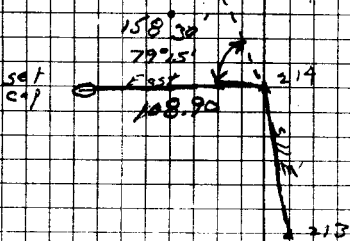

Set Brass cap at 1/4 cor MKD

county surveyors office

T215

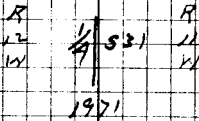

DIETZGEN NO. 388-6

24" SPRUCE 5 22 W 45 FT

MKD "1/4 S CS BT"

30" SPRUCE 5 20 E 20 FT

MKD "1/4 S 31 CS BT"

Note: This cor lies 100° (approx) North of ...

#66-T21-11W
#28-T21-12W
66

C.S. File No. 56/5-5