

Survey in Section 29, Township 29 South, Range 4 West, W.M.
 Surveyed for Glen Lewis by Don E. Garrett
 June 1974
 Scale 1" equals 200'
 o-Set 5/8" Iron Rod

COUNTY SURVEYORS FILE DATA
DO NOT REMOVE FROM OFFICE

FILED ✓
 RECEIVED 2/

JUN 18 1974

COUNTY SURVEYOR
 DOUGLAS COUNTY, ORE.
 ml

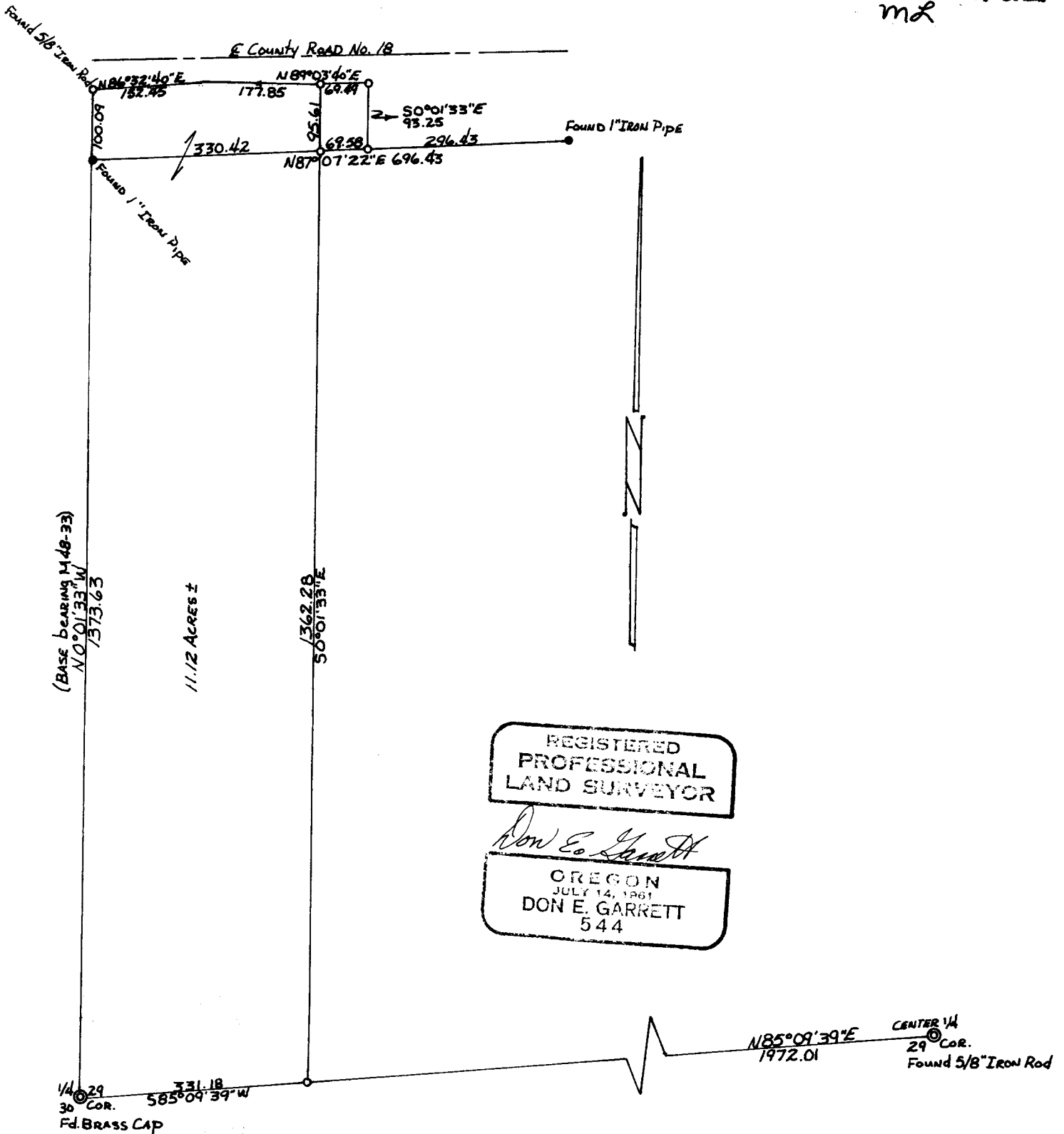

REGISTERED
 PROFESSIONAL
 LAND SURVEYOR
Don E. Garrett
 OREGON
 JULY 14, 1961
 DON E. GARRETT
 544