

T-305 R.G.W.M.M.

1/4 COR. 25
GUMBY RAD CLIFF
36 12/12/73
SET 24" W. GROUND
SET 1/2" I.P. WITH
BRASS CAP MARKER

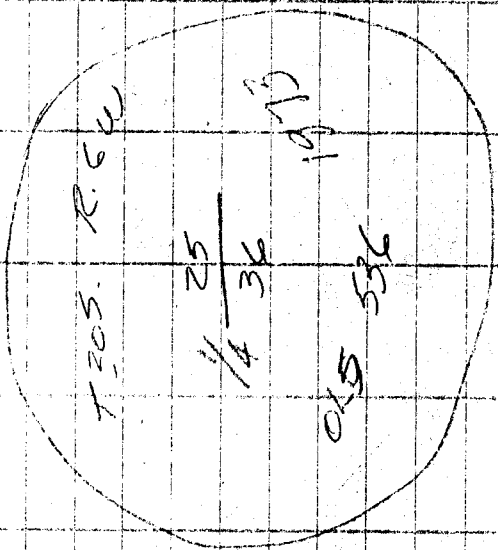

MARKED 6" MAGGIE
BEARS N 168° E. 11.6 FT.
SCRIBED 1/4 5 25 BT

MARKED 6" D FIR
BEARS S. 214° W. 8.2 FT
SCRIBED 1/4 5 36 BT.

COR. LIES ON NORTH SOUTH
RIDGE. APPROX 185' FROM T-305

*25

T. 30S R6WMM

12/12/78

Quincy
Eads/179

W 1/4 COR SEC 25
E6

Set A 14" with BESS (up
32" IN the Ground

Stamped W 1/4 25
E6

1978 ONS 536

From which a 10' FIRE

BEARS $N 12^{\circ} 31' 40" W$

$132 \pm @ 273^{\circ} 33' 20" = 132.05$

and a 20" FIRE BEARS

$N 48^{\circ} 09' 30" E$

$275 \pm LC$

BOTH TREES SCRIBED W 1/4 BT

27530

Note SEE Next Page

No. 302

Wt. on the Rain
WEATHERPROOF

J. L. GARLING CORP.
TACOMA WASH. U.S.A.

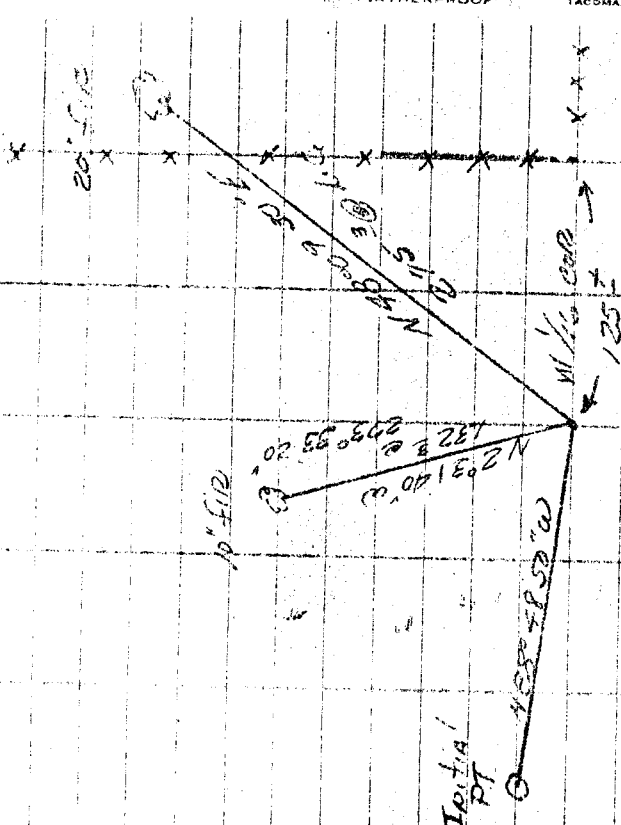

CORNER IS SET IN OPEN
FIELD 200' WEST OF RED
BARN. E 200' NORTH
OF WHITE HOUSE

T. 30S R6WWM

12/12/78

Quip by
Eagle/11/78

W 1/2 sec 500' 25
51

Set a 10" fire
32" in the ground

Stamped W 1/2 25
56

1978 015 536

Iron which a 10" fire

Bears N 2° 31' 40" W

32' @ 273° 33' 20" = 132.05

and a 20" fire Bears

N 48° 09' 30" E

275' @ LC

275.30

Both Tapes Scribed W 1/2 PT

Note See Next Page

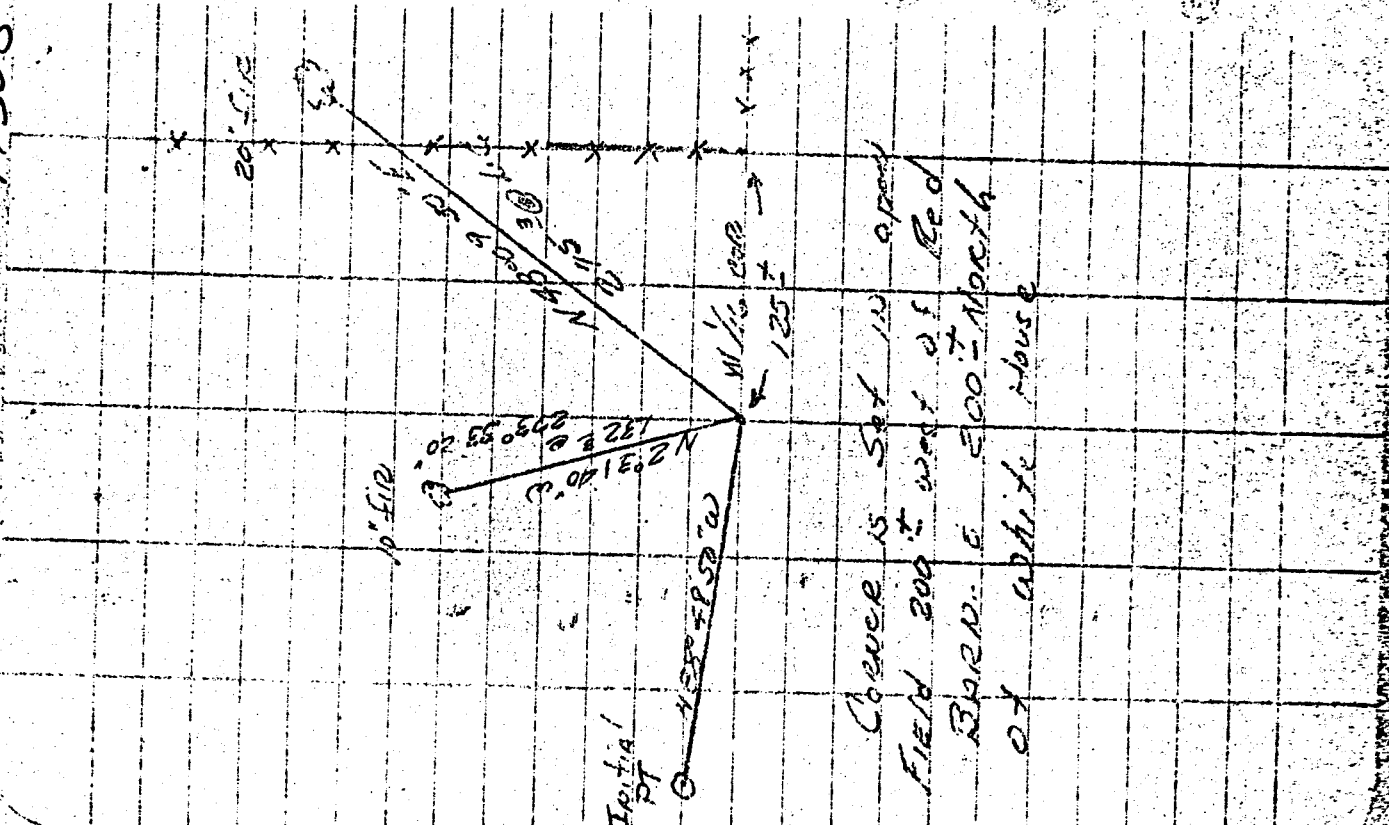

Cover is set in open
field 200' west of Red
BARN. E 500' North
of white house

No. 302

Get in the Rain
WEATHERPROOF

J. L. CARLING CORP.
TACOMA, WASH. U.S.A.

T-305. R. G. W. M. M.

1/4 COR. 25
QUIMBY RADCLIFF
30 4/21/2173.

SET 28" IN GROUND

SET 1 1/2" I.P. WITH

BRASS CAP MARKED

T-305. R. G. W.

1/4 25
36

OLD 536

1973

MARKED 6" MAGGIE

BEARS W/ W.P.E. 11.6 FT.

SCRIBED 14 5 25 BT

MARKED 6" P. FIR

BEARS 5.24 W. 8.2 FT.

SCRIBED 14 5 36 BT.

COR. LIES ON MOUNTAIN SOUTH

✓ RIDGE APPROX 185' FROM TOP

1973