

COUNTY SURVEYORS FILE DATA
DO NOT REMOVE FROM OFFICE

SURVEY
OF
NORTH LINE
SECTION 18, T26S, R2W, W.M.
DOUGLAS COUNTY, OREGON
FOR
WEYERHAEUSER COMPANY

FILED
RECEIVED

OCT 6 1973

COUNTY SURVEYOR
DOUGLAS COUNTY, OREGON

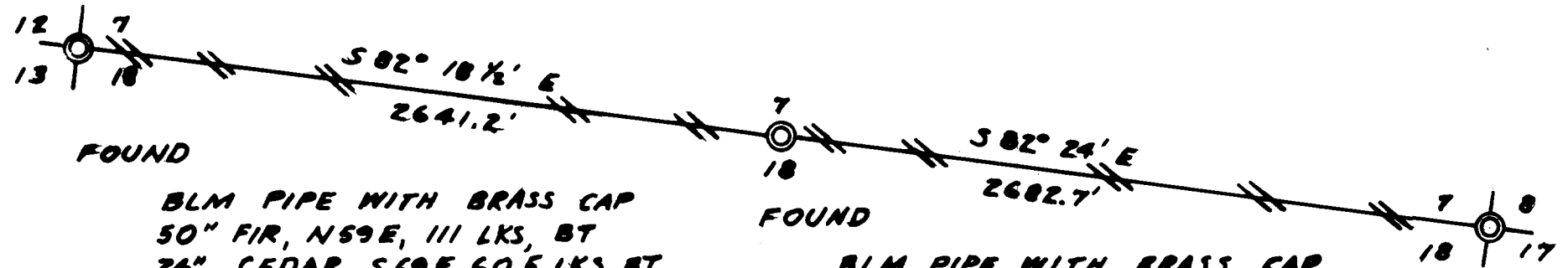
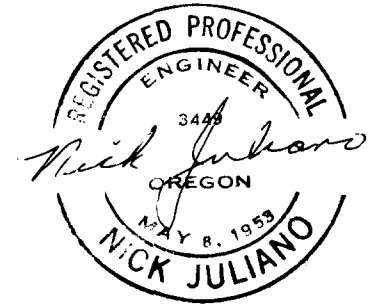

FOUND

FOUND

LEGEND:

CORNERS FOUND \odot
LINE MARKED WITH
NOTCH IN RED PAINTED
BLAZE $||$

BLM PIPE WITH BRASS CAP
50" FIR, N59E, 111 LKS, BT
24" CEDAR, S69E, 60.5 LKS BT
20" CEDAR, S70W, 48 LKS, BT
18" CEDAR, N57W, 49 LKS, BT

BLM PIPE WITH BRASS CAP
24" CEDAR, S17W, 14.5' W.CO. TAG
28" FIR, S19W, 69 LKS, BT
24" FIR, N16W, 37.3' BT

BEARING ASSUMED - MAG VAR 20°

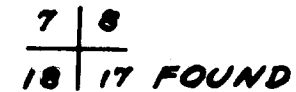

BLM PIPE WITH BRASS CAP
12" HEM, N51E, 66 LKS BT
12" CEDAR, S54E, 62 LKS, BT
9" HEM, N33W, 55 LKS BT

SCALE: 1" = 600'
SEPT 1973

BY TRIANGLE
ENGINEERING CO.