

N/4 SEC 7 T29S R7W

1/4 Sec 647

~~May~~ 21, 1973  
D. Springer  
D. Delaney  
PT. N 52° W, 1.65 FT  
2" White Fir  
Not scribed

#174

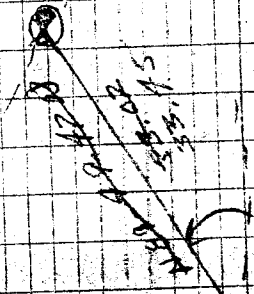

~~133.39 03~~

#106

B.T.  
6" Alder

SCOPE, 185.1 FT

15' North of creek  
stream

12-11-ED

#107

#206

FILED  
RECEIVED

JUL 10 1973

COUNTY SURVEYOR  
DOUGLAS COUNTY, ORE.

C.S. File 55-1-306-1

Map File M 50-11

↳ Cor Description

Found and reset 1" IP; with  
BC MARKED:

US Gov Land  
S 7  
1/4 318  
1924

From which the old BT.

A 12" IR, BRS 565°W, 52" dist.  
No visible scribe. Excellent face

Set new BT:

A 7" IR, BRS 512 1/2°W, 22" dist.  
Scribed "1/4 318 BT"

4/25/73  
PIESKE  
FROM DAHL

# 207

C.S. file 55/306

FILED  
RECEIVED

JUL 10 1973

COUNTY SURVEYOR  
DOUGLAS COUNTY, ORE

CS 1/16 S7

3

May 30, 1973  
Stanger  
DeFrey

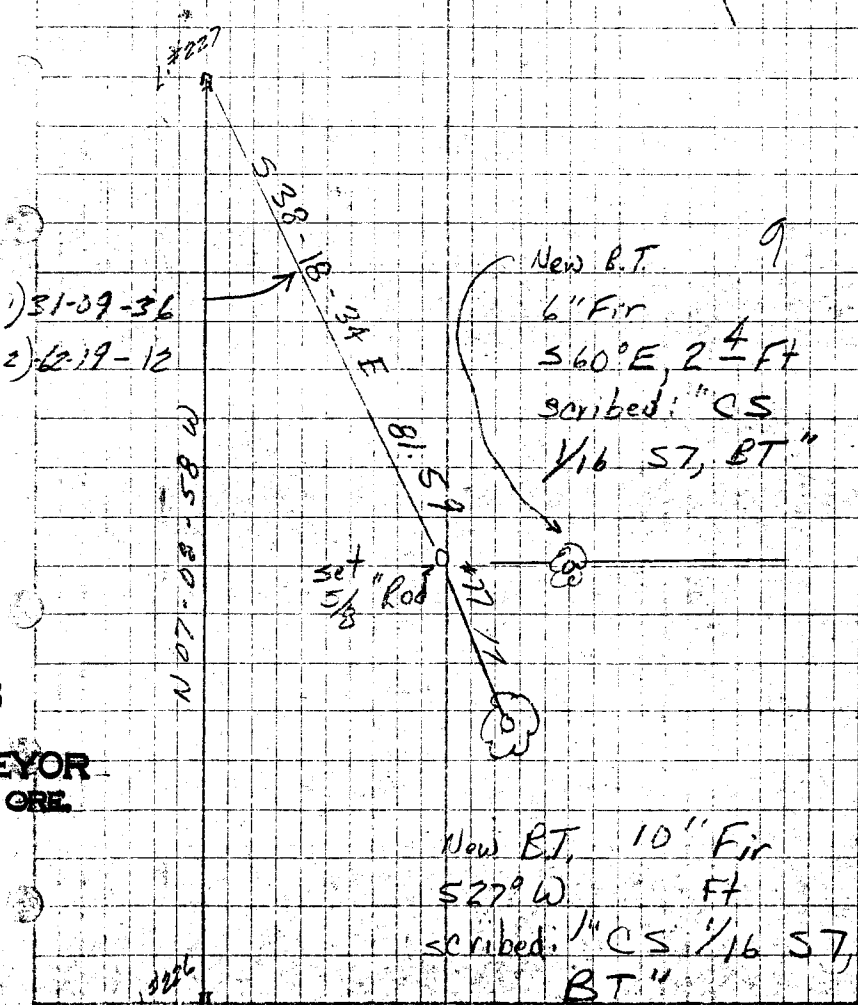

SE 1/16 S7

2

May 30, 1973  
Stanger  
DeFrey

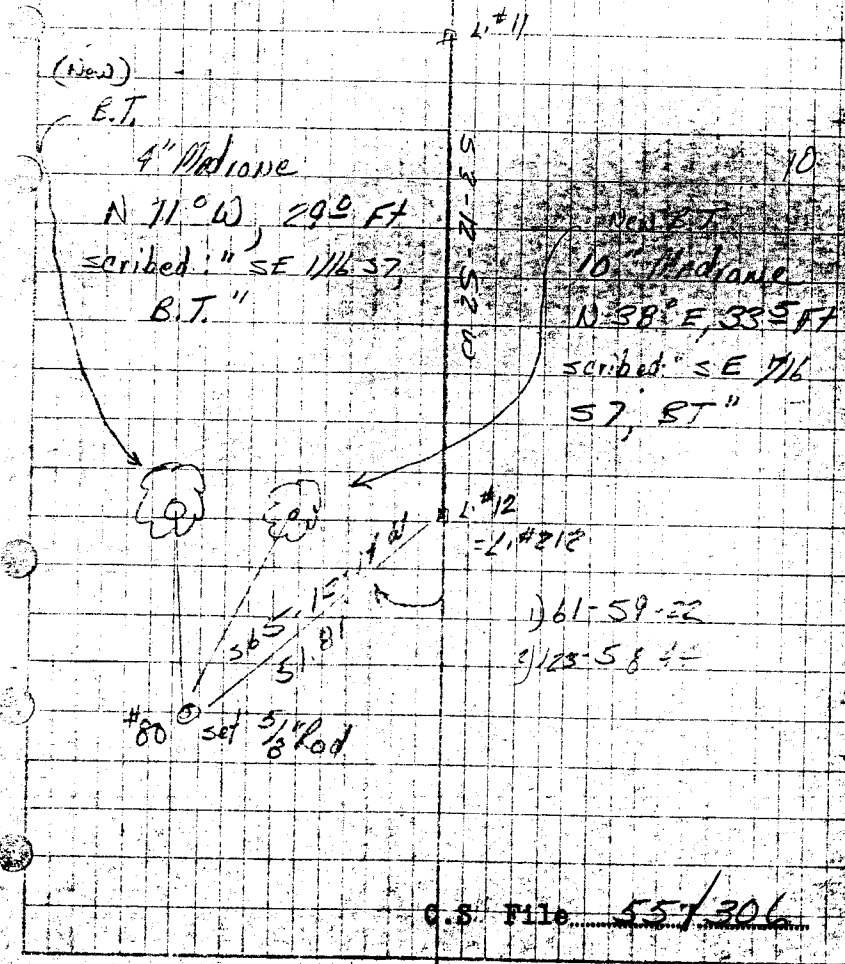

FILED  
RECEIVED

JUL 10 1973

COUNTY SURVEYOR  
CLATSOP COUNTY, ORE.

C.S. File 55/306

Map File M.50-17

MAY 30, 1973 4

Stringer  
Delaney

- 1) 74-33-00
- 2) 149-06-00

New BIT & Fir

N 45° E 11.5 FT  
Scripced  
" C 1/4 S7, E2

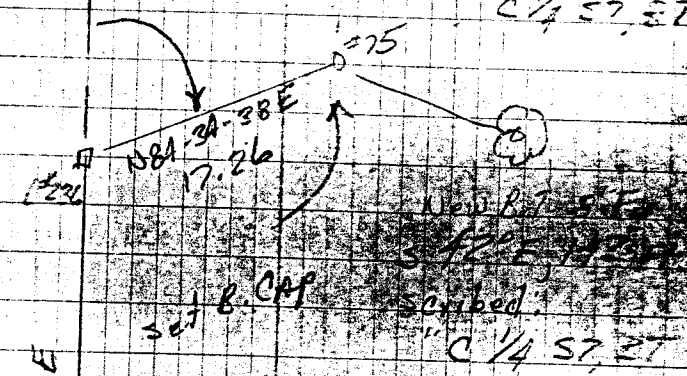

FILED  
RECEIVED

JUL 10 1973

COUNTY SURVEYOR  
DOUGLAS COUNTY, ORE.

#208

55/106