

NEW BT INFO

14" Oak scribed "1/4 S5 BT"
bears S 49° W, 156' FT.

14" Oak scribed "1/4 S4 BT"
bears N 86 1/2° E, 204' FT.

This corner lies in a large
cleared field with scattered
oak clusters, and 100' East

BC (Rect)
E 1/4 COR S5
T29S RTW 29° 09' @ level

- 1) 118° 34' 47"
- 2) 237° 09' 34"

BC (Set Wrong)
S 29° 53' 58" E 354.300'

#57 - SLAMA SURVEY

of a dirt road, and 100' East
of a stream, course South.

2/18/77
T-J. ARTMAN
CH - B. BAUGHMAN

RESET 1/4 COR S 1/4

89 59 60
60° 06' 02" N 29 53 58 E
58° 28' 45" 60° 06' 02"
89 59 60
118° 34' 47" S 31 31 15 E
58 25' 45"

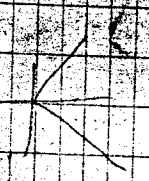

E 1/4 SET BY BAUGHMAN
FROM ERKOWICZ'S TIE.

31 31 15
180
29 53 58
359 52 60
241 25 7.3
118 34 47"

E 1/4 SET BY BYRON
(IN ERROR)

S.S. 55/296

B.T. 14" OAK

S 86° E 218.66

(225.9 @ +14° 33')

scribed: "1/4 S 4, B.T."

225.9 @ +14° 33'

S 41° W
(165.80 @ -08° 44')

B.T. 14" OAK
S 41° W
(165.80 @ -8° 44')

scribed "1/4
S 5, B.T."

(1) 54-05-26
(2) 108-10-52

1295 R 710
1/4
S 5 | S 4
015 539
1072

177-19
12#
12#

April 19, 1973

#204

FILED
RECEIVED

JUN 1 1973

COUNTY SURVEYOR
DOUGLAS COUNTY, OK

REN. #204-T29-7

#221-T28-7
#203-T29-7

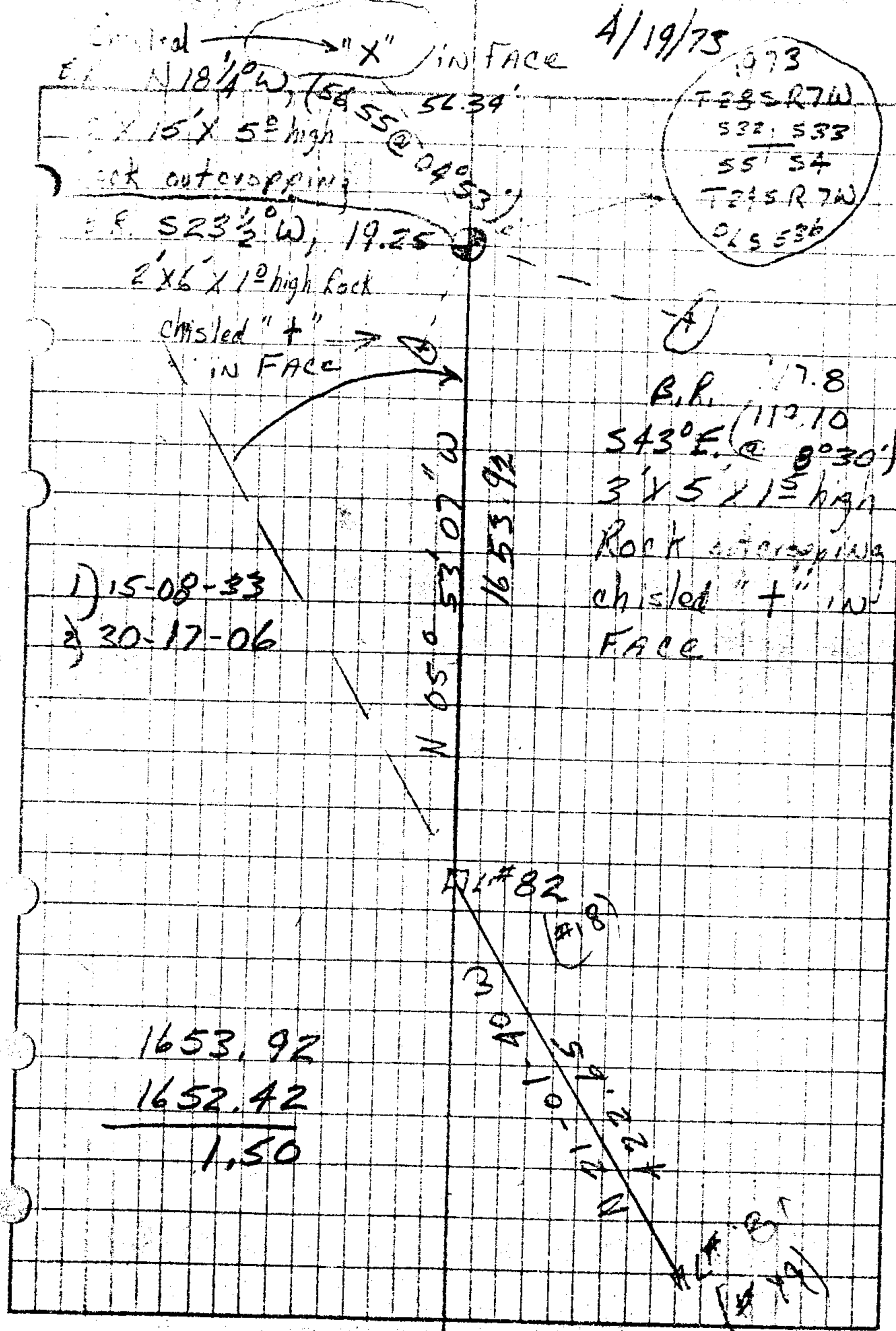

A/19/75
T285 R7W
S32.533
55.54
T245 R7W
OLS 536

B.P. 17.8
S43° E. @ 112.10
3' x 5' x 15' high
Rock outcropping
chisled "+" in
FACE

1) 15-08-33
2) 30-17-06

1653.92
1652.42
1.50

R#82
N 22° 10' 15\"/>

R#81
N 19° 19'

REN #222-T28-7
#202-T29-7

✓ April 19, 1975

set B.T. 12" LEVEL
S44° E, 22° FT
scribed
"1/4 55, BT"

T285 R7W
1/4 S32
55
T293 R7W
OLS 536

1) 42-01-33
2) 84-03-06

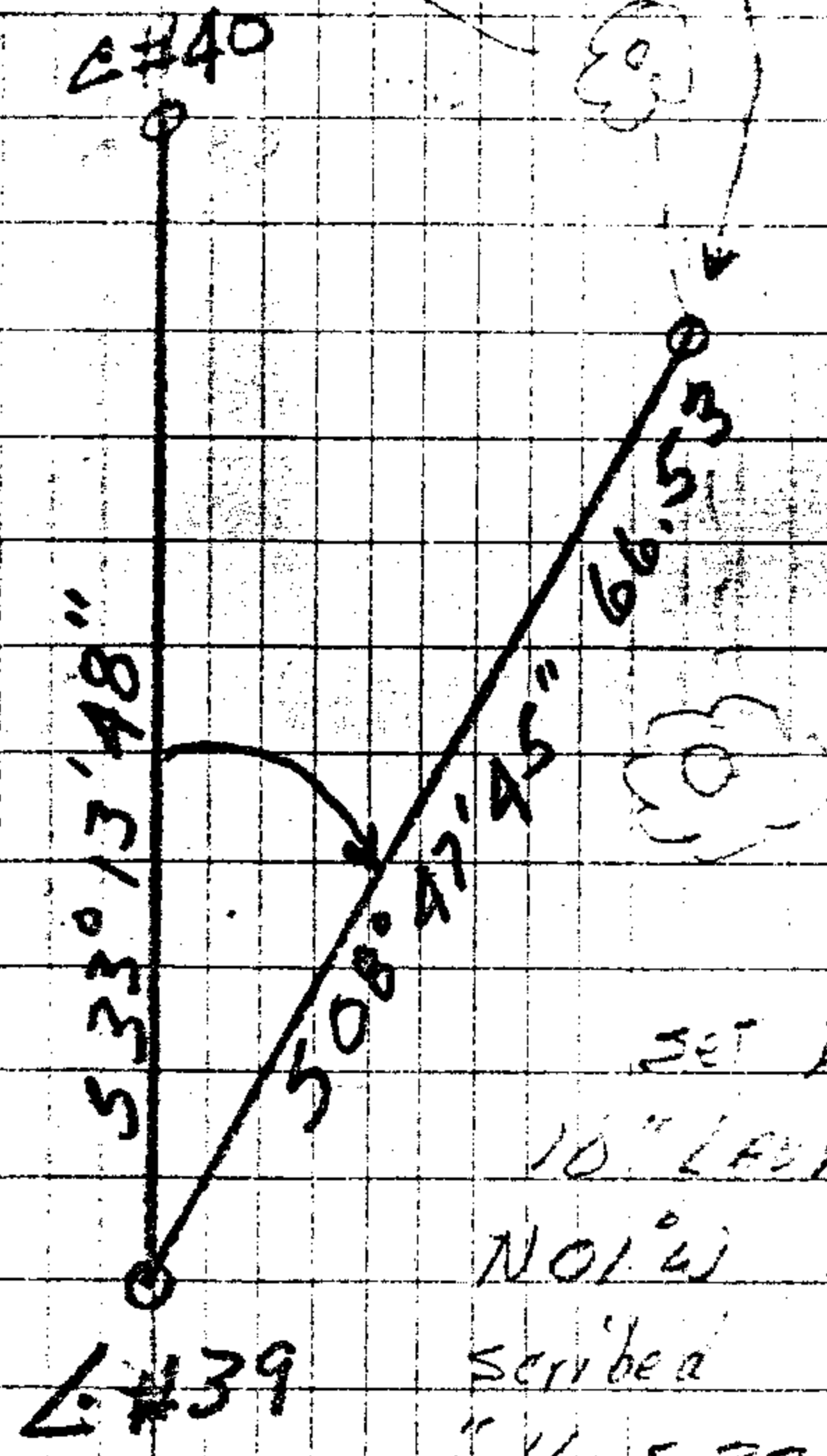

set B.T.
10" LEVEL
N01° W 19.5 FT
scribed
"1/4 532, BT"

W 1/16

SLAMA

4/19/73

CORNER DESCRIPTION

At the corner point set a 5/8" iron rod, extending 6" above the ground. From which the new BT's:

An oak, 24" in diam, bcs. 55' to W 47' dist scribed W 1/16 BT.

A madrone, 6" in diam, bcs N 6' E 16' dist. scribed: W 1/16 BT.

Kirk F. Ledy
Mike F. Smith