

**COUNTY SURVEYORS FILE DATA
DO NOT REMOVE FROM OFFICE**

FILED *ll*
RECEIVED *ll*

JUL 20 1971

Sec. Corner FOUND:

**Brass Cap, Douglas County
Renewal 1967**

- 41" D.F., S 52° 20' W, 36.7 ft.
- 36" D.F., N 70° 32' W, 10.8 ft.
- 26" I.C., N 49° 21' E, 22.0 ft.
- 10" W.F., S 27° 13' E, 87.2 ft.

SURVEY BY:

**THE ROBERT DOLLAR CO.
GLENDALE, OREGON 97442**

PURPOSE:

To re-establish the 1/4 Corner of
Sec. 11-12, T 31 S., R. 9 W., W. M.

LOCATION:

The section line of Sec. 11 & 12

BASIS OF BEARING:

Sun Shot, July 8, 1971

DATE OF SURVEY:

July 6-12, 1971

LEGEND:

MONUMENTS FOUND - ●

MONUMENT SET - ○

SCALE - none

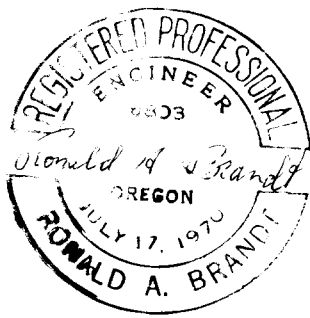

1/4 Corner SET:

- 1" X 36" Iron Rod, driven flush
- 8.8" D.F., N 83° 58' W, 19.54 ft.
mkd. 1/4 S. 11 P.E. 6803 BT
- 7.2" D.F., S 26° 46' E, 29.54 ft.
mkd. 1/4 S. 12 P.E. 6803 BT

**NOTE: tree measurements all current with
diameters taken at DBH.**

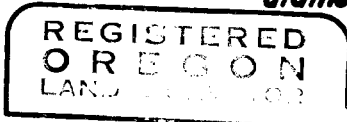

Ronald A. Brandt

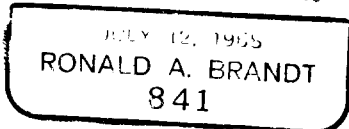

Sec. Corner FOUND:

**Brass Cap, Douglas County
Renewal 1967**

- 11" D.F., S 28° 57' E, 21.2 ft.
- 9" D.F., N 13° 31' W, 21.1 ft.
- 7" Mod., N 32° 29' E, 23.8 ft.
- 48" I.C., S 40° 22' W, 13.5 ft.



NOTE: 1/4 Cor. Post set in 1958 Staff Compass Survey by THE ROBERT DOLLAR CO.
in N 08° W, 2 ft. from the IRON ROD set in this Survey.

COUNTY SURVEYORS FILE DATA
DO NOT REMOVE FROM OFFICE

July 15, 1971

Ronald A. Brandt, Engineer
THE ROBERT DOLLAR CO.
Glendale, Oregon 97442

NARRATIVE of SURVEY

concerning Section line common to Sec. 11-12, T. 31 S., R. 9 W., W. M.

Survey by The Robert Dollar Co. concerning the west line of Sec. 12 and the 1/4 Corner of Sections 11-12.

PURPOSE: to re-establish the obliterated 1/4 Corner of Sections 11 and 12, and to establish line between those Sections;

METHOD: a transit traverse between the SW and NW section corners of Section 12 measuring distances to the nearest 1/100th foot and angles to 30 seconds; bearing determined by Sun Shot on July 8, 1971;

EQUIPMENT: the work was conducted with a Gurley Transit and an adding 200 ft. steel chain;

RESULTS: the 1/4 Corner of Sections 11-12 was monumented and the south 1/2 of the section line brushed out and blazed;

INDIVIDUALS and DATES: this survey was begun July 6, 1971 and was completed July 12, 1971; witnesses to the work were Darrell Woolsey and Richard Winegar;

REFERENCES: government survey records of Douglas County, Oregon pertaining to the NW and SW section corners of Section 12 and the 1/4 Corner and section line of Sections 11-12, T. 31 S., R. 9 W., W. M.; aerial photographs;

CORNER SET: a 1" x 36" Iron Rod, driven flush monumenting the 1/4 Corner, Sections 11 and 12 from which bears -

a 8.8" D. F., N 83° 58' W, 19.54 ft.
marked 1/4 S. 11, P. E. 6803, B. T.

a 7.2" D. F., S 26° 46' E, 29.54 ft.
marked 1/4 S. 12, P. E. 6803, B. T.

this monuments the re-established 1/4 Corner, Sec. 11-12 originally set in 1901 and monumented then as follows -

a stone 16" x 10" x 4" down 12 ins. in the ground
marked 1/4 on the West face from which beared -

a 30" Fir, N 75° E, 40 lks.
marked S. 12, 1/4 S., B. T.

a 5" Laurel, S 63° W, 7 lks.
marked S. 11, 1/4 S., B. T.

evidence for this original corner is assumed destroyed and has been searched for by:

- 1) The Robert Dollar Co., 1958
- 2) Douglas County Surveyors Office, 1967
- 3) The Robert Dollar Co., 1970 and 1971

facts supporting loss of evidence:

- 1) very hot burn in early 1900's
- 2) rock is sedimentary and highly errodable

FILED
RECEIVED *LR*

JUL 20 1971

COUNTY SURVEYOR
DOUGLAS COUNTY, ORE.

PAGE 1 OF 2

Rem # 155

**COUNTY SURVEYORS FILE DATA
DO NOT REMOVE FROM OFFICE**

(CONTINUATION of NARRATIVE)

CORNERS FOUND: the corner to Sections 1, 2, 11 and 12 found as follows -

Brass Cap, 1967 Douglas County Renewal

41" D. F., S 57° 20' W, 36.7 ft.
36" D. F., N 70° 32' W, 10.8 ft.
26" I. C., N 49° 21' E, 22.0 ft.
10" W. F., S 27° 13' E, 87.2 ft.

the corner to Sections 11, 12, 13 and 14 found as follows -

Brass Cap, 1967 Douglas County Renewal

11" D. F., S 28° 57' E, 21.2 ft.
9" D. F., N 13° 31' W, 21.1 ft.
7" Madrone, N 32° 29' E, 23.8 ft.
48" I. C., S 40° 22' W, 13.5 ft.

NOTE: all tree measurements are current, taken at DBH and distances to those trees measured to position of the scribing "B. T."

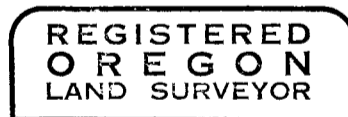

Ronald A. Brandt

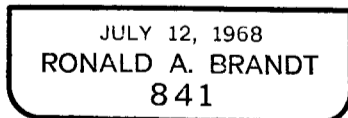

FILED *SL*
RECEIVED *2/7*

JUL 20 1971

COUNTY SURVEYOR
DOUGLAS COUNTY, ORE.