



COOS HEAD TIMBER COMPANY

lumber / plywood / pulp

P. O. BOX 750 • COOS BAY, OREGON 97420 • PHONE 267-2193

R. 8 W.

10 December 1968

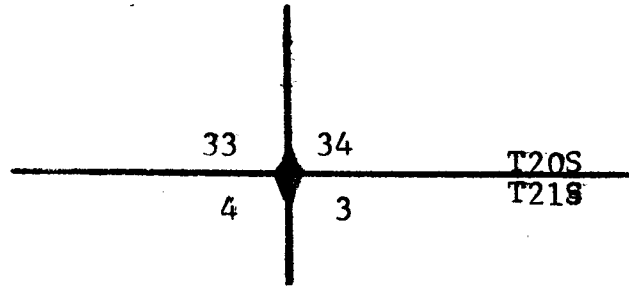

Found existing brass cap set by U.S. Cadastral Engineers and two BT's in section 33. I set the three BT's that follow:

- Bark scribed 24" DF stump S70°W 28.1'
- Bark scribed 42" DF stump S47°E 88.9'
- Bark scribed 22" DF stump N37° 45'E 50.0'

FILED *LL*
RECEIVED

DEC 30 1968

COUNTY SURVEYOR
DOUGLAS COUNTY, ORE.

Ronald E. Stutzner

*O.K.
J.W.B.*

#6-T20-8 ✓
78-T21-8 ✓

C. S. File No. 55/99

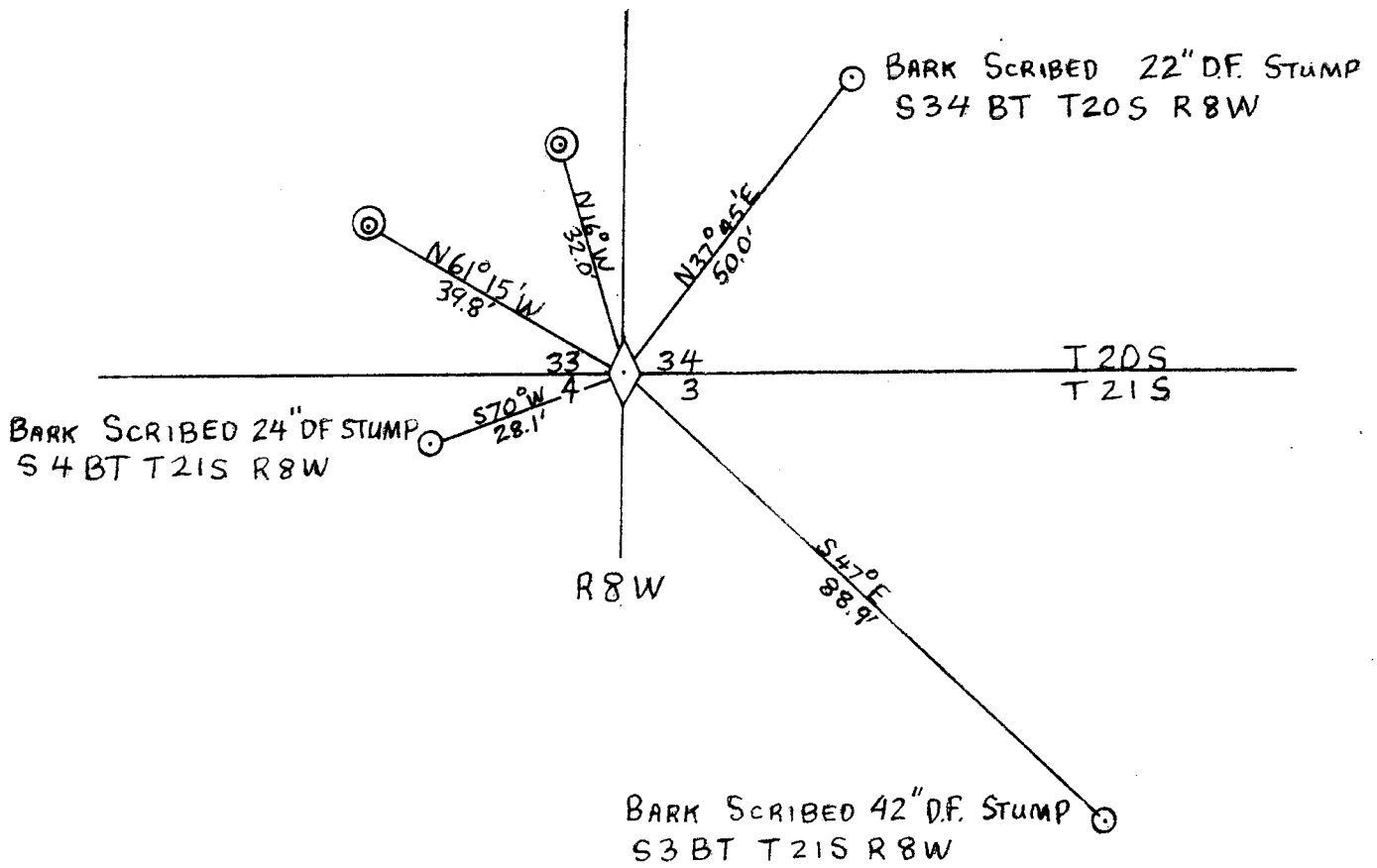

SCALE: 1" = 25'

Nov. 1968

- ⊙ SCRIBED NEW BT.
- ⊗ FOUND EXISTING BT
- ◇ FOUND BRASS CAP SET BY U.S. CADASTRAL ENGRS.

**COUNTY SURVEYORS FILE DATA
DO NOT REMOVE FROM OFFICE**

Ronald C. Stutzner

C. S. File No. 55/99

[Handwritten signature]
DEC 30 1968
COUNTY SURVEYOR
[illegible]