

A SURVEY OF LOTS 33 & 34
BLOCK 24, AMENDED PLAT
OF THE TOWNSITE OF SUTHERLIN
DOUGLAS COUNTY, OREGON
SURVEYED FOR HANDY REALTY 6-9-66
BY DON E. GARRETT SCALE 1"=50'

Bearings are based on the North Line of Central Ave., from
the Amended Plat of the Townsite of Sutherlin. N77°04'E.

REGISTERED
OREGON
LAND SURVEYOR

Don E. Garrett
JULY 14, 1961
DON E. GARRETT
544

• - Denotes set 1/2" I.P.

Fd. I.P.
NW Cor. of Lot 1
Block 11

COUNTY SURVEYORS FILE DATA
DO NOT REMOVE FROM OFFICE

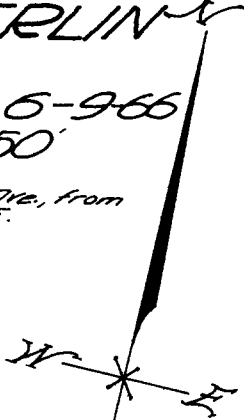

FIRST AVE.

