

Fd. CORs T275 <sup>531</sup> <sup>AMP</sup> <sup>N4</sup> R2W  
T285 <sup>1/4</sup> <sup>56</sup>

Fd. US Plywood Alum. caps set  
in 1968 as follows -

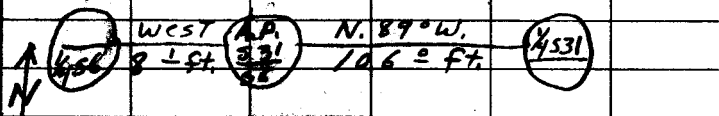

△ from The 1/4 56 COR B.T.s as follows -

OB.T.? 11" cedar S. 30° E. 11 1/2 ft.

old scribe on chopped out blaze "1/4 56 BT"

New BT. - 20" cedar S. 70° W. 34 1/2 ft.

scribed "1/4 56 BT" Alum. Tag # 4287

From The A.P. <sup>531</sup>/<sub>56</sub> New B.T.s as follows -

11" D. FIR S. 65° E. 19 1/2 ft.

scribed "AP 56 BT" Alum. Tag # 4287

11" D. FIR N. 4° W. 33 1/2 ft.

scribed "AP 531 BT" Alum. Tag # 4287

we find no orig. B.T.s -

FROM THE 1/4 531 COR - B.T.s as follows -

38" cedar stump N. 65° W. 50 1/2 ft.

scribe "1/4 531 BT" Alum. Tag # 4287

The Above COR. S 211 UNRECORDED  
to date.

OCT 28, 1968

V.R.T.  
JH

V.R. Tracy

#93-727-2

DIX  
T. H. B.  
C. S. H. No. 59/40-99