

June 17, 1965

Description for George Luoma.

All that portion of Section 19, T. 27 S., R. 5 W., W. M., described as beginning at a $\frac{3}{4}$ " iron rod in the East R/W Line of Metzger Court at the Northwest Corner of the G. E. Gosline Property, as described by Ins. No. 282852, Deed Records of Douglas County, Oregon, and from which the intersection of the East R/W Line of Chadwick Street with the centerline of Cass Avenue, bears N.85°26'40"W. 32.73 feet and S.64°10'40"W. 136.02 feet;

Thence, N.68°03'E. along the northwesterly line of said Gosline Property 26.0 ft. to a $\frac{3}{4}$ " iron rod;

Thence, continuing N.68°03'E. 11.0 feet to a $\frac{3}{4}$ " iron rod;

Thence, N.37°46"W. 26.0 ft. to a $\frac{3}{4}$ " iron rod in the East R/W Line of said Metzger Court;

Thence, S.28°09'W. 39.0 feet to the point of beginng.

James W. Byron
County Surveyor

June 17, 1965

Description for George Luoma.

All that portion of Section 19, T. 27 S., R. 5 W., W. M., described as beginning at a $\frac{1}{2}$ " iron pipe in the West R/W Line of Metzger Court, at the Northeast Corner of the R. L. Wiley Property, as described by Ins. No. 275669, Deed Records of Douglas County, Oregon, and from which the intersection of the East R/W Line of Chadwick Street with the centerline of Cass Avenue bears $S.64^{\circ}10'40''W.$ 136.02 feet;

Thence, $N.61^{\circ}51'W.$ along the north line of said Wiley Property 27.02 feet to a P. K. Nail;

Thence, $S.16^{\circ}51'E.$ 8.49 feet to a P. K. Nail;

Thence, $S.61^{\circ}51'E.$ 21.02 feet to a $\frac{1}{2}$ " iron rod in the West R/W Line of said Metzger Court;

Thence, $N.28^{\circ}09'E.$ 6.0 feet to the point of beginning.

James W. Byron
County Surveyor

May 26, 1965

LUOMA SURV.

BR
WS
MS

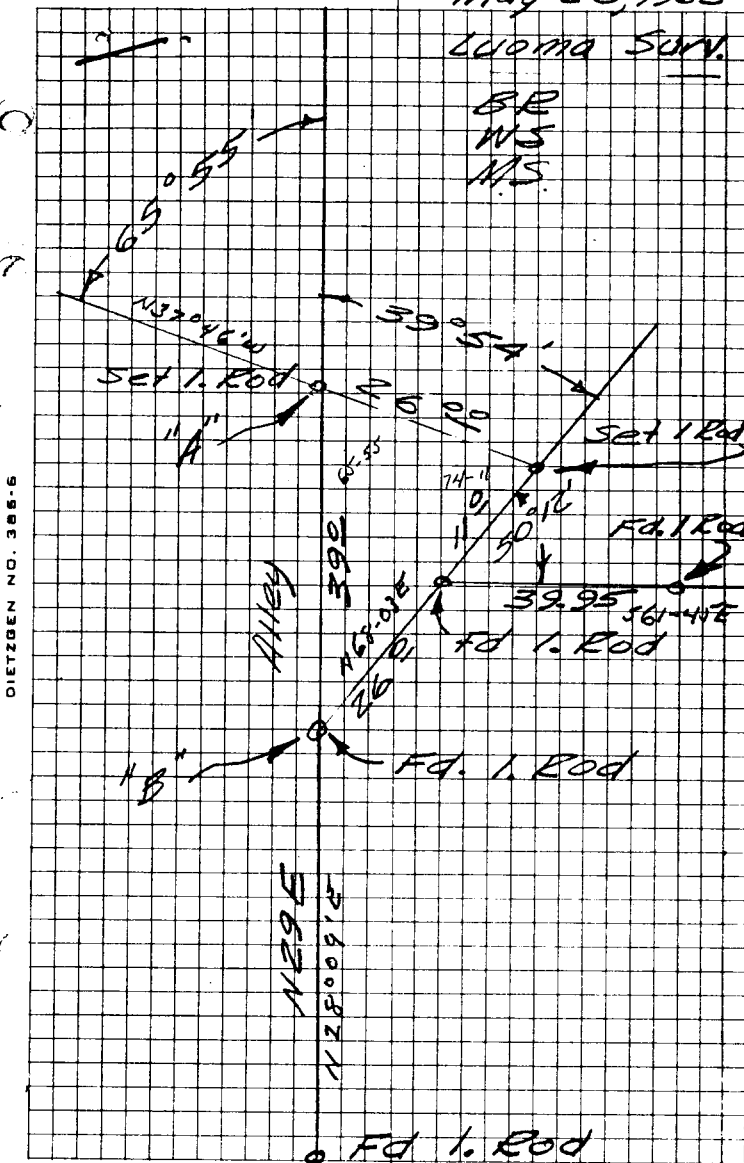

DIETZEN NO. 385-6

C.S. File No. 54/9C

(SEE FOLDER FOR MORE INFO)