

D. W.
SPRINGFIELD
SURVEY FILE

WEYERHAEUSER TIMBER COMPANY

Section 12 Township 26 S Range 3 W

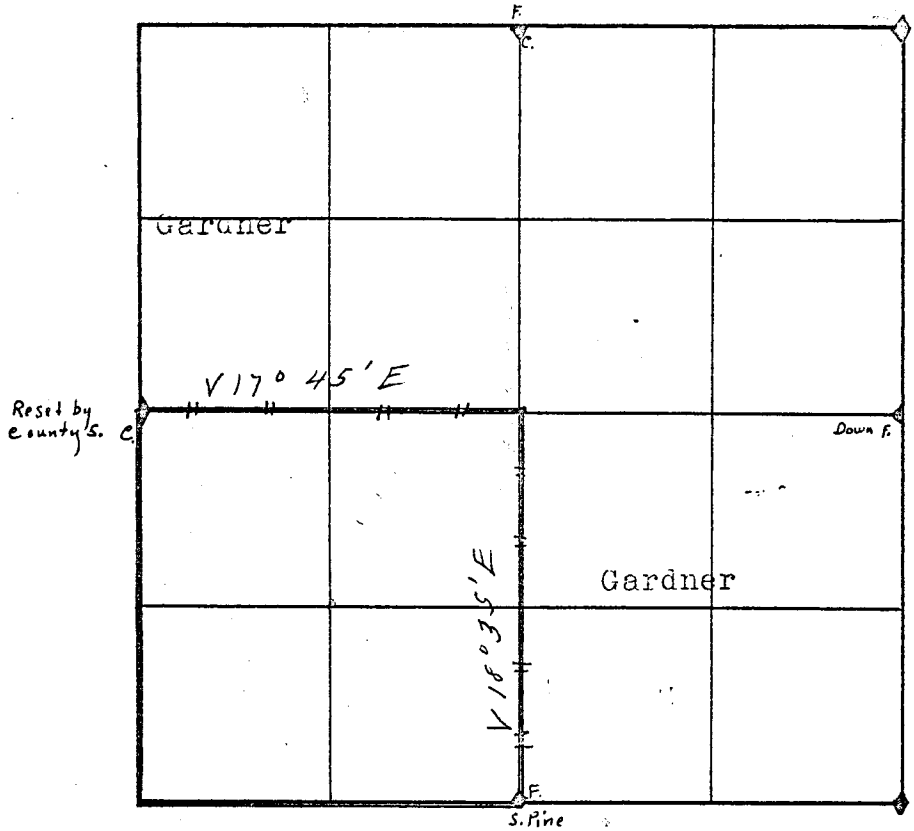

North and East boundary lines have been run and blazed as indicated.

Lines were run with the assistance of J.R.Gardner.

Gardner and Hechberg Logging Co., P.O. Box 991, Roseburg, Oregon, are logging in the SE quarter of Section 12, 26S-3W.

FILED

RECEIVED

MAR 17 1969

COUNTY SURVEYOR
DOUGLAS COUNTY, OREGON

Examined September 18, 19 46

By Marion D. Hale

M. W. A.

53/115-5