

Renewal

15/14
22/23

7325 R5W

Found:

Large spike (unrecovered) at Sac car, which lies in North bound traffic lane.

Bound Mark is concrete East 193°

Also From state Highway notes Equal Hub & Spoke 908° which by compass Bearing is N3E

16" cedar $\left(\begin{array}{c} \text{S} \\ \text{---} \\ \text{E} \end{array} \right) 40^\circ$ $\left(\begin{array}{c} \text{N} \\ \text{---} \\ \text{E} \end{array} \right) 15^\circ$ 30" Cedar

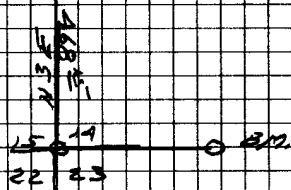

other Points Not Found.

Renewal:

New Bearing objects:

B.B. Spike N3E 193°

This spike is on south bound lane on south shoulder.

P.P. spike SW 30°

This spike is on north bound lane on south shoulder.

Note: state Highway notes state that this car is at STA 135+00

9-7-67
JCB

76 J.W.B.

U.S. File No. 53/52-51

DIETZGEN NO. 386-S

①

Line Date 3-10-65 Party ^{Stalder} Whitelide.

Coker

Daks

Project Azalia Joe. Co. Line Smith

BM

N 63° 46' 30" E

Δ B

9° 08' RT
18° 16'

N 54° 38' 30" E

Δ A

8° 58' 30" LT
17° 57'

N 63° 37" E

PC

PCS

3° 00' LT
6° 00'

N 66° 31" E

PT

0° 40' LT

Bearing used $N 67^{\circ} 17' W$, from
 R/W Map Dwg. No. 68-11-16, for
 tangent south of sec. Corn

TRANSIT SHEET

Form E33-30M-7-63-52193

BM

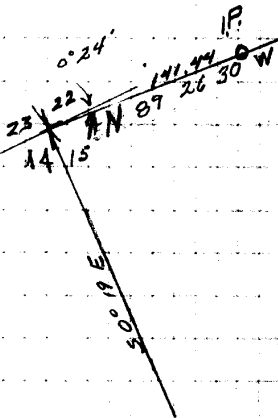
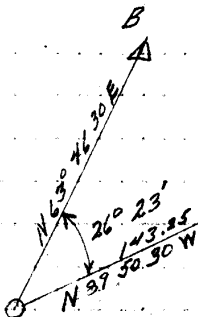

Form E33-30M-7-63-32193

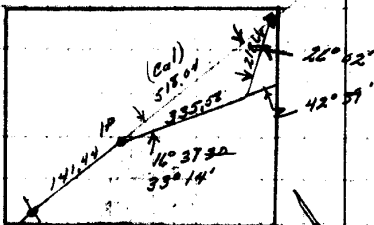

Triangulation around 3' cottonwood tree

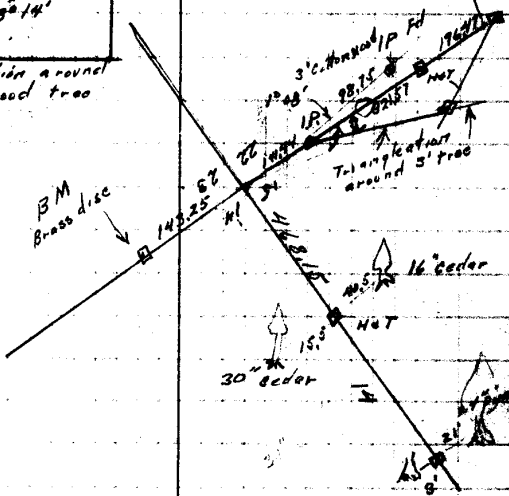
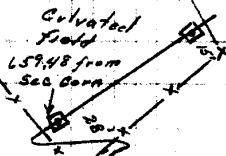

Triangulation around 5' tree

4 trunk cottonwood