

FILED
RECEIVED

MAR 25 1964

COUNTY SURVEYOR
DOUGLAS COUNTY, ORE.

REGISTERED
OREGON
LAND SURVEYOR

Geo. J. Wenderoth

MARCH 10, 1944
George J. Wenderoth
5

T. 33-6 R. 4

COUNTY SURVEYOR'S FILE DATA
DO NOT REMOVE FROM OFFICE

COUNTY SURVEYOR'S OFFICE
DOUGLAS COUNTY, OREGON.

SURVEY FOR

JIM D. MOSLEY

LOTS 9 & 10 CLARA ADDITION TO
CITY OF GLENDALE, OREGON.

G.J. WENDEROTH, DEPUTY, March 25, 1964.

SCALE 1"=50ft.

C. S. File No. 53/43-2

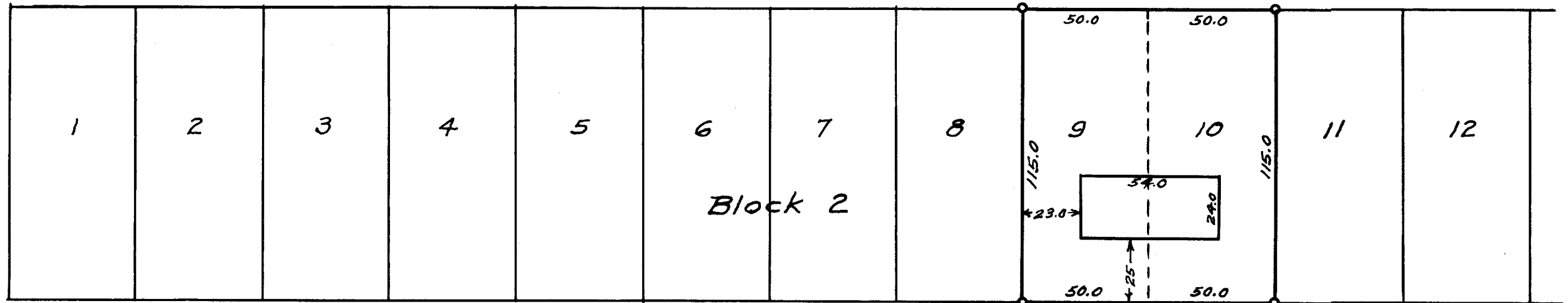

SETH

AVE.

