

RENEW - S.E. Cor. D.L.C. # 56

CTR. C. 100

ENTILED 2" + ON ONE PIER OF BRIDGE 6' ABOVE GR.

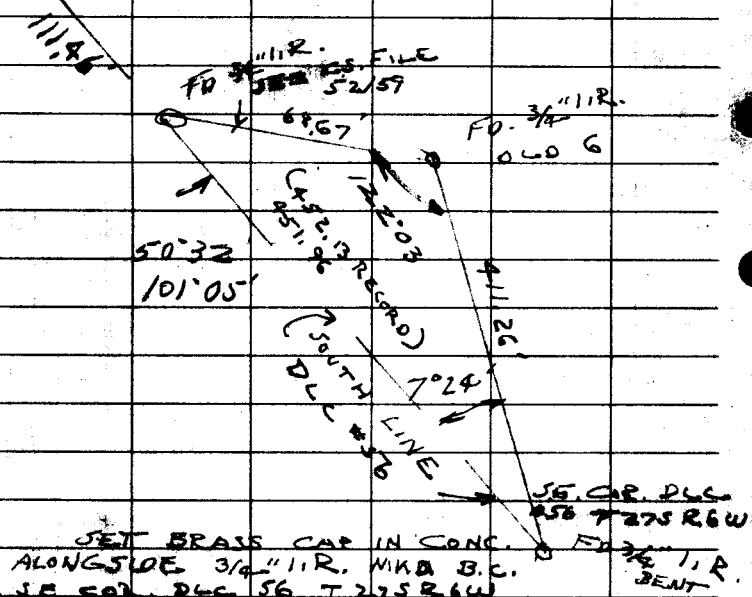

SET BRASS CAP IN CONC. ALONGSIDE 3/4" I.R. WKA B.C. SE COR. D.L.C. 56 T 275 R 6W 1966. SET PK NAIL IN SOLID ROCK

OUT COR. (N 0° 47' E PER M4/11) 53.67'

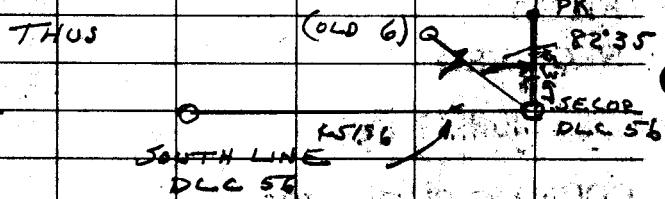

JUNE 7-66

J.B.
P.T.

G.S. 53/38 - 11

#121
*