

REM.

T 23 S R 4 W

COR. 15 14
SECS. 22 23FD. OLD UPROOTED FIR N 21° E
(NOW 24" DIAM.)

9 1/2 FT. FRAGMENTS OF SCRIBING VISIBLE
ON PARTLY ROTTED & CHARRED FACE.
(PREVIOUSLY OPENED) - RING COUNT PROVES IT ORIG. B.T.
NO TRACE OF ANY OTHER ORIG.

B.T.'S FD.

AT COR. SET IRON PIPE WITH
BRASS CAP MKD. "COUNTY SURVEYOR'S
OFFICE 1963 T 23 S R 4 W S 15 S 14"
S 22 S 23

BLAZE & SCRIBE NEW TREES:

5" DOUG. FIR S 80° W 5 1/2 FT.

MKD. "S 22 C S BT"

6" DOUG. FIR N 46° W 12 1/2 FT.

MKD. "S 15 C S BT"

9" DOUG. FIR N 55° E 21 1/2 FT.

MKD. "T 23 S R 4 W S 14 C S BT"

6" DOUG. FIR S 63° E 10 1/2 FT.

MKD. "S 23 C S BT"

A "T" IRON (NO CAP) BEARS
S 52° W 2 1/2 FT.

COR. LIES ON STEEP NORTH SLOPE,
APPROX. 100 FT. SOUTH OF BOTTOM OF
SLOPE.

MAR. 21, 1963

Milo E. Hoddy

M.G.

V.T.

M.S.

C.S. File No.

53/9-124

Section 23 TWP 33 S Rge 4 W Date: 3/12/63

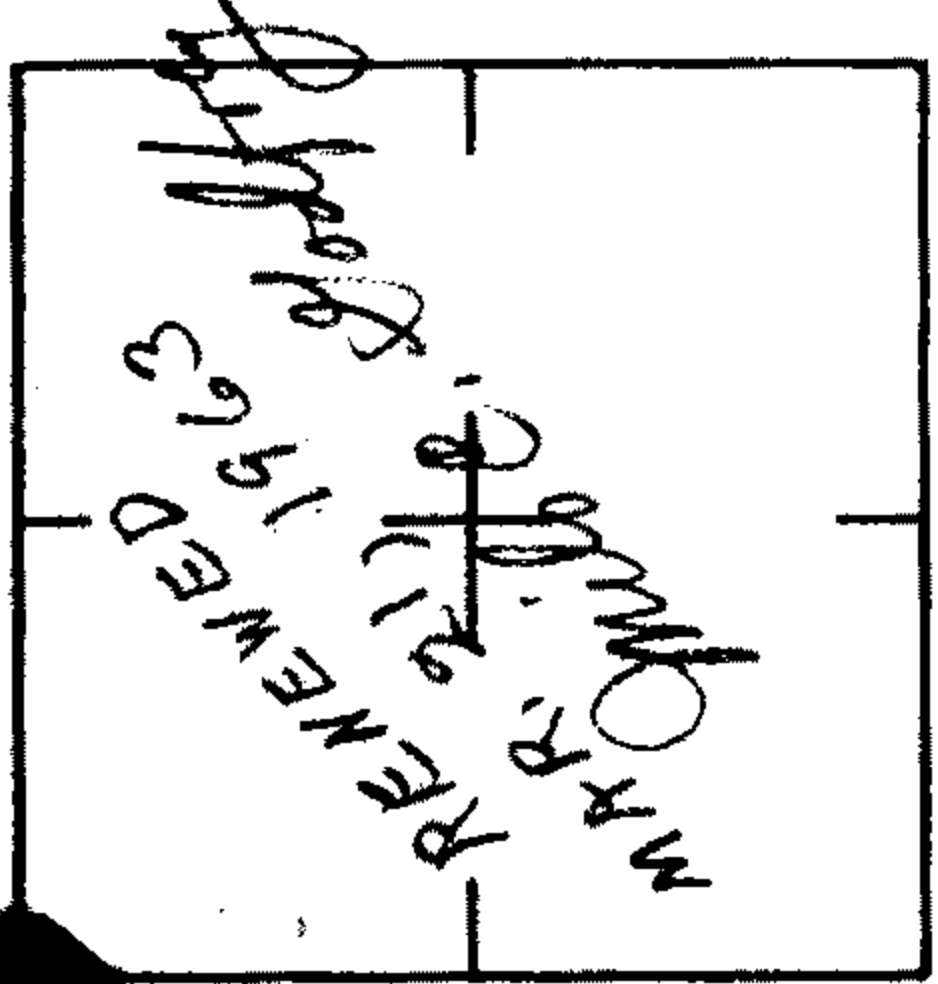

How was corner identified? Iron & wooden stake.

Condition of corner: OK

Best route to reach corner: Interstate #5, E/Khead road, road past Elkhead mines, then walk in show.

Other Remarks: along ridge top.

BT is down and rubings. Scribe has been chopped out and is partially visible.

John F. Rice
Signed

Quadrant	NE	NW	SE	SW
Species & Size	18" D. Fir			
Dist. & Bearing	N18E, 12' approx.			
Condition of Scribe	Poor			
Original or Resurvey	Orig?			
Appearance of B.T.	Poor			
Tags, Marks, etc.	B.T.M.?			