

REN.

T 23 S R 4 & 5 W

COR
SECS 13 | 18
24 | 19

AT COR. FD. IRON PIPE SET IN 1954,
BENT OVER (BROKEN) & BURIED IN GROUND.

FD. 24" WHITE FIR S $75\frac{1}{2}^{\circ}$ W 20 $\frac{1}{2}$ FT.

SCRIBING STILL VISIBLE IN PARTLY
COVERED SCAR.

FD. 40" DOUG. FIR N $60\frac{1}{2}^{\circ}$ W 46 $\frac{3}{4}$ FT.

GOOD BARK SCRIBING VISIBLE "T 23 S
R 5 W S 13 BT" - METAL DISC MKD. "R E
2741" NAILED TO TREE.

NO TRACE OF OTHER B.T.'S FD.

AT COR. SET IRON PIPE WITH BRASS
CAP MKD. "COUNTY SURVEYOR'S OFFICE

1963 T 23 S R 4 W - R 5 W $\frac{S 13}{S 24} | \frac{S 18}{S 19}$ "

BLAZE & SCRIBE 2 NEW TREES:

33" DOUG. FIR S $7\frac{1}{2}^{\circ}$ E 199 $\frac{3}{4}$ FT.

MKD. "T 23 S R 4 W S 19 CS BT"

22" INCENSE CEDAR N 61° E 223 $\frac{1}{4}$ FT.

MKD. "T 23 S R 4 W S 18 CS BT"

COR. IS IN FENCE COR. - FENCES
NORTH, SOUTH & WEST.

APR. 25, 1963

M.S.

M.S.

Milo C. Jeffrey

Renewal #23, T23-4W

+ * #12 T23-5W

C.S. File No.

53/9¹²

Section 13 Twp 23 S Rge 5 W

Date: 4/22/63

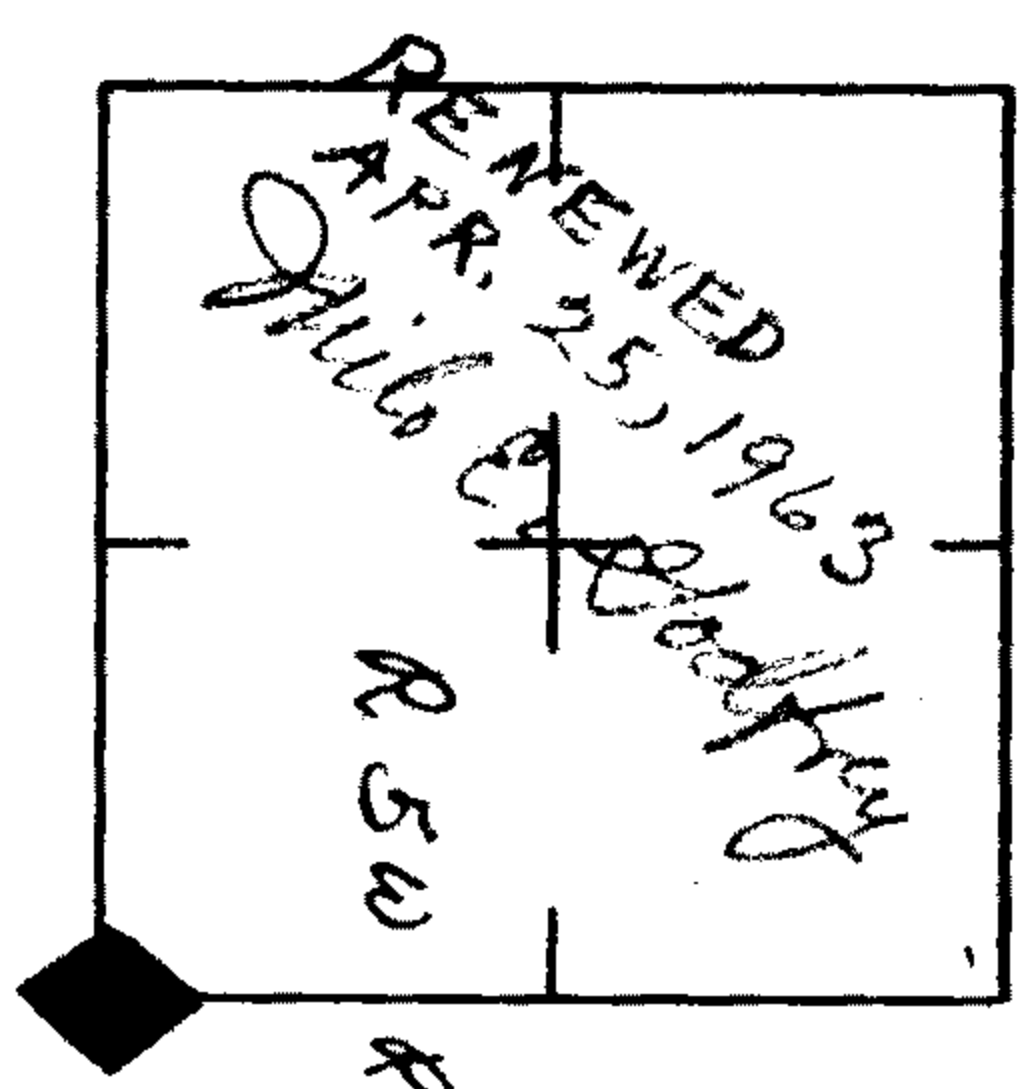

How was corner identified? 4x4 scribed (down)

wooden stake by fence corner

Condition of corner: Good

Best route to reach corner: Inter stake #5 post

Rice Hill then road thru sec. 14, 23, 24 on N56S and that goes up Rice Hill.

Other Remarks:

Quadrant	NE	NW	SE	SW
Species & Size		36" D Fir		24" W. Fir
Dist. & Bearing		N 60 W, 35' approx.		S 60 W, 15' approx.
Condition of Scribe		Bark scribe OK		OK
Condition of Scribe		Resurvey probably		Resurvey probably
Age		OK		OK
Tags, Marks, etc.				

John St. Rice
Signed