

LANE COUNTY RESTORED CORNER

Index 2594

Corner South one quarter Corner of Section 18

Twp. 20 S R. 5 West

From original G. L. O. field notes, dated _____

EVIDENCE FOUND: _____, 19____

Corner _____

Witness _____

Marks _____

From reestablishment field notes, dated 1934 C.S.

EVIDENCE FOUND: April 16, 1959

Corner _____

24" Fir, South 62° East, 14 links

36" Fir - Scribing visible

Witness 12" Maple, North 4° East, 56 links

16" Maple - Scribing visible.

Marks _____

RETRACEMENT NOTES:

Set ½" Galvanized Iron Pipe - Plates and "W" Nails

36" Fir, South 66° East, 20.6 feet C.S.B.T.

18" Fir, North 3° East, 35.4 feet

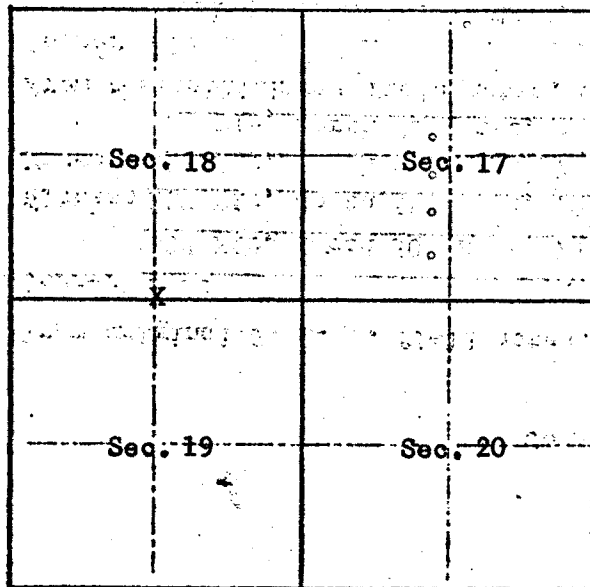

Glen McChesney

Signature.

5/28/59

Date

Land Agent

Title

CS 53/1-89