

LANE COUNTY RESTORED CORNER

Index 2662

Corner West one-quarter corner Section 24

Twp. 22 S R. 4 WEST

From original G. L. O. field notes, dated 1884

EVIDENCE FOUND: February 14, 19 61

Corner Post

Gone

Witness 40" Fir South 27° East 48 links

42" Fir stump

Marks 50" Fir North 25° West 6 links

50" Fir bark scribed

From reestablishment field notes, dated 1952 T& Hayden

EVIDENCE FOUND: February 14, 19 61

Corner Made mound of stone

Found

Witness _____

Marks _____

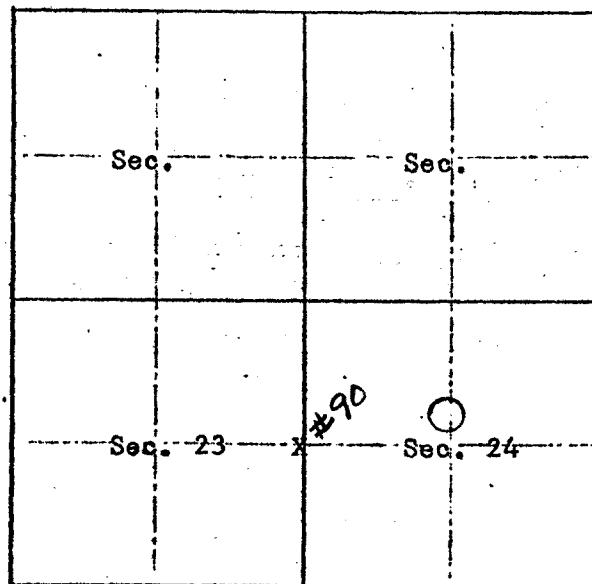

RETRACEMENT NOTES: Yew stake in mound of stone.

Plates, "W" nails 20° Declination

42" Fir stump South 28° East 31.1 feet Orig. B.T.

50" Fir North 52° West 4.1 feet Orig. B.T.

Glen McChesney

Signature

4/18/61

Date

Land Agent

Title

CS 53/1-58