

LANE COUNTY RESTORED CORNER

Index 2528

Corner Center one-quarter corner Section 24

Twp. 22 S R. 4 WEST

From original G. L. O. field notes, dated _____

EVIDENCE FOUND: _____, 19____

Corner _____

Witness _____

Marks _____

From reestablishment field notes, dated 1952

EVIDENCE FOUND: July 13, 1960

Corner Set 5/8" Iron Rod

Found _____

24" Fir South 83° West 49.7 feet

18" Fir scribed "BT"

Witness 6" Fir North 22° East 41.2 feet

10" Fir face not opened

Marks _____

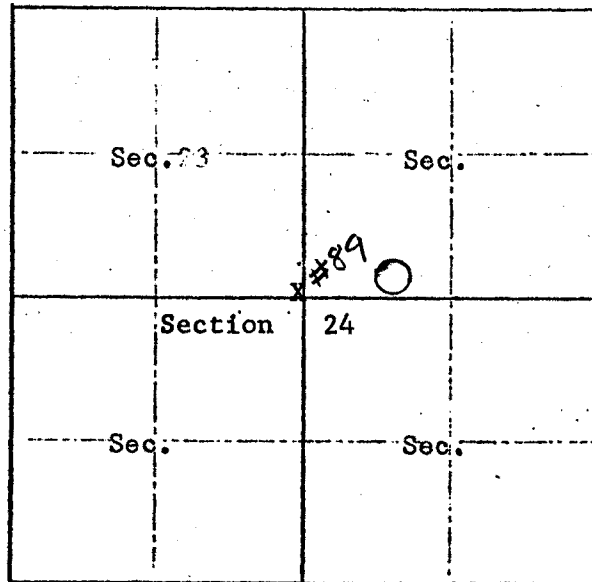

RETRACEMENT NOTES: Plates & "W" nails 21° Declination

10" Fir North 27° East 41.0 feet

18" Fir South 83° West 49.7 feet

Glen McChesney

Signature

August 5, 1960

Date

Land Agent

Title

CS 53/1-56