

LANE COUNTY RESTORED CORNER

Index 2386

Corner East quarter corner Section 36

Twp. 22 S R. 4 W

From original G. L. O. field notes, dated 1851

EVIDENCE FOUND: April 20, 1960

Corner Post

Gone

2 1/4" Fir South 73° West 3 1/4 links

Rotted remains of Fir stump. Axe marks

Witness _____

Marks 8" Maple North 76° East 27 links

GONE

From reestablishment field notes, dated _____

EVIDENCE FOUND: _____, 19 _____

Corner _____

Witness _____

Marks _____

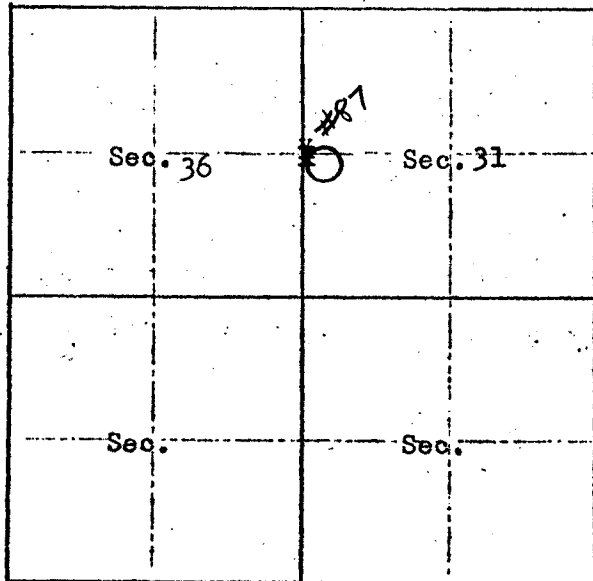

RETRACEMENT NOTES: Found 3/4" Iron Rod
Plates, "W" nails 20° Declination

4 1/2" Fir North 39° East 39.6 feet

4" Hemlock South 79° West 23.0 feet

GLEN MCCHESENEY

MEYER & REGISER, T.H. CO.

Signature

May 27, 1960

Land Agent

Date

Title

CS 53/1-53