

LANE COUNTY RESTORED CORNER

Index 2019

Corner Northeast Corner Section 28

Twp. 23 S R. 3 W

From original G. L. O. field notes, dated 1882

EVIDENCE FOUND: 3/26/, 19 59

Corner Post

Gone

7" hem S40°E 12 lks

Gone

Witness 8" hem N65°E 7 lks

Gone

Marks 7" hem S45°W 12 lks

Gone

6" hem N45°W 8 lks

Gone

From reestablishment field notes, dated Gardner 1954

EVIDENCE FOUND: 3/26, 19 59

Corner 20" hem N85°W 28.9'

24" hem scribed S21 BT

20" hem S78°E 18.2'

19" hem scribed S27 BT

Witness 18" hem N85°E 16.2'

20" hem scribed S27 BT

Marks 60" cedar S65°W 12.0'

68" cedar scribed S28. BT

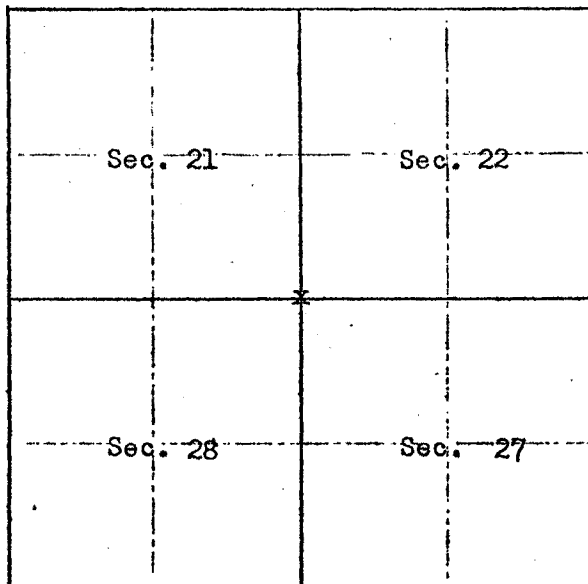

RETRACEMENT NOTES: Set 1/2"x30" GIP beside the cedar post

Referenced: Decl. 20°

28" hem N48°W 70.2'

68" cedar S62°W 12.3'

30" fir S6°E 30.0'

38" hem N7°E 74.3'

M. D. Hale

Signature

7/13/59

Date

Surveyor, WTCO.

Title

CS53/1-24