

4-398a.  
Tp. 21. S Range 5 W W. 1. Mer.  
Feb. 1969 Land Dist.

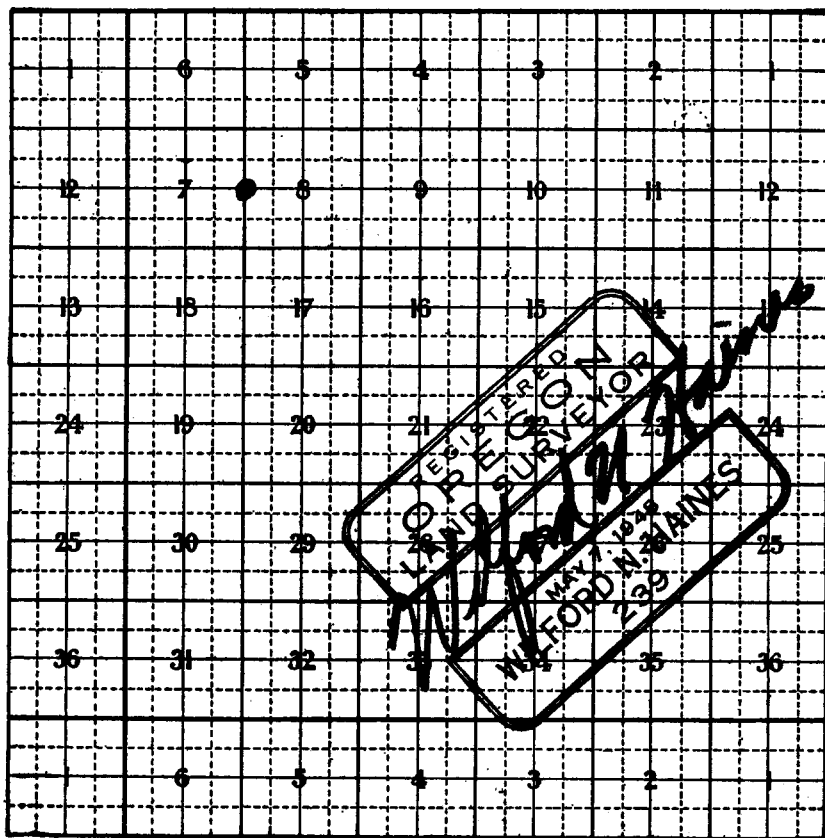

At  $\frac{1}{4}$  Cor.  $S \frac{7}{8}$  (Fd. T. 11-01) T21S R5W  
All B.Ts. have been knocked down  
And burned Fd. also N. 17° W. 29.7 ft.  
Scribed New trees  
26" fir N 01° W 146.0 ft.  
16" fir N 19° E 185.8 ft.

F.B. H-3

C.S. File No. 51/234-4