

WATT'S ACRES

LOT 3

LOT 2
522'

LOT 1
475'

20 FT. ROADWAY

879.2'

810.5'

N88°-57'E

68.7'

928.3'

BERT W. HARRISON

5.15 Ac.

HARLEY WIDNER

5.15 Ac.

953.8'

S87°-57'W

928.3'

3/4" Pipe

NOTE :- 1/4" Pipes set at all circled corners.

PARCEL SOUTH OF WATT'S ACRES DOUGLAS COUNTY - ORE.

SURVEYED BY

JAMES R. DAUGHERTY

CIVIL-SANITARY ENGINEER

WINSTON - ORE.

MAR. 3, 1961.

SCALE 1" = 100'

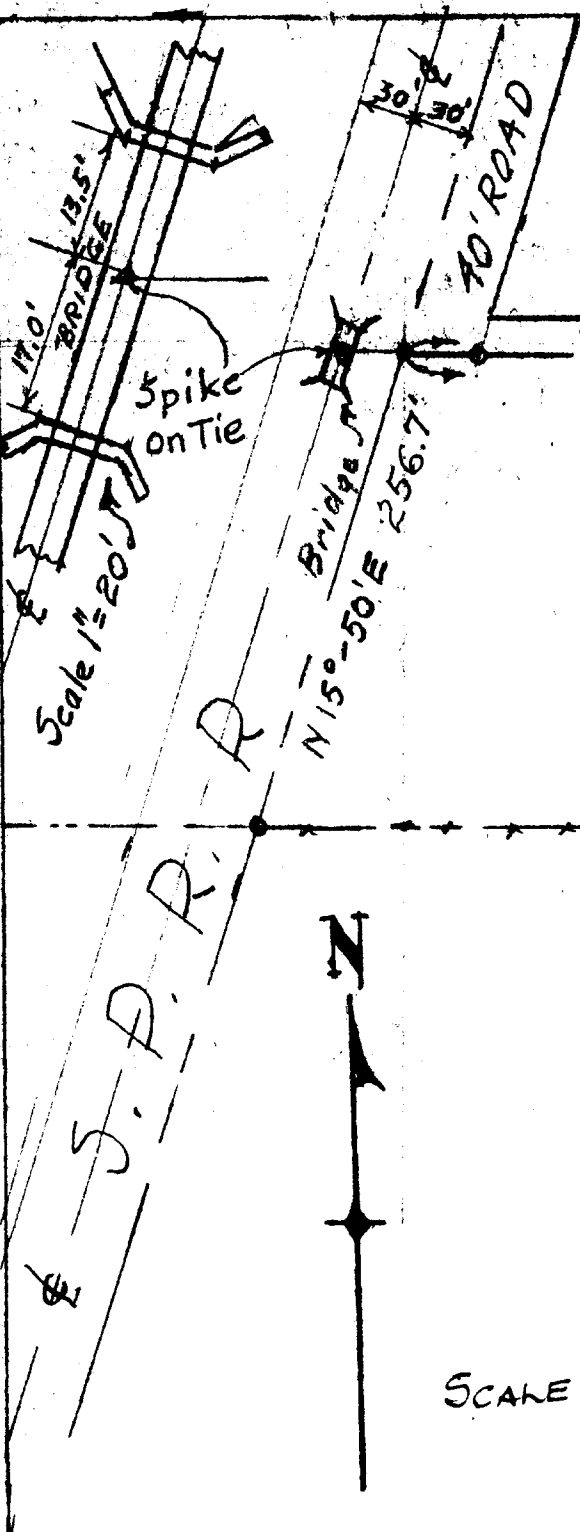
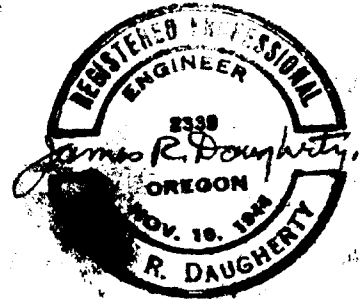

SOUTH 244'

SOUTH 240'

1348' W
D.L.C. No. 43