

COUNTY SURVEYOR'S FILE DATA
DO NOT REMOVE FROM OFFICE

PREPARED FOR

FILED
RECEIVED

JAN 5 1950

COUNTY SURVEYOR
DOUGLAS COUNTY, ORE.

T. J. FISHER

BY JOHN H. MARKHAM, JR. SCALE 1" = 50' MARCH 1950

Riddle, Ore

o Denotes 1" x 30' Iron pipes

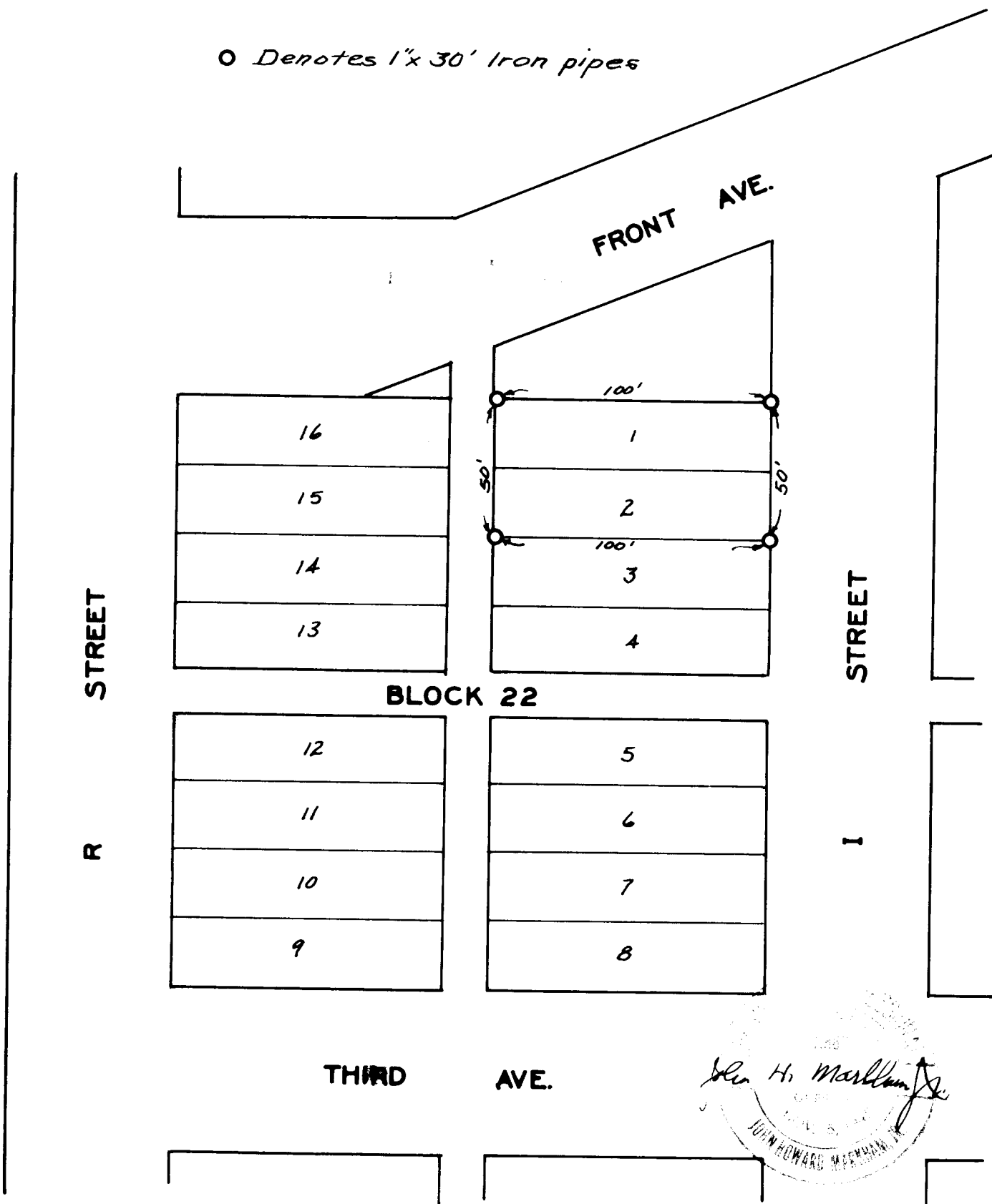

T. 30-6

SE NE Sec. 23

P

C. S. File No. 51/177-3