

Weyerhaeuser Company

Section 34 Township 22 S Range 4 W

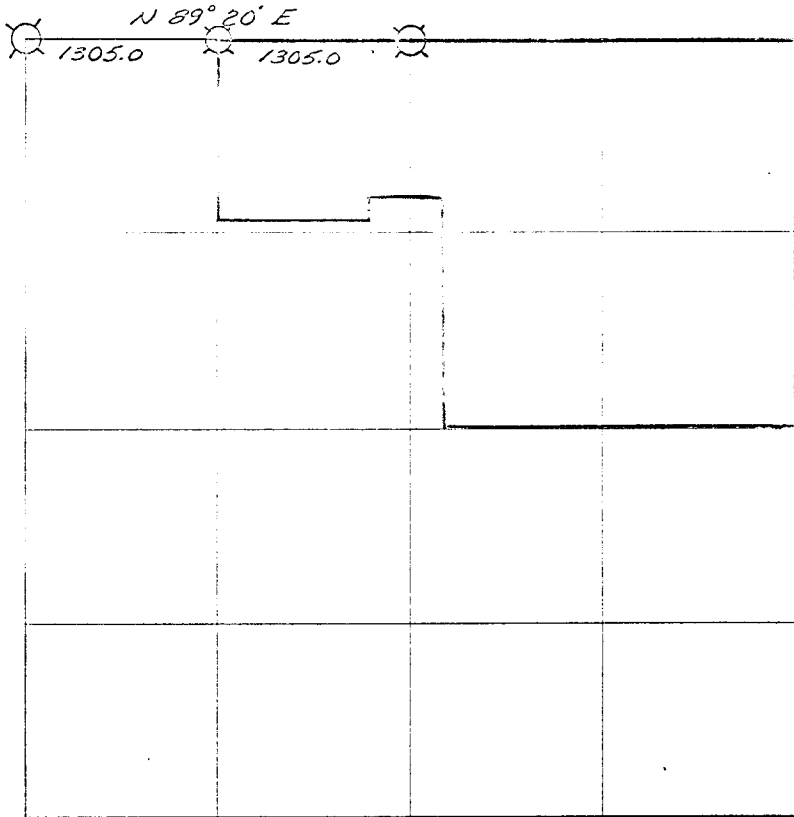

—//—//— Line marked by notch cut in blaze

○ Known corner

⊗ Referenced corner

Transit and abney slope chain survey. Bearing based on 20° declination.

This survey was made for Weyerhaeuser Company by H. R. Jones Engineering Company, Oregon Licensed Engineer, Reg. No. 2461.

Dates of survey June 1963 Date filed for record & where July 1964

Distribution Douglas County Surveyor's Office

W.Co.-Spfld-Survey File  
" " " -Land Dept. File

✓ Douglas County Surveyor  
BLM - Roseburg

Reported June 29 19 64

By Robert Barta

28/27  
33/34

Corner common to Sections 27, 28, 33 and 34-22S-4W

GLO Survey Record 1856

Post			Gone
6" W. Oak	S 02° W	717 lks	No evidence found (area is an old landing)
36" W. Oak	S 69° E	278 lks	Fd 40" tree fallen and rotted. Fd good negative of legible scribing.
24" Blk Oak	N 09° E	274 lks	Fd stump hole
18" Blk Oak	N 19° W	400 lks	Fd 30" uprooted oak, face burned out.

County Survey Record 1963

Brass Cap			Found O. K.
58" D. Fir	N 10° E	175.4'	O. K.
24" Blk Oak	S 49° E	121.2'	O. K.
26" W. Oak	S 16° W	39.9'	O. K.
33" W. Oak	N 13½° W	127.5'	O. K.

Referenced by William L. Wilt (Plates and "W" nails only)  
Declination 20°

54" D. Fir	N 9° E	172.6'	
24" Blk Oak	S 55° E	119.1'	
24" Blk Oak	S 14½° W	39.2'	
33" W. Oak	N 13° W	124.9'	

27  
34  
#96

¼ corner common to Sections 27 and 34-22S-4W

GLO Survey Record 1855

Post			Gone
18" Fir	S 57° E	13 lks	Not found
12" Fir	N 37° W	41 lks	Bark scribed, also face chopped and scribing visible behind burl. ✓

Referenced by Glen McChesney (Plates and "W" nails only)  
Declination 20°

52" Fir	N 66° E	21.2'	O. K.
16" Fir	N 37° W	27.2'	O. K.

W 1/16

Corner common to Sections 27 and 34-22S-4W = Point "B"

Set 1" aluminum pipe for corner by single proportionate method.

Referenced by William L. Wilt (Plates and "W" nails only)  
Declination 20°

14" Fir	S 25° W	13.0'	✓
18" Fir	N 65° W	18.3'	

WEYERHAEUSER COMPANY CORNER REFERENCE METHOD

A "W" nail driven thru the hole in a brass disc, into a notch cut low on a tree, stamped with the Oregon registered land surveyor or professional engineer registration number. An embossed aluminum plate nailed head high on same tree with 8d aluminum nails, with distance and bearing from the "W" nail to the corner stamped on it.

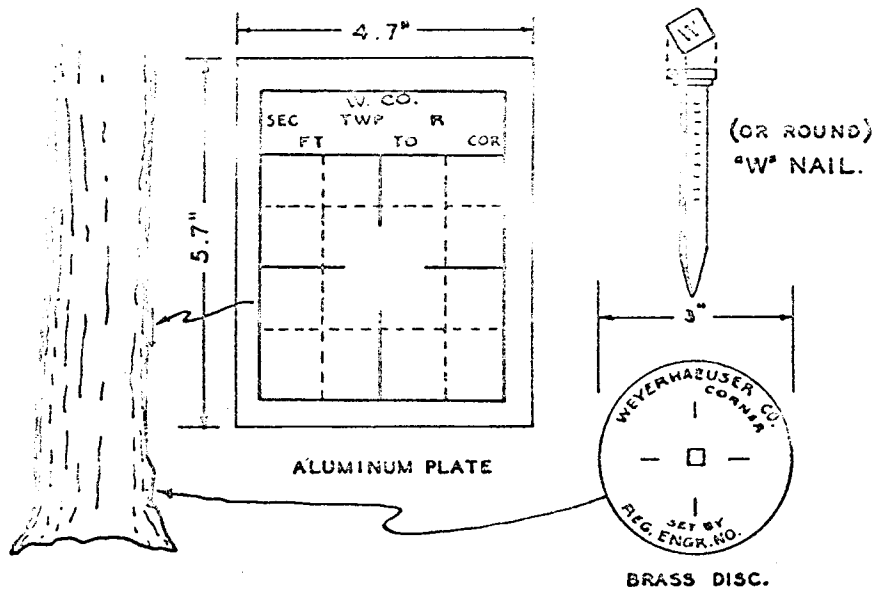

53/1