

Weyerhaeuser Company

Section 17 Township 22 S Range 4 W

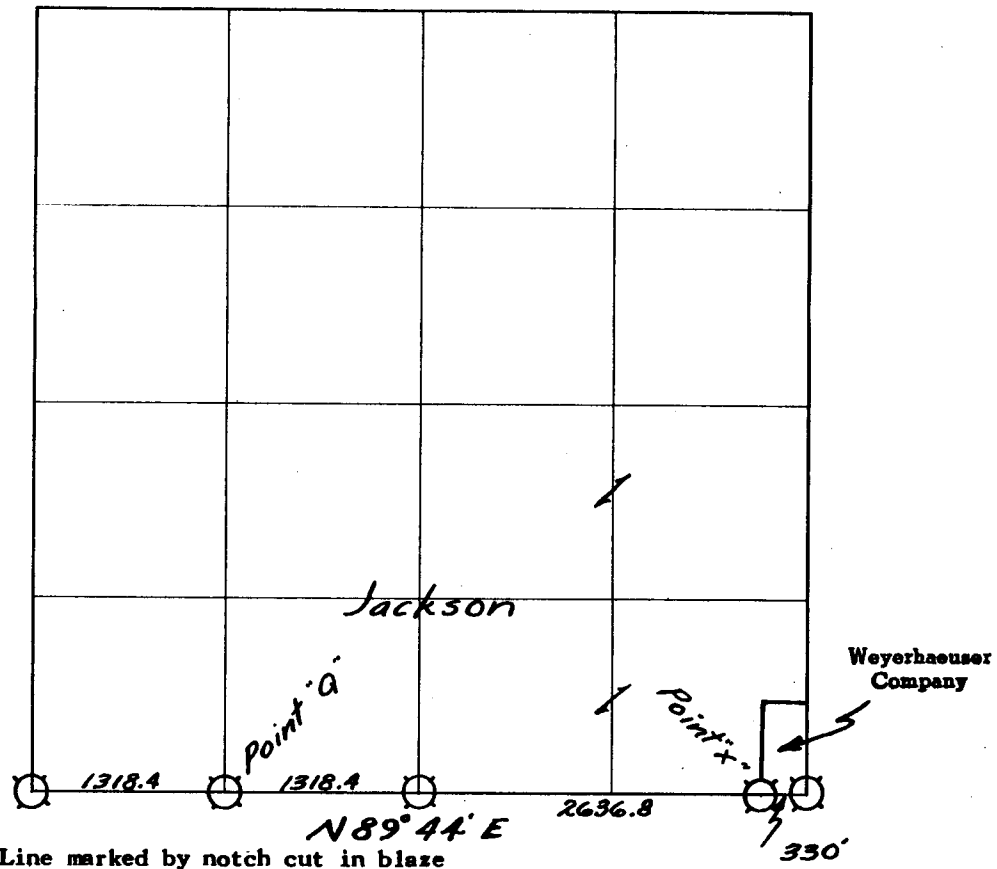

— // — // — Line marked by notch cut in blaze

- Known corner
- ⊠ Referenced corner

Transit & abney slope chain survey Bearings based on assumed 20° declination

This survey was made for Weyerhaeuser Company by William L. Wilt, under the supervision of Lester E. Calder, Oregon Licensed Engineer, Reg. No. 2149

Helpers: Glen McChesney

Walter Cowan

Harley Case

Warren Dixon

Dates of survey 7/61 & 5/62 Date filed for record & where August, 1962

Distribution Douglas County Surveyor's Office

Tacoma Land Records
 Springfield Survey File
 Springfield Land Dept. File
 John Jackson-Rt. 1, Box 211
 Yoncalla, Ore.

Reported June 26 19 62

By William L. Wilt

17|16
20|21

Corner common to Sections 16, 17, 20 and 21-22S-4W

GLO Survey Record 1856

Post				Gone
18" Fir	N 37° E	106 lks		No trace
20" Fir	S 62° E	36 lks		Found rotted stump only
30" Fir	S 60° W	84 lks		54" Fir stump
60" Fir	N 4½° W	145 lks		Rotten windfall, no scribing found

County Survey Record 1928

Set 4" x 6" x 42" scribed cedar post				Post in place; scribing visible and "T" iron stake
8" Fir	N 61½° E	41 lks		20" Fir, healed faces
30" Fir	S 71½° E	11 lks		36" Fir, scribing visible
60" Fir	S 58½° W	84 lks		54" Fir stump
36" Fir	N 29° W	300 lks		42" Snag; bark scribing plainly visible

Referenced by William L. Wilt (Plates and "W" nails only)
Declination 20°

20" Fir	N 60° E	27.4'	
36" Fir	S 85° E	6.8'	
14" Fir	S 21° W	29.2'	
14" Fir	N 62° W	54.8'	

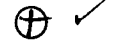

18|17
19|20

Corner common to Sections 17, 18, 19 and 20-22S-4W

GLO Survey Record 1856

Post				Gone
6" W. Oak	N 10° E	48 lks		No trace; land cleared
60" W. Oak	S 45° E	122 lks		50" stump; bottom of upper face shows in stump cut; cut below scribing
18" W. Oak	S 75° W	149 lks		No trace; land cleared
20" W. Oak	N 63° W	74 lks		Found remains oak stump only

County Survey Record 1928

Set 1" x 6' G.I. pipe 5½' in ground				Found 3/4" iron rod; extends 6" above ground
12" Fir	N 87½° E	47 lks		22" stump; lower healed scar visible
60" W. Oak	S 45° E	122 lks		50" stump
14" B. Oak	S 63½° W	29 lks		26" B. Oak; healed scars visible
30" W. Oak	N 68° W	74 lks		Remains of old stump

Referenced by William L. Wilt (Plates and "W" nails only)
Declination 20°

10" W. Oak	N 85° E	50.2'	
12" W. Oak	S 63° E	20.1'	
26" B. Oak	S 64° W	14.9'	
36" Fir stp.	N 31° W	19.0'	



W 1/16

Corner common to Sections 17 and 20-22S-4W = Point "Q"

Set 1" aluminum pipe for corner by single proportionate method.

Referenced by William L. Wilt (Weyerhaeuser Method with disc #2149)
Declination 20°

6" Fir	S 50° E	17.2'	
34" Fir stp	N 79½° W	22.1'	0

17
20

¼ Corner common to Sections 17 and 20-22S-4W

GLO Survey Record 1856

Post			Gone
20" Fir	S 24° E	15 lks	No trace
24" Fir	N 20° W	65 lks	No trace

Set 1" aluminum pipe for corner by single proportionate method.

Referenced by William L. Wilt (Weyerhaeuser Method with disc #2149)
Declination 20°

6" Fir	S 51° E	15.6'
6" Fir	S 67° W	36.1'

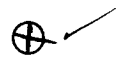

Pt. X

Point which is S 89° 44' W 330.0 feet from the SE corner of Section 17-22S-4W

Set 1" aluminum pipe for corner

Referenced by William L. Wilt (Weyerhaeuser Method with disc #2149)
Declination 20°

22" Fir	S 39° E	34.3'
18" Fir	S 02½° W	47.8'

WEYERHAEUSER TIMBER COMPANY CORNER REFERENCE METHOD

A "W" nail driven thru the hole in a brass disc, into a notch cut low on a tree, stamped with the Oregon registered land surveyor or professional engineer registration number. An embossed aluminum plate nailed head high on same tree with 8d aluminum nails, with distance and bearing from the "W" nail to the corner stamped on it.

