

Weyerhaeuser Company

Section 17 Township 24 S Range 3 W

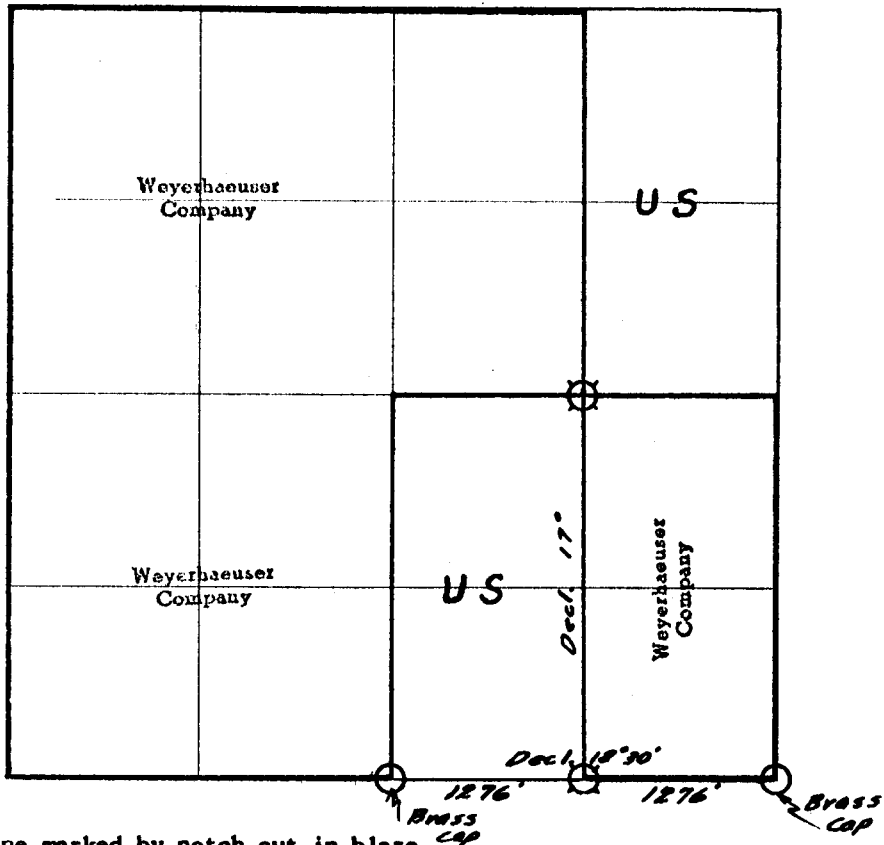

— # — # — Line marked by notch cut in blaze

- Known corner
- ◻ Referred corner

Staff compass and abney slope chain survey.

This survey was made for Weyerhaeuser Company by Marion D. Hale,
Licensed Oregon Land Surveyor, Registration No. 243.

Helper: W. Cowan

Marion D. Hale
 OREGON LAND SURVEYOR

Dates of survey July 1961 Date filed for record & where November 1961

Distribution Douglas County Surveyor's Office

W.Co.-Tacoma-Land Records
 " -Spfld.-Survey File
 " " -Land Dept.
 BLM-Roseburg
 ✓ County Surveyor-Roseburg

Reported August 4 1961
 By Marion D. Hale

$\frac{17}{20} \mid \frac{16}{21}$

Corner common to Sections 16, 17, 20 & 21-24S-3W

GLO Resurvey Record - 1950

Brass Cap	Found
8" R.Cedar N18°45'E	99 lks.
12" Fir S20°15'E	139 lks.
12" Fir S 74° W	179 lks.
7" Fir N43°15'W	113 lks.

$\frac{17}{20}$

1/4 Corner common to Sections 17 & 20-24S-3W

GLO Resurvey Record - 1950

Brass Cap	Found
44" Fir N 84° E	100 lks.
6" Madrona S78°45'W	78 lks.

E 1/16

Corner on South line Section 17-24S-3W

Yew post 3" x 3" x 48" for corner by the single proportionate method.

Referenced by Marion Hale
Declination 20°

22" Yew	N 45° E	3.2'
20" W.Fir	S 2½° W	55.8'

WEYERHAEUSER TIMBER COMPANY CORNER REFERENCE METHOD

A "W" nail driven thru the hole in a brass disc, into a notch cut low on a tree, stamped with the Oregon registered land surveyor or professional engineer registration number. An embossed aluminum plate nailed head high on same tree with 8d aluminum nails, with distance and bearing from the "W" nail to the corner stamped on it.

