

8 1/4
12

305

Rge 7

W

Date: APR 19, 1963

Section

Twp

How was corner identified? We can't find any

visible scribe - but these trees match good for bearing & distance

Condition of corner: Bob Beckler accepted it as a 1/4 cor in 1954 Johnson Lbr. Co. used it for cutting in Sec 13 Roseburg Lbr. Co. " " " " Sec 12

Best route to reach corner: Via DOE Cr. Mainline X Yellow Tag on Stump then West up fire trail.

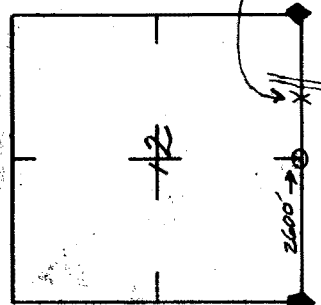

Quadrant	NE	SE	SW
Species & Size	50" FIR		48" PINE STUMP
Dist. & Bearing	N 60° E 71 lks		570' W 38 lks.
Condition of Scribe	FOUND NONE		ROUND NONE
Original or Resurvey	ORIGINAL		original
Appearance of B.C.	Down		STUMP
Tags, Marks, etc.		Yellow Tag	X XXX K ABRAK

Other Remarks:

These trees match good for bearing & distance and has been used as the original cor

Signed

Bob Hammon