

1/4 536/53

T265 R7W R8W

April 1, 1963
SNOWING

at the 1/4 COR of Sec. 31, T265R7W &

Sec. 36 T265 R8W Fd. a 32" Douglas Fir

SNAG showing good scar and overgrowth where it had previously been opened. Hathorne

in 1855 called for a 10" Hemlock. We Chopped

Fir open and fd good scribe and Reverse

scribe of partial "1/4" at about the point

this tree would have been 10", 2/90 a

Ring count showed it to be 95 to 105

years, an accurate count impossible.

This Fir B.T. Faces the proper Direction,

as called for in original field notes, also

fd 1/2" Aluminum pipe at corner Pt. Set

along side a 1" Iron pipe & Brass cap MKd.

"COUNTY SURVEYORS OFFICE 1963

T265 R7W R8W 1/4 536 531" 2N MKd

2 New B.T., 2

26" D FIR N32°E. 32 1/2 ft.

Mkd "1/4 531 CS BT"

No other trees available.

April 1, 1963

M.G.

V.T.

M.S.

Mrs. C. Coffey

+ * ✓

C.S. No 48/129-12

Section 31 Twp 26 S Rge 7 W Date: 3/12/63

How was corner identified? head pipe 3/4"

Condition of corner: OK

Best route to reach corner: Callahan road towards Baughman L.O.

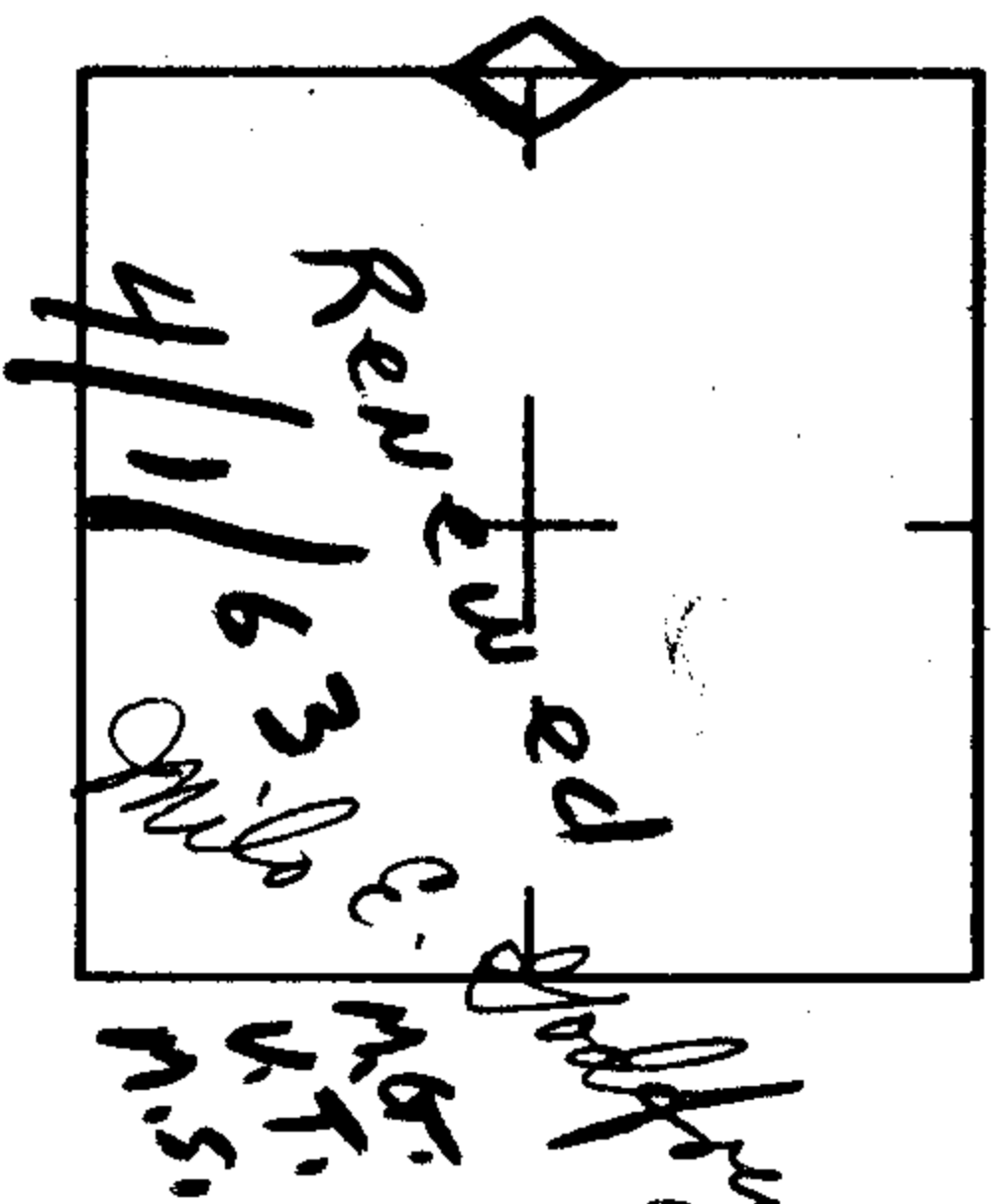

Quadrant	NE	NW	SE	SW
Species & Size	32" D fir snag			
Dist. & Bearing	N 28° E, 19.2'			
Condition of Scribe	?			
Original or Resurvey	Orig?			
Appearance of B.T.	Poor		C.S. E.M. No.	42/123
Tags, Marks, etc.	Aluminum tag			

Other Remarks:
 There is a face on the BT but is badly rotted out. Didn't see any scribe, but didn't chop into tree.
 John G. [Signature]
 Signed

