

RENEW $\frac{1}{4}$ COR. $\frac{10}{15}$ T245 R5W

FOUND - BOTH BTS. AS RECORDED BY
B.B.I. 1938 EXCEPT I FIND

BEARINGS TO BE THUS 8" NOW 12"

W. OAK N48 $\frac{1}{2}$ ' W (B.B.I. N51' W)

16" NOW 20" W. OAK S45' W (B.B.I. S43' W)

USED DISTANCES TO FIX POSITION OF
COR. I ALSO FIND IRON BOLT SET BY
B.B.I. AT COR.

SET BRASS CAP AT CORNER MKD.

COUNTY SURVEYORS OFFICE 1960

$\frac{1}{4}$ $\frac{S10}{S15}$ T245 R5W

NO NEW BTS. SCRIBED

NOTE - FENCE COR. THUS

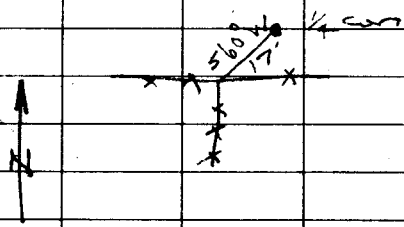

*

CS 39/124 - 20