

STATE OF OREGON
OFFICE OF STATE FORESTER
SALEM

ADDRESS REPLY TO
"STATE FORESTER"

Refer to:

April 9, 1964

629-F-1C1

Thomas A. Tillman
Chief, Branch of Cadastral Engineers
U. S. Department of the Interior
Bureau of Land Management
710 N. E. Holladay
Portland 12, Oregon

Dear Mr. Tillman:

Last month we restored a township corner near the head of Windy Cr. in Douglas County involving Federal and private lands as well as State Forests land. The corner is common to Township 31 and 32 South, Range 5 and 6 West, W.M., and is described in the attached corner report to the County Surveyor, and shown on the area sketch.

As indicated in the report there is a discrepancy in the junction of the range lines from North and South of the corner. At first glance it may seem that the corner should be at the end of the range line from the north, since the record (Lake & Hyde) called for it to be set at the end of that mile; and, actually it may legally belong there even now, although no bearing trees or remains are in evidence. When the range line was run from the south it supposedly tied into the existing corner which would make the first Lake & Hyde corner common to all four townships. Possibly they intended the 50' fir to witness a closing township corner, although the scribbling on it is complete and it does not include a CC. Since the half mile to the east is about 300 feet long, Lake and Hyde may have intended the BT at the closing point to witness a common township corner in an effort to offset some of the overage.

We restored the corner as set by the County as common to all four townships. This in affect would eliminate part of the blazed line north and south, and make the Sugar Pine line trees angle points.

If your office disagrees with what I have done and another solution would be preferred I would appreciate hearing from you.

Thomas A. Tillman
April 9, 1964
Page 2

. A timber sale for this summer is to be let in the northwest part of Section 6, and another in a year or so is to be let in the southwest part of Section 31, so it is important that we get these lines in the right place.

Very truly yours,

D. L. PHIPPS, State Forester

By *Arnold G. Gibson*
Arnold G. Gibson
Area Engineer

AG:br
Enclosure

RESTORED CORNER FOR STATE OF OREGON--DEPARTMENT OF FORESTRY

Township corner common to Sections 31, 36, 1 and 6,
T31 and 32S, R5 and 6W, W.M., Douglas County, Oregon.

*COPY
not for filing
all*

ORIGINAL

No evidence of original record corner post or bearing trees found. County Survey No. 49/92 by Dep. County Surveyor George J. Wenderoth, April 11, 1959 states that a 52" Fir with scribes on North face was found, near which the Township corner was then set (3/4" iron pipe with 3 BTs - see below). The survey does not state what influence this tree had in reestablishing the corner.

Based on the scribes being very old, in the bark, and the style of handwriting being similar to other Lake & Hyde work in this township, I conclude that this tree is an original and that the record notes are in error.

Original line blazes were found on line east of the county corner. About 10 feet east, and south to the first ridge top numerous original blazes were found. Also approximately 60 ft. west, and north across an east and west creek to the top of the main ridge numerous original blazes were found, including some on a 60" Sugar Pine (Orig. 48" at 68.20 ch.) with 119 years of overgrowth. The creek flowing east at 2.00 chains north is in place.

The corner as set by the county seems as well correlated as practicable with the evidence close at hand; therefore we restored it as shown below.

RESTORED

*★ SEE
C.S. 55/6*

Set 1 1/2" x 36" galvanized iron pipe with 3" bronze cap marked "OREGON STATE BOARD OF FORESTRY T31S R6W S31 S36 S1 S6 R5W T32S 1964 RS359", 30 inches in ground, over top of 3/4" iron pipe, and from which a:

52" Fir bears S37E 13.6 ft.; found scribed S6 CS BT (also original scribes T32 R5W S6 BT on N. face).

10" Hem. bears S45 1/2 W 31.7 ft.; found scribed S1 CS BT.

14" Yew bears N79 1/2 W 97.6 ft.; found scribed S36 CS BT.

Set 4x4x72" white painted Cedar post 1.5 ft. SE of corner pipe. Oregon State Forestry Department metal location poster on 52" Fir BT. Also 2 BLM posters on same BT. Also BLM poster on 36" Fir on north side creek 150.0 feet north.

Dated April 6, 1964

Restored by

Present and witnessed by Darryl Ray
Richard Olson

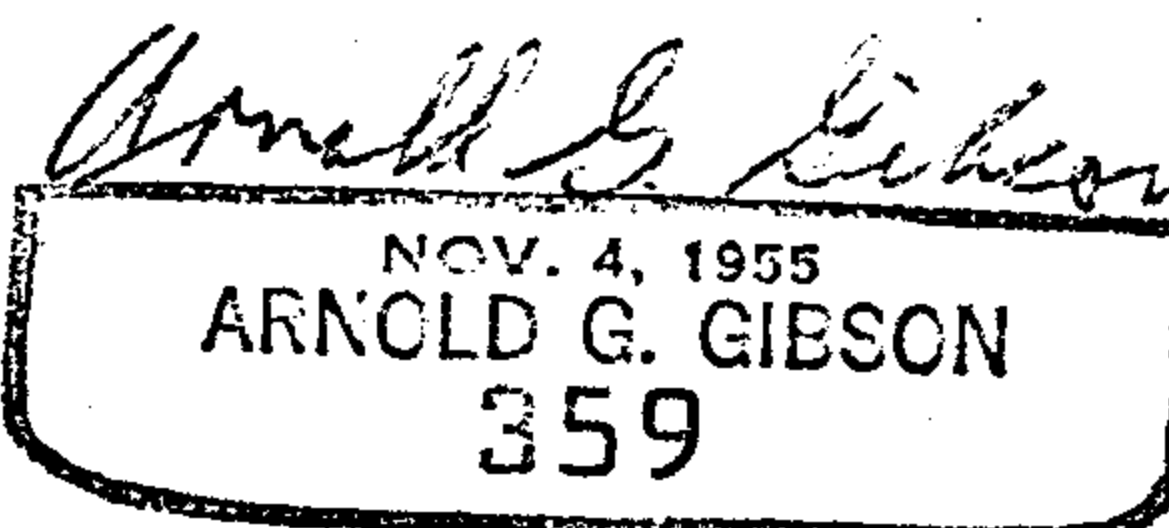

*C.S. File No. 49/92-7
3/11*

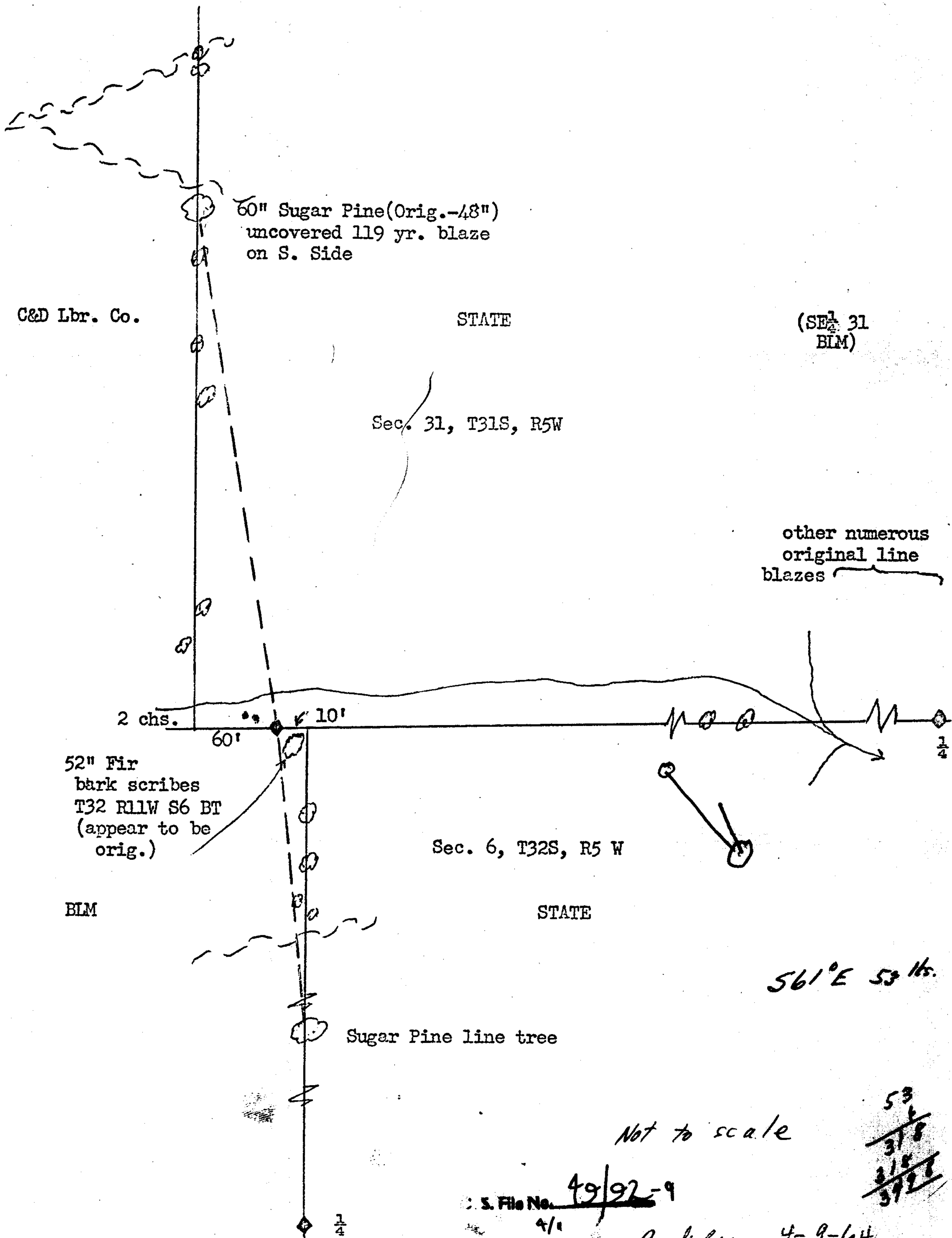

C&D Lbr. Co.

STATE

(SE $\frac{1}{4}$ 31
BLM)

Sec. 31, T31S, R5W

other numerous
original line
blazes

2 chs. 60' 10'

52" Fir
bark scribes
T32 R11W S6 BT
(appear to be
orig.)

Sec. 6, T32S, R5 W

BLM

STATE

561° E 53 lbs.

Sugar Pine line tree

Not to scale

S. File No. 49/92-9

53
318
318
3928

A. Seaman 4-9-64



UNITED STATES
DEPARTMENT OF THE INTERIOR

BUREAU OF LAND MANAGEMENT
State Office
710 N. E. Holladay
Portland, Oregon 97232

IN REPLY REFER TO:

100.4b
9180

April 14, 1964

Oregon State Forester
Attn: Mr. Arnold Gibson
Office of State Forester
Salem, Oregon 97310

Your reference:
629-F-1C1

Dear Sir:

The corner of Tps. 31 and 32 S., Rs. 5 and 6 W., as set by Lake and Hyde, in 1855, is a common corner as stated in your letter of April 9, 1964.

Your suggested treatment of making recovered line trees angle points is the procedure this office would follow.

copy

However, the location of the corner point from the alleged original bearing tree would require further investigation. At present the corner point is not at record bearing and distance from this remaining tree and there does not appear to be any justification, from the information submitted, for placing the corner at any position other than at record bearing and distance from this tree. It is noted that this tree does not match the record for size, nor is the scribing facing in the proper direction. This is not uncommon and the scribing indicates that it is the SE. tree. If Wenderoth did not have any additional evidence of the other bearing trees and just placed his corner near this tree, accepting it as an original, then it is possible that we would make further field investigation. Your sketch failed to indicate the correlation of this corner, in bearings and distances, to found corners N., S., and E. This correlation would lend weight and should be considered in the acceptance of this remaining tree as the original.

If the field investigation along with the correlation to found corners and topo, indicates that this is the original tree, then it is possible that we would remonument the corner at record bearing and distance from this tree rather than at the position indicated by Wenderoth.

5/11

C. S. File No. 49/92-9

The above should not be construed as instructions to you, but would be the method we would approach this problem.

Sincerely yours,

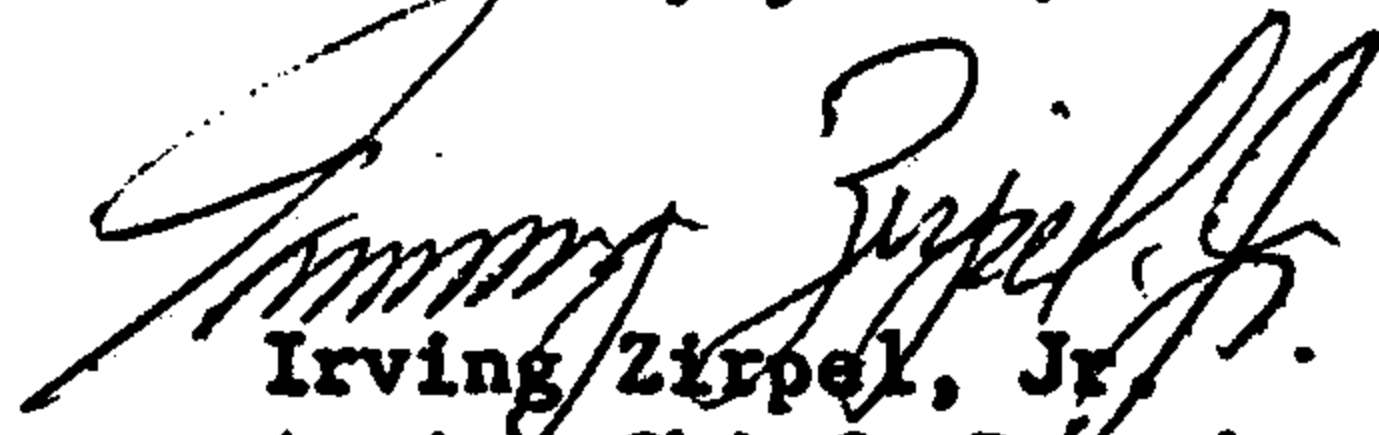

Irving Zirpel, Jr.
Acting Chief, Branch of Cadastral
Engineers

copy

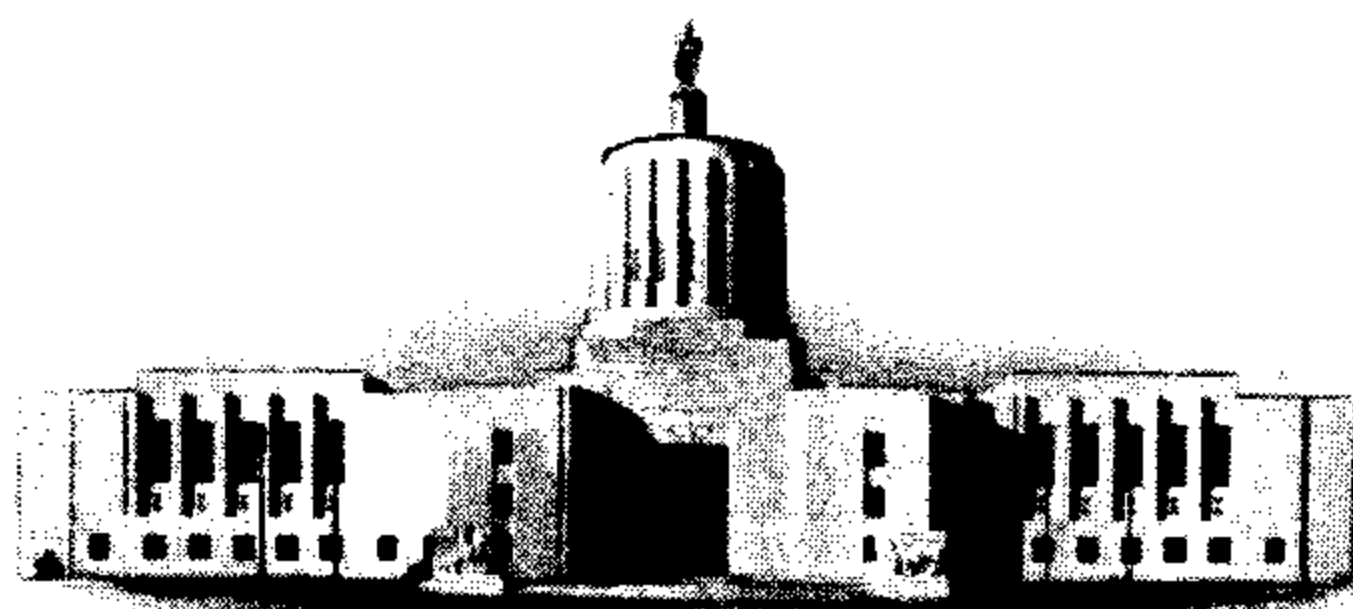

STATE OF OREGON
OFFICE OF STATE FORESTER
SALEM

Refer to:

June 15, 1964

629-F-1C1

ADDRESS REPLY TO
"STATE FORESTER"

Fred M. Darby
County Surveyor
Roseburg, Oregon

Dear Mr. Darby:

I am enclosing a copy of a restored corner report (Town Cor., T31-32S, R5-6W, W.M.), and copies of correspondence with the Cadastral Engineers regarding it.

Since B.L.M. land is affected by this corner, their Cadastral Engineers might become interested in this corner for subdivision of their own. The course of action I believe they would follow is the one offered by Mr. Zirpel in his letter to us. In which case the County corner would be useless.

In our copy of Mr. Wenderoths survey (C&D Lbr. Co.-CS file 49/92) he does not indicate his reasons for setting the corner where it is. It is not set on a proportional basis and it does not match the original bearing and distance for the southeast bearing tree.

A double proportion on this corner would put it about 75 feet East and about 100 feet South of the County corner. Then the topography would not match, and the line blazes and line trees would have no correlation whatsoever.

Perhaps Mr. Wenderoth intended the existing 52" BT to match the bearing and distance for the 18" Fir S61E 53 links, but had erroneous notes to begin with.

Referring to Mr. Wenderoths notes for the south side of Section 36, he mentions a "corner tree" for the one quarter, whereas my copy states a "post". The X which he marks 90 feet south is the one on a Cedar in my restoration for the one quarter. It is also about 70 feet west of his 2640 point.

To avoid having two corners here sometime in the future, would you consider getting the Cadastral Engineers out to look at this corner; and if so, would you use your influence of your office to get them out? I would appreciate hearing from you on this matter.

Fred M. Darby
June 15, 1964
Page 2

Possibly B.L.M would not consider having anything done here by their engineers; as moving the corner westerly to make the existing 52" tree match the original notes would be to their disadvantage.

On my next trip down I would like to witness the two Sugar pine line trees, as they definitely indicate line.

Very truly yours,

D. L. PHIPPS, State Forester

Arnold G. Gibson
By Arnold G. Gibson
Area Engineer

AGG:br
Enclosure

C. S. File No. 49/92-9
8/11

June 16, 1964

State of Oregon
Office of State Forester
Arnold G. Gibson
Area Engineer
Salem, Oregon 97310

Dear Mr. Gibson:

In answer to your letter of June 15, 1964, 629-FOICI, we would like a copy of the letter from Mr. Zirpel. We would like to study Mr. Zirpel's letter before making a decision on where the corner should probably be placed.

Yours truly,

Fred M. Darby
County Surveyor

FMD:ll

S. File No. 49/92-9
7/11

June 19, 1964

Office of State Forester
Arnold G. Gibson
Area Engineer
Salem, Oregon 97310

Re: letter
629-F-1C1

Dear Mr. Gibson:

After studying all the material with reference to the Town Corner in question, I have come to the conclusion that the corner as set by Wenderoth is out of position, as it would seem that he ignored the line trees and set the corner by intersection rather than by double proportion. However, I do not believe that proportioning the corner in is the answer, as it would apparently make all the other evidence useless, completely destroying any possibility of validity of the 52" Fir.

I believe that I would make the same decision as Mr. Zirpel, and put the corner in, using the 52" Fir as control, regardless of the position of the scribing, as we have found many cases where this condition exists. This would move the corner approximately 25 feet west and 6 feet north of Wenderoth's corner, and I would connect the lines to the Sugar Pine Line trees and the recoverable corners to the east and west. This will not materially effect the topography, nor would it disclose any serious trespass, in my mind.

Since you mention your wish to witness the Sugar Pine trees on your next trip down, I would appreciate having you set the Town Corner as outlined and tie in Wenderoth's corner, leaving it in position. It is the policy of this office to leave all corners as set on private surveys where we differ with their position. Mr. Wenderoth is a deputy true, but this corner was set in the course of a private survey and was not as a result of an official department survey.

I will notify the B. L. M. Area Engineer of the desire to have them set this corner, but do not have much hopes of getting them down here, as they are quite busy in other areas of the county. Also, I do not believe they would consider the slight moving in position to be critical or serious enough to make an issue over.

Hope this will answer your question. Would appreciate hearing from you as to your final decision.

Yours truly,

Fred M. Darby
County Surveyor

FMD:ll

File No. 49/92-9
10/11

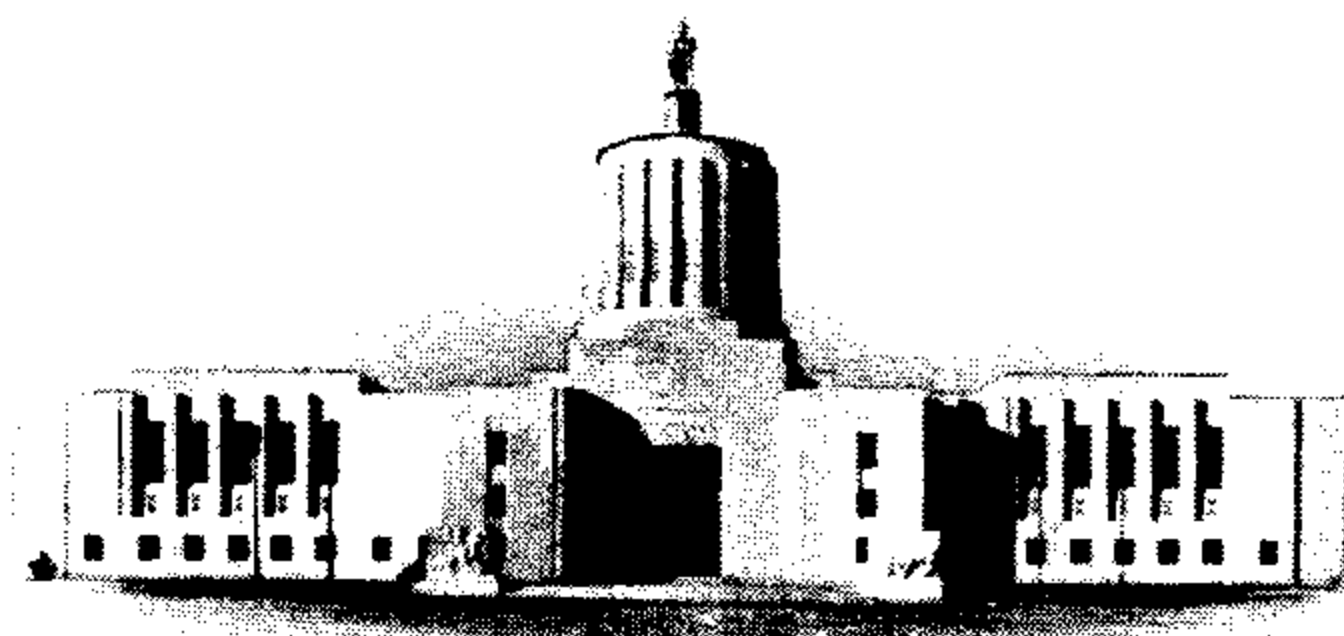

STATE OF OREGON
OFFICE OF STATE FORESTER
SALEM

ADDRESS REPLY TO
"STATE FORESTER"

Refer to:

June 25, 1964

629-F-1C1

Fred M. Darby
County Surveyor
Roseburg, Oregon

Dear Mr. Darby:

In order to get the boundaries fixed and corners in order for a State Forestry timber sale in Section 6, Township 32 South, Range 5 West, I am planning a trip to Grants Pass during the first half of July.

During this time I will witness the two Sugar Pine line trees and set a $1\frac{1}{2}$ " x 36" galvanized iron pipe and bronze cap for the township corner as you and Mr. Zirpel recommend. I am in accord with using the 52" Fir as the southeast BT, unless we find additional evidence.

Thank you for your time and advice in this matter.

Very truly yours,

D. L. PHIPPS, State Forester

By *Arnold G. Gibson*
Arnold G. Gibson
Area Engineer

AGG:br

FILED
RECEIVED

JUN 26 1964

COUNTY SURVEYOR
DOUGLAS COUNTY, ORE.

11/11 C. S. File No. 49/92-9