

Renewed $\frac{615}{718}$ T325 R6W

Found:

orig 36" Fir N40W 50" N85E 19E
Back scribe visible

orig 36" Fir N40W 50" S70W 21E
Back scribe visible

Tree blown down at N12W 57' but
could not find any scribing

Revised:

Set Brass cap at cor.
M.R. County Surveyors office 1965

T325 N6W	56/55
	57/58

New Trees

50" Fir N85E 22E
Scribed T325 R6W 55 CS BT

48" Fir S70W 22E
Scribed T325 R6W 57 CS BT

48" Fir N83W 64E
Scribed T325 R6W 56 CS AT

No tree in SE Quad. clear cut.
Cabin now cutting cor. & about
300' south of old cabin

~~12~~
X 86

112

C. S. File No.

49/91

Sept 23 1965
J.C.B.

Section 6 TWP 32 Rge 6 N Date: 6/18/65

How was corner identified? 2 original B.Ts Standing

With visible Bark scribe.

Condition of corner: Poor

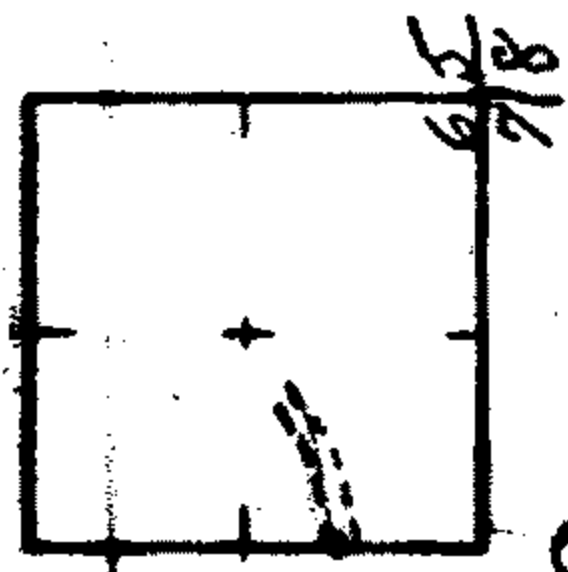

Best route to reach corner: Logging Road up Peavine Cr. or Logging Road in Section 8.

~~2/2/91 Cr. or Logging Road in Section 8.~~
 2/2/91

Other Remarks:

Quadrant	NE	NW	SE	SW
Species & Size	Fir 52"			Fir 46"
Dist. & Bearing	N 85° E. 198'			S 70° W. 201'
Condition of Scribe	Poor			Poor
Original or Resurvey	Original			Original
Appearance of B.T.	Good			Good
Tags, Marks, etc.	Yellow Tag			Yellow Tag

L. White
B. Hendriksen
B. Ford
 Signed