

RENEW SEC. COR. ^{30 29}/_{31 32} T24S R6W

FOUND - TWO BTS AS RECORDED BY GERMOND 1915, 7" R. FIR NOW 24" PARTLY ROTTED STUMP S 20° 04' E 59.4' GOOD JCR BING VISIBLE. I ALSO FIND 12" R. FIR NOW 30" PARTLY ROTTED STUMP I OPEN & FIND GOOD SCRIBING "BT". BOTH BTS CHECK BEARING & DIST

I ALSO FIND THESE ITEMS

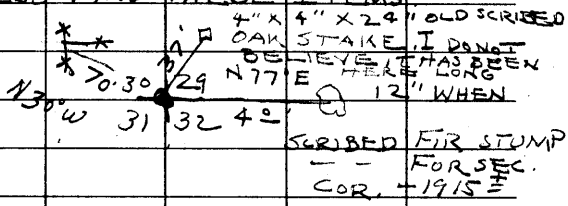

SET BRASS CAP AT COR. N. 60. COUNTY SURVEYORS OFFICE 1958

^{530 529}/_{531 532} T 24 S R 6 W

NEW BTS

24" R. FIR N 54° W 45.7'

SCRIBED S 30 T 24 S R 6 W CS BT

20" R. FIR N 15° E 62.0'

SCRIBED S 29 T 24 S R 6 W CS BT

23" R. FIR S 13° W 93.0'

SCRIBED S 31 T 24 S R 6 W CS BT

7" R. FIR S 64° E 32.3'

SCRIBED S 32 T 24 S R 6 W CS BT

CS 49/83 - 13