

Renewal S.W. Cor. DIC # 91

T27S R7W

Found:

Set Stone at Fence cor.

18" B. Dolt now 30" and dead

Survey Brass N 66 1/2 E 124'

Open this tree for scribe "B"

Renewed:

Set Brass cap at DIC cor.
along side Stone MN
County Surveyors Office

T27S R7W

S.W.
COR.
DIC # 91

1965

New Bearing Tree:

6" D. Fir S62E 123'

Scribed: DIC CS BT

Cor is at Fence cor such as this -



12-21-65

J. M. P.
J. C. B.
F. W. J.

DL. 12-21-65

+ X # 45

C. S. File No. 19/7892

DIETZGEN NO. 3885-6

S.W. Cor.
D.C.C. #1
#48

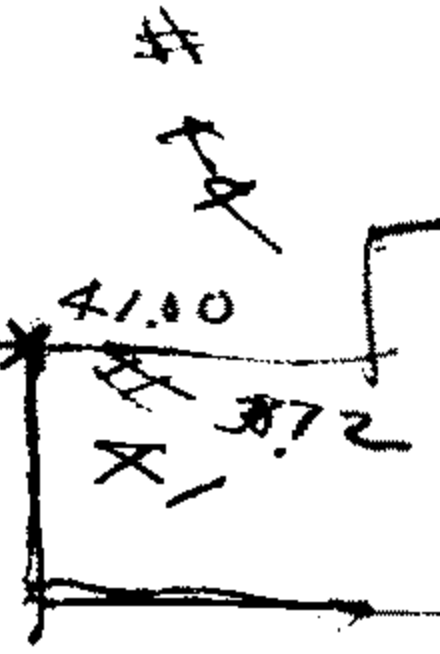

How was corner identified? _____

Condition of corner: Set Stone at Fence Cor.

Approx 150' North of S.E. Cor. D.C.C. # 44

Best route to reach corner: See Cor on S.E. Cor. D.C.C. # 44

Quadrant	NE	NW	SE	SW
Species & Size				
Dist. & Bearing				
Condition of Scribe				
Original or Resurvey				
Appearance of B.T.				
Tags, Marks, etc.				

Other Remarks:

Ann Stewart

Signed