

REN.

T 22 S R 4 W.

$\frac{1}{4}$ S $\frac{15}{34}$ $\frac{15}{35}$

FD. $1\frac{1}{2}$ " IRON PIPE 4 5" SQUARE
CEDAR STAKE (SCRIBED) AT COR.

FD. FIR STUMP (NOW 36" DIAM.)

N 66° W 217 FT. - OPENED 4 FD.
GOOD SCRIBING $\frac{1}{4}$ " - AT 4" DIAM.

FD. STUMP HOLE - REMAINS OF
OLD CEDAR LYING DOWNHILL FROM IT -

S 50° E 46 $\frac{3}{4}$ FT. - CEDAR BADLY
ROTTED 4 BURNED - NO MKS. FOUND
FD. 24" DOUG. FIR SNAG (NOT

ORIG. B.T.) N 69° E 36 $\frac{3}{4}$ FT. - SCRIBED
IN WOOD " $\frac{1}{4}$ S CS BT" - NO RECORD
OF THIS TREE.

IRON PIPE BADLY RUSTED, - ALONG-
SIDE CEDAR STAKE SET IRON PIPE
WITH BRASS CAP MKD. "COUNTY
SURVEYOR'S OFFICE 1964 T 22 S
R 4 W $\frac{1}{4}$ S $\frac{15}{34}$ $\frac{15}{35}$ "

BLAZE 4 SCRIBE NEW TREES:

32" DOUG. FIR N 42° W 14 $\frac{3}{4}$ FT.

MKD. " $\frac{1}{4}$ S 34 CS BT"

15" DOUG. FIR S 20° E 8 $\frac{1}{2}$ FT.

MKD. " $\frac{1}{4}$ S 35 CS BT"

COR. LIES ON N. SLOPE OF HILL
APPROX. 460 FT. NORTH OF RIDGE
TOP.

FEB. 26, 1964

Milo E. Godfrey

M.G.
W.S.
M.S.

+XO

C.S. File No. 49/59-43 (2)

DOUGLAS COUNTY FOREST APPRAISAL DEPARTMENT
REPORT OF SURVEY CORNERS FOUND

Twp. 22 S. Rge. A W., W.M.

Date 10/4/63

Corner Found W 1/4 COR Sec. 35

Photo Location _____

Evidence of Corner 2" iron pipe and 4" post.

Corner Location in Reference to Terrain and Cover NW slope.

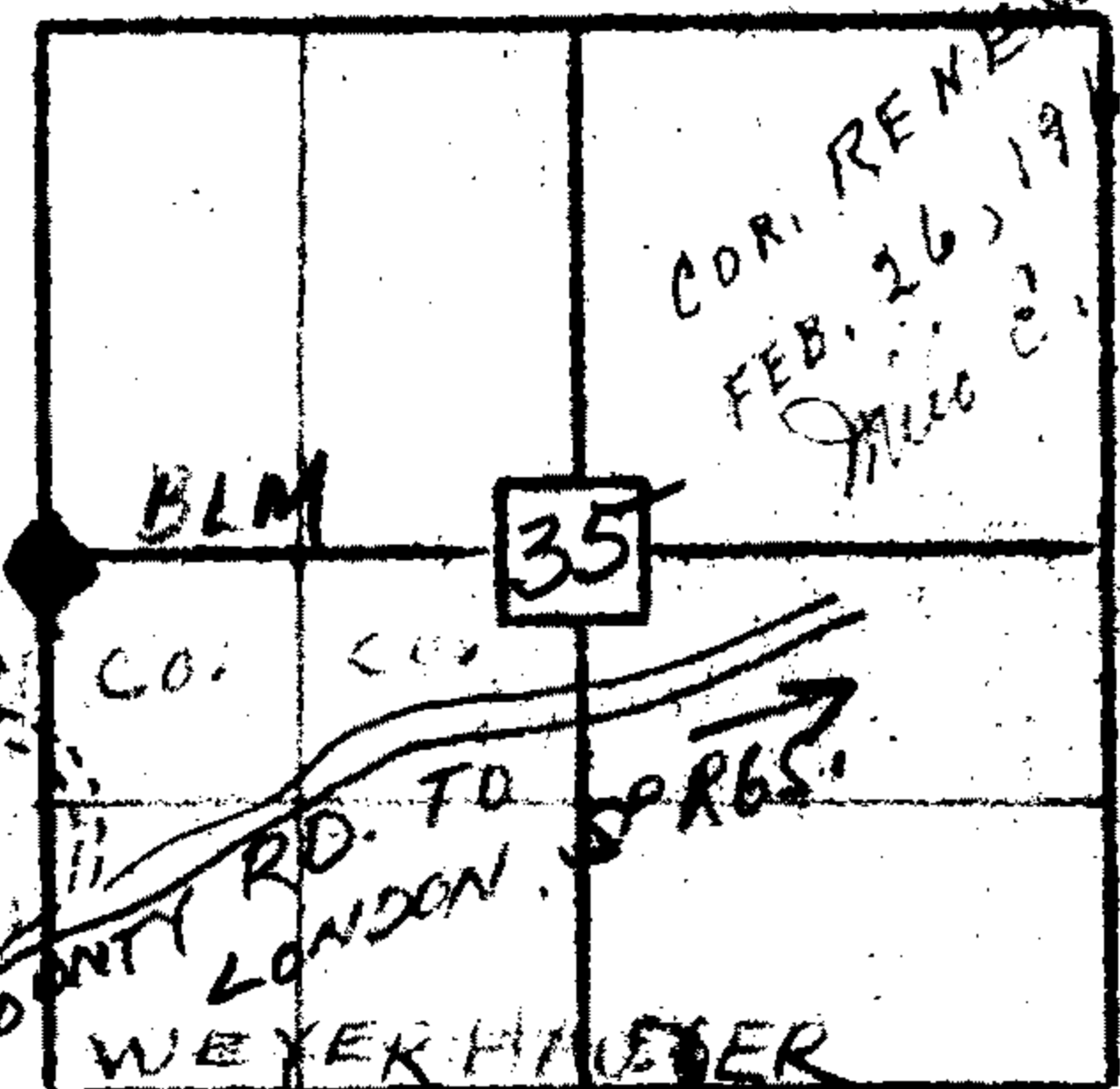

C. S. File No. 49/59-53 BEARING TREES FOUND
(27)

| QUADRANT | NE | SE | SW | NW |
|-----------------------------|---------------|----|----|----|
| Species & Size | DF Snag | | | |
| Brg. & Dist. From Corner | N 70° E 1 ch. | | | |
| Condition of Scribe or Scar | FAINT | | | |
| Original or Resurvey BT | ? | | | |
| Appearance of BT | O.K. | | | |
| Tags, Marks, Etc. on BT | Yell. tag | | | |

OTHER INFORMATION Post scribed 1/4 S

MARKS OR TAGS LEFT AT CORNER OR NEARBY 2. Weyerhaeuser tags

DESCRIPTION OF LINES LEADING TO CORNER The line leading westerly from quarter corner has been traced.

HOW CAN CORNER BE BEST REACHED Via BLM logging road described above.

REMARKS Needs new B.T. points.

NAME Bob Kischel