

RENEW $\frac{1}{4}$ COR. 29 | 28 T 22 S R 5 W

FOUND - ORIG. 16" NOW 24" W OAK
SNAG N 72° E 56.1' I OPEN UPPER
SECTION & FIND GOOD SCRIBING "D". I FIND
NO TRACE OF ORIG. N W BT I USE
ORIG. N 72° E W OAK SNAG TO RENEW
COR.

SET BRASS CAP AT CORNER, KMD
 $\frac{1}{4}$ S 29 | S 28 T 22 S R 5 W COUNTY
SURVEYORS OFFICE, 1938

NEW BTS.
6" W. O BEARS N 61° E 18.5'
SCRIBED $\frac{1}{4}$ S 28 E S BT

14" R FIR BEARS N 22° W 15.7'
SCRIBED $\frac{1}{4}$ S 29 E S BT

NOTE - THIS CORNER WAS RENEWED
BY REOPENING IN 1934. I FIND 1" I.P. AT
THIS CORNER WHICH BEARS N 20° E 20'
FROM BRASS CAP. I ALSO FIND BOTH BTS
WHICH ARE NOW STUMPS ONLY I OPEN
S 59° E 64.2' BT & FIND GOOD SCRIBING
"1/4" 5". I DO NOT OPEN S W 1/4 BT SHOWS
GOOD SCAR. THE DIFFERENT POSITIONS
FOR THE LOCATION OF THIS CORNER IS
DUE TO THE FACT THAT I NOW FIND
POSITIVE PROOF THE W. OAK SNAG IS
ONE OF THE ORIG. BTS.

U
U
N
S

20 - 58

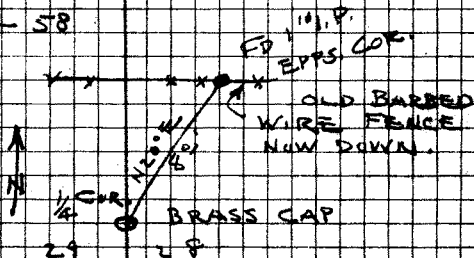

DIETZGEN NO. 385-6