

RENEW

30/29
31/32

T 285 R 6W

FOUND - ORIG 26" NOW 38"

OAK 500' W 159.7' I OPEN I

FIND GOOD SCRIBING "31" ORIG

20" NOW 40" W. OAK N 48° W 29.17'

SHOWS GOOD SCAR I DO NOT OPEN.

I DO NOT LOOK FOR ORIG. NE BT & ORIG.

SE BT GONE.

SET BRASS CAP AT CORNER MKD.

COUNTY SURVEYORS OFFICE 1158.

53dS29 T285 R6W

5311532

NOTE - COR. IN OLD RAIL FENCE

LINE THUS

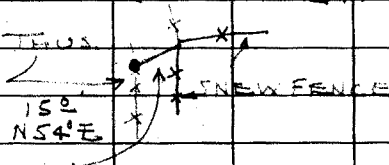

NEW B.T.S.

7" DOUBLE W. OAK BEARS S 1° W 20'

SCRIBED S 31 T 285 R 6W CS BT

9" B. OAK BEARS S 10 1/2° E 51'

SCRIBED S 32 T 285 R 6W CS BT

15" B. OAK BEARS N 86° E 156'

SCRIBED S 29 T 285 R 6W CS BT

*

11/1958

CS 49/50-25