

State of Oregon } ss
 County of Douglas }

I, J.M. Hartong, being first duly sworn, say:
 That I am a civil engineer by profession; that I have correctly surveyed and marked with proper monuments the land represented on the within plot; that I planted a proper monument, to wit, a galvanized iron pipe three feet in length and two inches in diameter at the initial point of said survey, said initial point being on the north line of Sec 25 in T. 27 S. R. 6 W. W. M. in Oregon, 288 ft east of the NW corner of said section; that I planted said pipe six inches below the surface of the ground; that the land so plotted is particularly bounded and described as follows, to-wit:
 Beginning of a point on the north line of Sec. 25, T. 27 S. R. 6 W. W. M. in Oregon, 2898 ft east of the NW corner of said section; thence west 1578.0 ft; thence north 1288.0 ft; thence west 906.0 ft; thence north 2100 ft, to the south line of the Coos Bay Road; thence westerly along said line 6275 ft; thence south 200 ft; thence east 2652 ft to the corner of Secs 22, 23, 26 and 27 in said Township and Range; thence south 7977 ft; thence east 3923.0 ft; thence north 496 ft to the west bank of the South Umpqua River; thence north along said bank of said river 10361.5 ft to point of beginning. Containing 1600 Acres more or less

J.M. Hartong
 Subscribed and sworn to before me this 6th day of Sept. 1909.
E. Henson
 Co. Clerk

Attest for and
 Sept. Term 1909.
W. H. Manscatt
 County Judge.

KNOW ALL MEN BY THESE PRESENTS, that we
 R.S. Sheridan and J.P. Sheridan, owners of the fee
 title, do hereby dedicate to the public use forever
 all streets and alleys shown on the annexed plot.
R. S. Sheridan
By E. R. Sheridan
 His attorney in fact
J. P. Sheridan
By E. R. Sheridan
 His attorney in fact

Approved Sept 5, 1909
W. E. Porter
 Co. Surveyor of Douglas Co., Or.
 Approved Sept 5, 1909
E. B. Galt
 Assessor

Filed June 18th 1909
E. Henson
 Co. Clerk

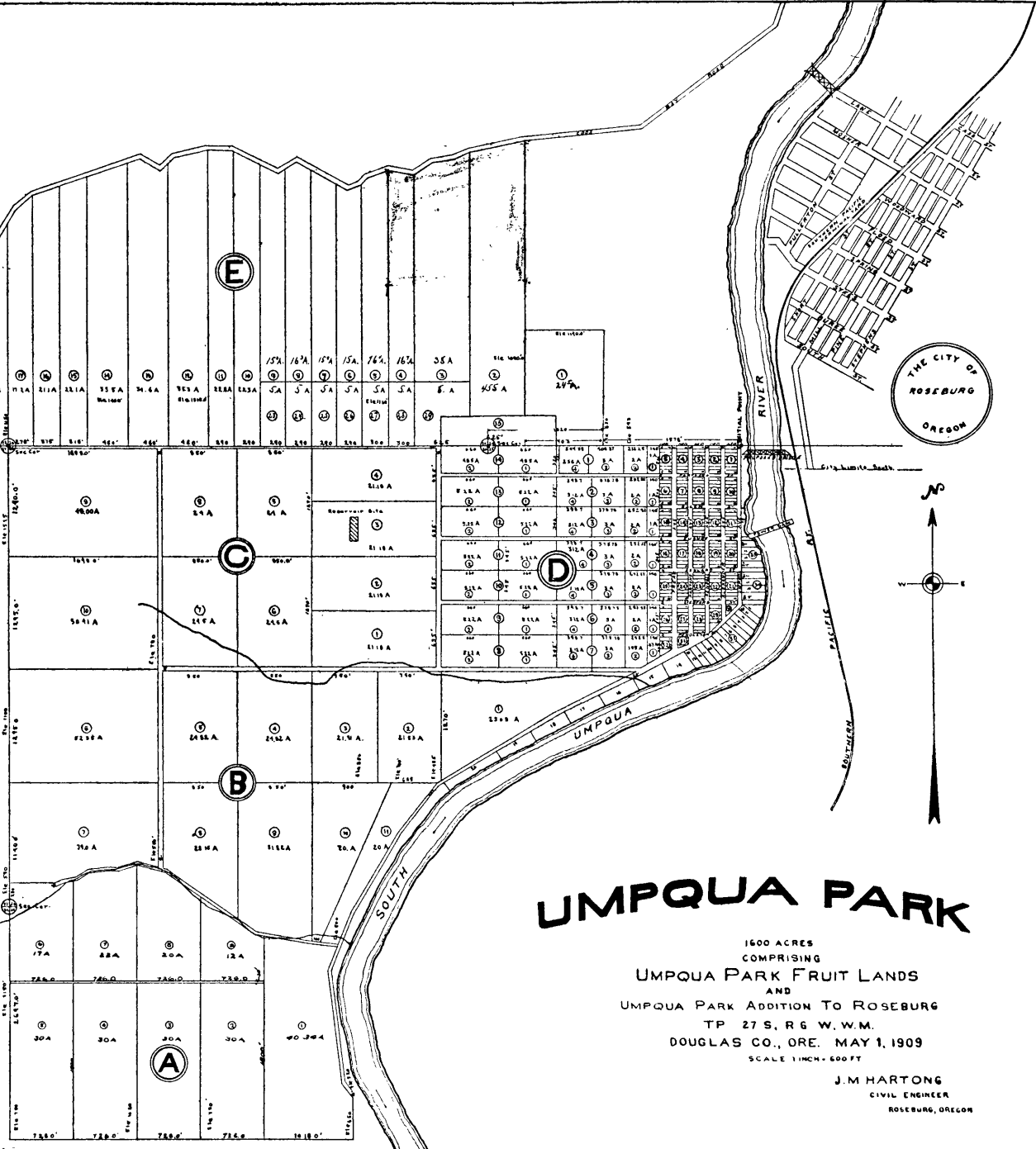

UMPQUA PARK

1600 ACRES
 COMPRISING
 UMPQUA PARK FRUIT LANDS
 AND
 UMPQUA PARK ADDITION TO ROSEBURG
 TP. 27 S. R. 6 W. W. M.
 DOUGLAS CO., ORE. MAY 1, 1909
 SCALE 1 INCH = 600 FT

J.M. HARTONG
 CIVIL ENGINEER
 ROSEBURG, OREGON

49/36

CS FILE FOLDER

CONTAINS

MORE

INFORMATION